

## PARTS LISTING

### REPLACEMENT PARTS

Replacement parts which have special safety characteristics are identified in this manual. Electrical components having such features are identified by  $\Delta$  in the Replacement Parts Listing.

The use of a substitute replacement part which does not have the same safety characteristics as the factory recommended is not permitted. Replacement parts not shown in this service manual may create shock fire, or other hazards.

### HOW TO ORDER REPLACEMENT PARTS

To have your order completed promptly and correctly please supply the following information.

1. MODEL NUMBER
2. REF. NO.
3. PART NO.
4. DESCRIPTION
5. CODE
6. QUANTITY

MARK *		SPARE PARTS	DELIVERY SECTION	
REF No.	PARTS	DESCRIPTION	*	PRICE CODE
<b>LCD PANEL</b>				
<b>NOTE : THE PARTS HERE SHOWN ARE SUPPLIED AS AN ASSEMBLY BUT NOT INDEPENDENTLY</b>				
	R1LK400D3LB43P	40" LCD MODULE LK400D3LB43	P	--
	R1LK460D3LB33P	46" LCD MODULE LK460D3LB33	P	--
<b>PRINTED WIRING BOARDS</b>				
	DUNTKF915FM02	MAIN LE730E	P	CC
$\Delta$	RDENCA440WJQZ	POWER WITH LED DRIVER 40" 46"	P	BN
	RUNTKA880WJP2	CONTROL BUTTON UNIT LE730E	P	BC
<b>DUNTKF915WE02 LE730 -MAIN Unit</b>				
<b>INTEGRATED CIRCUITS</b>				
IC 0503	VHIR24002AS-1Y	CI EPROM R1EX24002ASAS0A	P	AB
IC 0552	VHINJM4565V-1Y	IC NJM4565V-TE1	P	AC
IC 1105	VHIS172B33E-1Y	CI S-1172B33-E6T1G	P	AC
IC 1505	VHIBU16028K-1Q	CI BU16028KV	P	AH
IC 1506	VHITC7SH08U-1Y	CI TC7SH08FU(TE85L)	P	--
IC 2701	VHISTA333BW-1L	CI STA333BW13TR	P	AL
IC 2702	VHIBH3547F-1L	CI BH3547-E2	P	AC
IC 3301	RH-XD425WJZZQ	IC SUPRA HD ZR39691HGCG-X TRAY ZORAN	P	BE
IC 3501	RH-XD242WJQZQ	CI K4B2G1646C-HCH9 DDR3-2G-1333 SAMSUNG	P	BA
IC 3502	RH-XD242WJQZQ	CI K4B2G1646C-HCH9 DDR3-2G-1333 SAMSUNG	P	BA
IC 3503	RH-XD362WJZZY	IC RT9199GSP DDR3 BUS TERM.REG(RICHTK)	P	AE
IC 3601	RH-XC768WJQZQ	IC HSP55162FFR-G7C	P	AQ
IC 3701	RH-XD378WJZZQ	IC SUPRA FRC ZR39301BGCG-TRAY ZORAN	P	BB
IC 3702	RH-XD084WJZZY	IC W25X20BVSNG	P	AE
IC 4401	VHITC7SH17U-1Y	CI TC7SH17FU(TE85L,F)	P	AC
IC 4403	VHIS170B50U-1Y	CI S-1170B50UC-0UJTFG	P	AD
IC 4404	VHILCX373FK-1Y	CI TC74LCX373FK(EJK)	P	AC
IC 8401	RH-XD352WJN1Q	MICRON MT29F1G08ABADAWP-D 1Gb NAND+SOFT	P	AT
IC 9501	RH-XD309WJZZY	IC IP101A LF CI+ FAST ETHERNET TRANCEIVE	P	AF
IC 9551	RH-XD187WJZZY	CI AAT4614IGU-2-T1 ANALOGIC TECH	P	AC
IC 9552	VH12514BAEZ-1Q	IC USB2514B-AEZG	P	AM
IC 9553	VHIS170B50U-1Y	CI S-1170B50UC-0UJTFG	P	AD
IC 9601	VHIBD9329EF-1Y	CI BD9329EFJ-E2	P	AF
IC 9602	VHIMP28254+-1Y	CI MP28254EL-LF-Z	P	AF
IC 9603	VHIBD3552HF-1L	IC BD3552HFN-TR	P	AH
IC 9604	VHIS172B34E-1Y	CI S-1172B34-E6T1G	P	AC
IC 9605	VHIS135B11M-1Y	IC S-1135B11-M5T1S	P	--
IC 9606	VHIS135B12M-1Y	IC S-1135B12-M5T1S	P	--
IC 9607	VHIS135B11M-1Y	IC S-1135B11-M5T1S	P	--
IC 9608	VHIS135B33M-1Y	IC S-1135B33-M5T1S	P	--
IC 9609	VHITC7SH17U-1Y	CI TC7SH17FU(TE85L,F)	P	AC
IC 9701	VHIBD9329EF-1Y	CI BD9329EFJ-E2	P	AF
IC 9702	VHIBD3552HF-1L	IC BD3552HFN-TR	P	AH
<b>TRANSISTORS</b>				
Q 0501	VSRT1N441U-1Y	TRT RT1N441U-T111-1	P	AA
Q 0552	VSMH23T110-1Y	TRT IMH23T110	P	AC
Q 1501	VS2SC3928AR-1Y	TRT 2SC3928AR-T112-1R MITSUBISHI	P	AA

REF No.	PARTS	DESCRIPTION	*	PRICE CODE
Q 1505	VS2N7002K+-1Y	TRT 2N7002K-RTK/P	P	AA
Q 2601	VS2SC3928AR-1Y	TRT 2SC3928AR-T112-1R MITSUBISHI	P	AA
Q 2602	VS2SC3928AR-1Y	TRT 2SC3928AR-T112-1R MITSUBISHI	P	AA
Q 2604	RH-TXA064WJZZY	TRT AO3415 P-Channel Mosfet ALPHA & OMEG	P	AC
Q 2703	VSISA1530AC-1Y	DIGITAL TRANSISTOR ISA1530AC1-T112-1R	P	AA
Q 2705	VSRT1N441U-1Y	TRT RT1N441U-T111-1	P	AA
Q 2706	VSMH23T110-1Y	TRT IMH23T110	P	AC
Q 3401	VS2SC3928AR-1Y	TRT 2SC3928AR-T112-1R MITSUBISHI	P	AA
Q 3405	VS2N7002K+-1Y	TRT 2N7002K-RTK/P	P	AA
Q 4401	VSRT1N441U-1Y	TRT RT1N441U-T111-1	P	AA
Q 9501	VSRT1N441U-1Y	TRT RT1N441U-T111-1	P	AA
Q 9602	VSKN3904S/-1+	TRT KN3904S-RTK/P	P	AA
Q 9603	VS2SC3928AR-1Y	TRT 2SC3928AR-T112-1R MITSUBISHI	P	AA
Q 9604	RH-TXA064WJZZY	TRT AO3415 P-Channel Mosfet ALPHA & OMEG	P	AC
<b>DIODES</b>				
D 0501	RH-EXA741WJQZY	ZENER DIODE DZ2J056MOL	P	AC
D 0502	RH-EXA741WJQZY	ZENER DIODE DZ2J056MOL	P	AC
D 0503	RH-EXA741WJQZY	ZENER DIODE DZ2J056MOL	P	AC
D 0504	RH-EXA741WJQZY	ZENER DIODE DZ2J056MOL	P	AC
D 0505	RH-EXA741WJQZY	ZENER DIODE DZ2J056MOL	P	AC
D 0529	VHDDAN202K-1Y	DIODO DAN202KT146	P	AA
D 0536	VHPGPFMV51T-1	PHOTODIODO GP1FV51TK0F	P	AF
D 0556	RH-EXA741WJQZY	ZENER DIODE DZ2J056MOL	P	AC
D 0557	RH-EXA629WJQZY	ZENER DIODE 3.9V RKZ3,9B2KG	P	AA
D 1501	RH-EXA741WJQZY	ZENER DIODE DZ2J056MOL	P	AC
D 1502	RH-EXA741WJQZY	ZENER DIODE DZ2J056MOL	P	AC
D 1503	RH-EXA741WJQZY	ZENER DIODE DZ2J056MOL	P	AC
D 1504	RH-EXA741WJQZY	ZENER DIODE DZ2J056MOL	P	AC
D 1505	RH-EXA741WJQZY	ZENER DIODE DZ2J056MOL	P	AC
D 1506	RH-EXA741WJQZY	ZENER DIODE DZ2J056MOL	P	AC
D 1507	RH-EXA741WJQZY	ZENER DIODE DZ2J056MOL	P	AC
D 1508	RH-EXA741WJQZY	ZENER DIODE DZ2J056MOL	P	AC
D 1509	VHDRB520S30-1Y	DIODO RB520S-30	P	AA
D 2702	VHDHSU119/-1Y	DIODO HSU119TRF	P	AB
D 2703	VHDHSU119/-1Y	DIODO HSU119TRF	P	AB
D 2706	VHDHSU119/-1Y	DIODO HSU119TRF	P	AB
D 2707	VHDHSU119/-1Y	DIODO HSU119TRF	P	AB
D 3401	VHDHSU119/-1Y	DIODO HSU119TRF	P	AB
D 4401	VHDDAN202K-1Y	DIODO DAN202KT146	P	AA
D 9551	RH-DXA159WJZZY	DIODE RF201L2STE25 ROHM	P	AC
D 9601	RH-EXA741WJQZY	DIODO HSU119TRF	P	AB
<b>PACKAGED CIRCUITS</b>				
SG 0501	RH-VXA187WJQZY	VARISTOR EZAEG2A50AX	P	AD
SG 0502	RH-VXA187WJQZY	VARISTOR EZAEG2A50AX	P	AD
SG 0503	RH-VXA187WJQZY	VARISTOR EZAEG2A50AX	P	AD
SG 0551	RH-VXA187WJQZY	VARISTOR EZAEG2A50AX	P	AD
SG 0552	RH-VXA187WJQZY	VARISTOR EZAEG2A50AX	P	AD
SG 0553	RH-VXA187WJQZY	VARISTOR EZAEG2A50AX	P	AD
SG 0554	RH-VXA187WJQZY	VARISTOR EZAEG2A50AX	P	AD
SG 0555	RH-VXA187WJQZY	VARISTOR EZAEG2A50AX	P	AD
SG 0556	RH-VXA187WJQZY	VARISTOR EZAEG2A50AX	P	AD
SG 0557	RH-VXA187WJQZY	VARISTOR EZAEG2A50AX	P	AD
SG 0558	RH-VXA187WJQZY	VARISTOR EZAEG2A50AX	P	AD
SG 0559	RH-VXA187WJQZY	VARISTOR EZAEG2A50AX	P	AD
SG 0560	RH-VXA187WJQZY	VARISTOR EZAEG2A50AX	P	AD
SG 0561	RH-VXA187WJQZY	VARISTOR EZAEG2A50AX	P	AD
SG 0562	RH-VXA187WJQZY	VARISTOR EZAEG2A50AX	P	AD
SG 0563	RH-VXA187WJQZY	VARISTOR EZAEG2A50AX	P	AD
SG 0564	RH-VXA187WJQZY	VARISTOR EZAEG2A50AX	P	AD
SG 0565	RH-VXA187WJQZY	VARISTOR EZAEG2A50AX	P	AD
VA 1501	RH-VXA074WJZZY	VARISTOR AVRL101A1R1NTB	P	AD
VA 1502	RH-VXA074WJZZY	VARISTOR AVRL101A1R1NTB	P	AD
VA 1503	RH-VXA074WJZZY	VARISTOR AVRL101A1R1NTB	P	AD
VA 1504	RH-VXA074WJZZY	VARISTOR AVRL101A1R1NTB	P	AD
VA 1505	RH-VXA074WJZZY	VARISTOR AVRL101A1R1NTB	P	AD
VA 1506	RH-VXA074WJZZY	VARISTOR AVRL101A1R1NTB	P	AD
VA 1507	RH-VXA074WJZZY	VARISTOR AVRL101A1R1NTB	P	AD
VA 1508	RH-VXA074WJZZY	VARISTOR AVRL101A1R1NTB	P	AD
VA 9551	RH-VXA074WJZZY	VARISTOR AVRL101A1R1NTB	P	AD
VA 9552	RH-VXA074WJZZY	VARISTOR AVRL101A1R1NTB	P	AD
VA 9553	RH-VXA074WJZZY	VARISTOR AVRL101A1R1NTB	P	AD

REF No.	PARTS	DESCRIPTION	*	PRICE CODE
VA 9554	RH-VXA074WJZZY	VARIATOR AVRL101A1R1NTB	P	AD
VA 9555	RH-VXA074WJZZY	VARIATOR AVRL101A1R1NTB	P	AD
VA 9556	RH-VXA074WJZZY	VARIATOR AVRL101A1R1NTB	P	AD
X 3301	RCRSCA219WJQZY	CRYSTAL NX5032GA(EXS00A-CG01569)	P	AF
X 3701	RCRSCA219WJQZY	CRYSTAL NX5032GA(EXS00A-CG01569)	P	AF
X 9551	RCRSCA224WJZZY	CRYSTAL AT-41CD2-24.000MHz_20_N_NDK	P	AC
<b>COILS AND FILTERS</b>				
FB 0501	RBLN-A529WJZZY	FERRITE MI0603M121R-10	P	AE
FB 0502	RBLN-A529WJZZY	FERRITE MI0603M121R-10	P	AE
FB 0503	RBLN-A529WJZZY	FERRITE MI0603M121R-10	P	AE
FB 0504	RBLN-A529WJZZY	FERRITE MI0603M121R-10	P	AE
FB 0505	RBLN-A529WJZZY	FERRITE MI0603M121R-10	P	AE
FB 0506	RBLN-A529WJZZY	FERRITE MI0603M121R-10	P	AE
FB 0507	RBLN-A529WJZZY	FERRITE MI0603M121R-10	P	AE
FB 0508	RBLN-A529WJZZY	FERRITE MI0603M121R-10	P	AE
FB 0512	RBLN-A529WJZZY	FERRITE MI0603M121R-10	P	AE
FB 1109	RBLN-A529WJZZY	FERRITE MI0603M121R-10	P	AE
FB 1111	RBLN-A529WJZZY	FERRITE MI0603M121R-10	P	AE
FB 1112	RBLN-A529WJZZY	FERRITE MI0603M121R-10	P	AE
FB 1113	RBLN-A529WJZZY	FERRITE MI0603M121R-10	P	AE
FB 1114	RBLN-A529WJZZY	FERRITE MI0603M121R-10	P	AE
FB 1115	RBLN-A529WJZZY	FERRITE MI0603M121R-10	P	AE
FB 1501	RBLN-A529WJZZY	FERRITE MI0603M121R-10	P	AE
FB 2603	RBLN-A528WJZZY	FERRITA HI0805N600R-10	P	AA
FB 2702	RBLN-A529WJZZY	FERRITE MI0603M121R-10	P	AE
FB 2703	RBLN-A529WJZZY	FERRITE MI0603M121R-10	P	AE
FB 2704	RBLN-A529WJZZY	FERRITE MI0603M121R-10	P	AE
FB 2705	RBLN-A529WJZZY	FERRITE MI0603M121R-10	P	AE
FB 2706	RBLN-A529WJZZY	FERRITE MI0603M121R-10	P	AE
FB 2707	RBLN-A529WJZZY	FERRITE MI0603M121R-10	P	AE
FB 2708	RBLN-A529WJZZY	FERRITE MI0603M121R-10	P	AE
FB 2709	RBLN-A529WJZZY	FERRITE MI0603M121R-10	P	AE
FB 2711	RBLN-A529WJZZY	FERRITE MI0603M121R-10	P	AE
FB 2712	RBLN-A528WJZZY	FERRITA HI0805N600R-10	P	AA
FB 3401	RBLN-A529WJZZY	FERRITE MI0603M121R-10	P	AE
FB 3403	RBLN-A529WJZZY	FERRITE MI0603M121R-10	P	AE
FB 3404	RBLN-A529WJZZY	FERRITE MI0603M121R-10	P	AE
FB 3405	RBLN-A529WJZZY	FERRITE MI0603M121R-10	P	AE
FB 3406	RBLN-A529WJZZY	FERRITE MI0603M121R-10	P	AE
FB 3407	RBLN-A529WJZZY	FERRITE MI0603M121R-10	P	AE
FB 3408	RBLN-A529WJZZY	FERRITE MI0603M121R-10	P	AE
FB 3409	RBLN-A529WJZZY	FERRITE MI0603M121R-10	P	AE
FB 3410	RBLN-A529WJZZY	FERRITE MI0603M121R-10	P	AE
FB 3411	RBLN-A529WJZZY	FERRITE MI0603M121R-10	P	AE
FB 3412	RBLN-A529WJZZY	FERRITE MI0603M121R-10	P	AE
FB 3413	RBLN-A529WJZZY	FERRITE MI0603M121R-10	P	AE
FB 3414	RBLN-A529WJZZY	FERRITE MI0603M121R-10	P	AE
FB 3415	RBLN-A529WJZZY	FERRITE MI0603M121R-10	P	AE
FB 3416	RBLN-A529WJZZY	FERRITE MI0603M121R-10	P	AE
FB 3417	RBLN-A529WJZZY	FERRITE MI0603M121R-10	P	AE
FB 3418	RBLN-A529WJZZY	FERRITE MI0603M121R-10	P	AE
FB 3419	RBLN-A529WJZZY	FERRITE MI0603M121R-10	P	AE
FB 3420	RBLN-A529WJZZY	FERRITE MI0603M121R-10	P	AE
FB 3421	VRS-CY1JF000JY	RES 0603 0 OHM 5% 1/10W SMD	P	AA
FB 3422	RBLN-A529WJZZY	FERRITE MI0603M121R-10	P	AE
FB 3501	RBLN-A529WJZZY	FERRITE MI0603M121R-10	P	AE
FB 3502	VRS-CY1JF000JY	RES 0603 0 OHM 5% 1/10W SMD	P	AA
FB 3601	RBLN-A529WJZZY	FERRITE MI0603M121R-10	P	AE
FB 3701	RBLN-A529WJZZY	FERRITE MI0603M121R-10	P	AE
FB 3702	RBLN-A528WJZZY	FERRITA HI0805N600R-10	P	AA
FB 3703	RBLN-A529WJZZY	FERRITE MI0603M121R-10	P	AE
FB 4402	RBLN-A529WJZZY	FERRITE MI0603M121R-10	P	AE
FB 9501	RBLN-A529WJZZY	FERRITE MI0603M121R-10	P	AE
FB 9502	RBLN-A529WJZZY	FERRITE MI0603M121R-10	P	AE
FB 9503	RBLN-A529WJZZY	FERRITE MI0603M121R-10	P	AE
FB 9504	RBLN-A529WJZZY	FERRITE MI0603M121R-10	P	AE
FB 9552	RBLN-A528WJZZY	FERRITA HI0805N600R-10	P	AA
FB 9553	RBLN-A529WJZZY	FERRITE MI0603M121R-10	P	AE
FB 9554	RBLN-A528WJZZY	FERRITA HI0805N600R-10	P	AA
FB 9601	RBLN-A529WJZZY	FERRITE MI0603M121R-10	P	AE
FB 9602	RBLN-A529WJZZY	FERRITE MI0603M121R-10	P	AE
FB 9603	RBLN-A529WJZZY	FERRITE MI0603M121R-10	P	AE

REF No.	PARTS	DESCRIPTION	*	PRICE CODE
FB 9604	RBLN-A529WJZZY	FERRITE MI0603M121R-10	P	AE
FB 9605	RBLN-A529WJZZY	FERRITE MI0603M121R-10	P	AE
FB 9606	RBLN-A529WJZZY	FERRITE MI0603M121R-10	P	AE
FB 9607	RBLN-A529WJZZY	FERRITE MI0603M121R-10	P	AE
FB 9609	RBLN-A528WJZZY	FERRITA HI0805N600R-10	P	AA
FB 9610	VRS-CY1JF000JY	RES 0603 0 OHM 5% 1/10W SMD	P	AA
FB 9611	RBLN-A529WJZZY	FERRITE MI0603M121R-10	P	AE
FB 9612	VRS-CY1JF000JY	RES 0603 0 OHM 5% 1/10W SMD	P	AA
FB 9613	RBLN-A529WJZZY	FERRITE MI0603M121R-10	P	AE
FB 9614	RBLN-A529WJZZY	FERRITE MI0603M121R-10	P	AE
FB 9615	RBLN-A529WJZZY	FERRITE MI0603M121R-10	P	AE
FB 9616	RBLN-A529WJZZY	FERRITE MI0603M121R-10	P	AE
FB 9617	RBLN-A529WJZZY	FERRITE MI0603M121R-10	P	AE
FB 9618	RBLN-A529WJZZY	FERRITE MI0603M121R-10	P	AE
FB 9701	RBLN-A528WJZZY	FERRITA HI0805N600R-10	P	AA
FB9608	VRS-TV1JD000JY	RES 2125 0 OHM 5% 1/10W SMD	P	AA
L 1101	VPDBNR33JR45NY	BOBINA NLV25T-R33J-PF	P	AB
L 1102	VPDBNR33JR45NY	BOBINA NLV25T-R33J-PF	P	AB
L 2601	VRS-CA1JF000JY	ARRAY 2 RES 0 OHM 5% 1/16W SMD	P	AE
L 2602	VRS-CA1JF000JY	ARRAY 2 RES 0 OHM 5% 1/16W SMD	P	AE
L 2603	VRS-CA1JF000JY	ARRAY 2 RES 0 OHM 5% 1/16W SMD	P	AE
L 2604	VRS-CA1JF000JY	ARRAY 2 RES 0 OHM 5% 1/16W SMD	P	AE
L 2605	VRS-CA1JF000JY	ARRAY 2 RES 0 OHM 5% 1/16W SMD	P	AE
L 2606	VRS-CA1JF000JY	ARRAY 2 RES 0 OHM 5% 1/16W SMD	P	AE
L 2607	VRS-CA1JF000JY	ARRAY 2 RES 0 OHM 5% 1/16W SMD	P	AE
L 2608	VRS-CA1JF000JY	ARRAY 2 RES 0 OHM 5% 1/16W SMD	P	AE
L 2609	VRS-CA1JF000JY	ARRAY 2 RES 0 OHM 5% 1/16W SMD	P	AE
L 2610	VRS-CA1JF000JY	ARRAY 2 RES 0 OHM 5% 1/16W SMD	P	AE
L 2611	VRS-CA1JF000JY	ARRAY 2 RES 0 OHM 5% 1/16W SMD	P	AE
L 2612	VRS-CA1JF000JY	ARRAY 2 RES 0 OHM 5% 1/16W SMD	P	AE
L 2613	VRS-CA1JF000JY	ARRAY 2 RES 0 OHM 5% 1/16W SMD	P	AE
L 2614	VRS-CA1JF000JY	ARRAY 2 RES 0 OHM 5% 1/16W SMD	P	AE
L 2615	VRS-CA1JF000JY	ARRAY 2 RES 0 OHM 5% 1/16W SMD	P	AE
L 2616	VRS-CA1JF000JY	ARRAY 2 RES 0 OHM 5% 1/16W SMD	P	AE
L 2617	VRS-CA1JF000JY	ARRAY 2 RES 0 OHM 5% 1/16W SMD	P	AE
L 2618	VRS-CA1JF000JY	ARRAY 2 RES 0 OHM 5% 1/16W SMD	P	AE
L 2619	VRS-CA1JF000JY	ARRAY 2 RES 0 OHM 5% 1/16W SMD	P	AE
L 2620	VRS-CA1JF000JY	ARRAY 2 RES 0 OHM 5% 1/16W SMD	P	AE
L 2621	VRS-CA1JF000JY	ARRAY 2 RES 0 OHM 5% 1/16W SMD	P	AE
L 2622	VRS-CA1JF000JY	ARRAY 2 RES 0 OHM 5% 1/16W SMD	P	AE
L 2623	VRS-CA1JF000JY	ARRAY 2 RES 0 OHM 5% 1/16W SMD	P	AE
L 2624	VRS-CA1JF000JY	ARRAY 2 RES 0 OHM 5% 1/16W SMD	P	AE
L 2701	RCILPB016WJQZY	COIL SWPA6045S220	P	AD
L 2702	RCILPB016WJQZY	COIL SWPA6045S220	P	AD
L 2703	RCILPB016WJQZY	COIL SWPA6045S220	P	AD
L 2704	RCILPB016WJQZY	COIL SWPA6045S220	P	AD
L 3301	VRK-SB1FF000JY	RES 0 OHM 5% 1/32W SMD	P	AA
L 3302	VRK-SB1FF000JY	RES 0 OHM 5% 1/32W SMD	P	AA
L 3303	VRK-SB1FF000JY	RES 0 OHM 5% 1/32W SMD	P	AA
L 3304	VRK-SB1FF000JY	RES 0 OHM 5% 1/32W SMD	P	AA
L 3305	VRK-SB1FF000JY	RES 0 OHM 5% 1/32W SMD	P	AA
L 3306	VRK-SB1FF000JY	RES 0 OHM 5% 1/32W SMD	P	AA
L 3337	VPDBN1R8J1R1NY	BOBINA NLV25T-1R8J-PF	P	AB
L 3338	VPDBN1R8J1R1NY	BOBINA NLV25T-1R8J-PF	P	AB
L 9551	VRS-CA1JF000JY	ARRAY 2 RES 0 OHM 5% 1/16W SMD	P	AE
L 9552	VRS-CA1JF000JY	ARRAY 2 RES 0 OHM 5% 1/16W SMD	P	AE
L 9553	VRS-CA1JF000JY	ARRAY 2 RES 0 OHM 5% 1/16W SMD	P	AE
L 9554	VRS-CA1JF000JY	ARRAY 2 RES 0 OHM 5% 1/16W SMD	P	AE
L 9601	RCILPB014WJQZY	COIL SWPA6045S100	P	AC
L 9602	RCILPB011WJQZY	COIL SWPA6045S2R7	P	AB
L 9701	RCILPB014WJQZY	COIL SWPA6045S100	P	AC
<b>TUNER</b>				
TU 1101	RTJDA082WJQZ	TUNER FK1602 LOW IF DVB-T/T2/C NUTUNE	P	AR
<b>CAPACITORS</b>				
C 0501	RC-KZA388WJZZY	C CERAM 10uf 6.3V GRM188B30J106ME69D	P	AM
C 0502	VCCCCZ1HH331JY	CERAM C 0402 330PF 50V 5%	P	AA
C 0503	VCCCCZ1HH331JY	CERAM C 0402 330PF 50V 5%	P	AA
C 0504	VCCCCZ1HH561JY	CERAM C 0402 560PF 50V 5%	P	AA
C 0505	VCCCCZ1HH100DY	C CERAM 0402 10PF 50V 5%	P	AA
C 0506	VCCCCZ1HH561JY	CERAM C 0402 560PF 50V 5%	P	AA
C 0507	VCCCCY1HH101JY	CONDENSADOR GRM39CK 101J 50 (1608)SMD	P	AA

REF No.	PARTS	DESCRIPTION	*	PRICE CODE
C 0508	VCCCCZ1HH100DY	C CERAM 0402 10PF 50V 0.5%	P	AA
C 0510	VCCCCZ1HH100DY	C CERAM 0402 10PF 50V 0.5%	P	AA
C 0512	VCKYCZ1CB473KY	C CERAM 0402 47NF 16V 10%	P	AB
C 0513	VCKYCZ1CB473KY	C CERAM 0402 47NF 16V 10%	P	AB
C 0514	VCKYCZ1CB473KY	C CERAM 0402 47NF 16V 10%	P	AB
C 0515	VCKYCZ1HB472KY	C CERAM 0402 4.7NF 50V 10%	P	AA
C 0516	VCKYCZ1AB474KY	C CERAM 0402 470NF 10V 10%	P	AB
C 0517	VCKYCZ1AB474KY	C CERAM 0402 470NF 10V 10%	P	AB
C 0537	VCKYCZ1EF104ZY	C CERAM 0402 100NF 25V 20%	P	AD
C 0538	VCCCCZ1HH220JY	CERAM C 0402 22PF 50V 5%	P	AA
C 0539	RC-KZA388WJZZY	C CERAM 10uF 6.3V GRM188B30J106ME69D	P	AM
C 0554	RC-KZA237WJZZY	C CERAM EMK212BJ106KGFT 10UF 16V 10%	P	AD
C 0555	RC-KZA237WJZZY	C CERAM EMK212BJ106KGFT 10UF 16V 10%	P	AD
C 0557	VCCCCZ1HH331JY	CERAM C 0402 330PF 50V 5%	P	AA
C 0558	VCCCCZ1HH331JY	CERAM C 0402 330PF 50V 5%	P	AA
C 0559	VCCCCZ1HH470JY	CERAM C 0402 47PF 50V 5%	P	AA
C 0560	VCCCCZ1HH470JY	CERAM C 0402 47PF 50V 5%	P	AA
C 0561	RC-KZA237WJZZY	C CERAM EMK212BJ106KGFT 10UF 16V 10%	P	AD
C 0562	RC-KZA237WJZZY	C CERAM EMK212BJ106KGFT 10UF 16V 10%	P	AD
C 0563	RC-KZA237WJZZY	C CERAM EMK212BJ106KGFT 10UF 16V 10%	P	AD
C 0566	VCKYCZ1EF104ZY	C CERAM 0402 100NF 25V 20%	P	AD
C 0568	VCEASX1CN107MY	C ELEC 100UF 16V MVL16VC100MF80E1	P	AD
C 0572	RC-KZA237WJZZY	C CERAM EMK212BJ106KGFT 10UF 16V 10%	P	AD
C 0573	RC-KZA237WJZZY	C CERAM EMK212BJ106KGFT 10UF 16V 10%	P	AD
C 0574	VCKYCZ1CB473KY	C CERAM 0402 47NF 16V 10%	P	AB
C 0575	VCKYCZ1CB473KY	C CERAM 0402 47NF 16V 10%	P	AB
C 0576	VCKYCZ1CB473KY	C CERAM 0402 47NF 16V 10%	P	AB
C 0577	VCAAPEQJ227MY	C ELEC 220UF 20% 6.3V 6SVP100M	P	AH
C 0580	VCCCCZ1HH271JY	C CERAM 0402 270PF 50V 5%	P	AA
C 0581	VCKYCZ1HB471KY	C CERAM 0402 470PF 50V 10%	P	AA
C 0582	VCKYCZ1HB471KY	C CERAM 0402 470PF 50V 10%	P	AA
C 0585	VCCCCZ1HH100DY	C CERAM 0402 10PF 50V 0.5%	P	AA
C 0586	VCCCCZ1HH100DY	C CERAM 0402 10PF 50V 0.5%	P	AA
C 0587	VCCCCZ1HH100DY	C CERAM 0402 10PF 50V 0.5%	P	AA
C 0588	VCCCCZ1HH331JY	CERAM C 0402 330PF 50V 5%	P	AA
C 0589	VCCCCZ1HH331JY	CERAM C 0402 330PF 50V 5%	P	AA
C 0590	VCCCCZ1HH100DY	C CERAM 0402 10PF 50V 0.5%	P	AA
C 0591	VCCCCZ1HH100DY	C CERAM 0402 10PF 50V 0.5%	P	AA
C 0592	VCCCCZ1HH100DY	C CERAM 0402 10PF 50V 0.5%	P	AA
C 0593	VCCCCZ1HH331JY	CERAM C 0402 330PF 50V 5%	P	AA
C 0594	VCCCCZ1HH561JY	CERAM C 0402 560PF 50V 5%	P	AA
C 0595	VCCCCZ1HH561JY	CERAM C 0402 560PF 50V 5%	P	AA
C 0596	VCCCCZ1HH680JY	C CERAM 0402 68PF 50V 5%	P	AA
C 0597	VCCCCZ1HH561JY	CERAM C 0402 560PF 50V 5%	P	AA
C 0598	VCKYCZ1CB473KY	C CERAM 0402 47NF 16V 10%	P	AB
C 0599	VCCCCZ1HH680JY	C CERAM 0402 68PF 50V 5%	P	AA
C 0600	VCCCCZ1HH470JY	CERAM C 0402 47PF 50V 5%	P	AA
C 0601	VCKYCZ1CB473KY	C CERAM 0402 47NF 16V 10%	P	AB
C 0602	VCKYCZ1HB472KY	C CERAM 0402 4.7NF 50V 10%	P	AA
C 0603	VCKYCZ1CB473KY	C CERAM 0402 47NF 16V 10%	P	AB
C 0604	VCKYCZ1CB473KY	C CERAM 0402 47NF 16V 10%	P	AB
C 0605	VCKYCZ1AB474KY	C CERAM 0402 470NF 10V 10%	P	AB
C 0606	VCKYCZ1AB474KY	C CERAM 0402 470NF 10V 10%	P	AB
C 0607	VCCCCZ1HH331JY	CERAM C 0402 330PF 50V 5%	P	AA
C 0608	VCCCCZ1HH561JY	CERAM C 0402 560PF 50V 5%	P	AA
C 0609	VCKYCZ1AB474KY	C CERAM 0402 470NF 10V 10%	P	AB
C 0610	VCKYCZ1AB474KY	C CERAM 0402 470NF 10V 10%	P	AB
C 0611	VCKYCZ1CB473KY	C CERAM 0402 47NF 16V 10%	P	AB
C 1107	VCKYCZ1EF104ZY	C CERAM 0402 100NF 25V 20%	P	AD
C 1135	VCCCCZ1HH150JY	C CERAM 0402 15PF 50V 5%	P	AA
C 1141	VCKYCZ1EF104ZY	C CERAM 0402 100NF 25V 20%	P	AD
C 1144	VCCCCZ1HH150JY	C CERAM 0402 15PF 50V 5%	P	AA
C 1145	RC-KZA388WJZZY	C CERAM 10uF 6.3V GRM188B30J106ME69D	P	AM
C 1148	RC-KZA388WJZZY	C CERAM 10uF 6.3V GRM188B30J106ME69D	P	AM
C 1150	VCEASYQJN477MY	C ELEC 470UF 6.3V MLA6.3VC470MF80	P	AF
C 1151	VCCCCZ1HH220JY	CERAM C 0402 22PF 50V 5%	P	AA
C 1152	VCKYCZ1HB472KY	C CERAM 0402 4.7NF 50V 10%	P	AA
C 1153	VCCCCZ1HH220JY	CERAM C 0402 22PF 50V 5%	P	AA
C 1154	VCKYCZ1HB102KY	C CERAM 0402 1NF 50V 10%	P	AA
C 1160	VCKYCZ1EF104ZY	C CERAM 0402 100NF 25V 20%	P	AD
C 1161	RC-KZA237WJZZY	C CERAM EMK212BJ106KGFT 10UF 16V 10%	P	AD
C 1162	RC-KZA388WJZZY	C CERAM 10uF 6.3V GRM188B30J106ME69D	P	AM
C 1166	VCKYCZ1EF104ZY	C CERAM 0402 100NF 25V 20%	P	AD

REF No.	PARTS	DESCRIPTION	*	PRICE CODE
C 1167	VCKYCZ1EF104ZY	C CERAM 0402 100NF 25V 20%	P	AD
C 1170	VCKYCZ1HB471KY	C CERAM 0402 470PF 50V 10%	P	AA
C 1501	VCKYCZ1EF104ZY	C CERAM 0402 100NF 25V 20%	P	AD
C 1502	VCKYCZ1EF104ZY	C CERAM 0402 100NF 25V 20%	P	AD
C 1503	VCKYCZ1EF104ZY	C CERAM 0402 100NF 25V 20%	P	AD
C 1504	VCKYCZ1EF104ZY	C CERAM 0402 100NF 25V 20%	P	AD
C 1505	VCKYCZ0JF105ZY	C CERAM 0402 1uF 6.3V 20%	P	AD
C 1506	VCKYCZ1EF104ZY	C CERAM 0402 100NF 25V 20%	P	AD
C 1507	VCKYCZ1HB102KY	C CERAM 0402 1NF 50V 10%	P	AA
C 1508	VCKYCZ1EF104ZY	C CERAM 0402 100NF 25V 20%	P	AD
C 1509	VCKYCZ1HB102KY	C CERAM 0402 1NF 50V 10%	P	AA
C 1511	VCKYCZ1EF104ZY	C CERAM 0402 100NF 25V 20%	P	AD
C 1512	VCKYCZ1HB102KY	C CERAM 0402 1NF 50V 10%	P	AA
C 1513	VCKYCZ1EF104ZY	C CERAM 0402 100NF 25V 20%	P	AD
C 1514	VCKYCZ1HB102KY	C CERAM 0402 1NF 50V 10%	P	AA
C 1517	VCKYCZ1HB102KY	C CERAM 0402 1NF 50V 10%	P	AA
C 1518	VCKYCZ1EF104ZY	C CERAM 0402 100NF 25V 20%	P	AD
C 1519	VCKYCZ1EF104ZY	C CERAM 0402 100NF 25V 20%	P	AD
C 1520	VCEASKJN227MY	C ELEC 220UF 20% 6.3V MVY6.3VC220MF60	P	AC
C 1521	VCKYCZ1EF104ZY	C CERAM 0402 100NF 25V 20%	P	AD
C 2605	RC-KZA237WJZZY	C CERAM EMK212BJ106KGFT 10UF 16V 10%	P	AD
C 2606	VCKYCZ1EF104ZY	C CERAM 0402 100NF 25V 20%	P	AD
C 2607	VCKYCZ1EF104ZY	C CERAM 0402 100NF 25V 20%	P	AD
C 2608	RC-KZA237WJZZY	C CERAM EMK212BJ106KGFT 10UF 16V 10%	P	AD
C 2609	VCKYCZ1EF104ZY	C CERAM 0402 100NF 25V 20%	P	AD
C 2702	RC-KZA388WJZZY	C CERAM 10uF 6.3V GRM188B30J106ME69D	P	AM
C 2703	VCKYT1CB104KY	C CERAM 100NF 16V 2125SMD	P	AB
C 2704	RC-KZA388WJZZY	C CERAM 10uF 6.3V GRM188B30J106ME69D	P	AM
C 2705	VCKYCZ1HB102KY	C CERAM 0402 1NF 50V 10%	P	AA
C 2706	VCKYCZ1HB472KY	C CERAM 0402 4.7NF 50V 10%	P	AA
C 2707	VCCCCZ1HH101JY	C CERAM 0402 100PF 50V 5%	P	AA
C 2708	VCCCCZ1HH681JY	C CERAM 0402 680PF 50V 5%	P	AA
C 2709	VCKYT1CB104KY	C CERAM 100NF 16V 2125SMD	P	AB
C 2710	VCKYT1CB104KY	C CERAM 100NF 16V 2125SMD	P	AB
C 2711	VCKYT1CB104KY	C CERAM 100NF 16V 2125SMD	P	AB
C 2712	VCKYT1CB104KY	C CERAM 100NF 16V 2125SMD	P	AB
C 2713	VCKYT1CB104KY	C CERAM 100NF 16V 2125SMD	P	AB
C 2714	RC-KZA621WJQZY	C CERAM 1uF 25V TMK107BJ105KAFT	P	AA
C 2715	VCKYT1CB104KY	C CERAM 100NF 16V 2125SMD	P	AB
C 2716	RC-KZA621WJQZY	C CERAM 1uF 25V TMK107BJ105KAFT	P	AA
C 2717	VCKYCZ1HB331KY	C CERAM 0402 330PF 50V 10%	P	AA
C 2718	VCKYCZ1EF104ZY	C CERAM 0402 100NF 25V 20%	P	AD
C 2719	VCKYCZ0JF105ZY	C CERAM 0402 1uF 6.3V 20%	P	AD
C 2720	VCKYCZ0JF105ZY	C CERAM 0402 1uF 6.3V 20%	P	AD
C 2721	VCKYCZ1HB331KY	C CERAM 0402 330PF 50V 10%	P	AA
C 2722	RC-KZA116WJZZY	C CERAM 4.7UF 6.3V GRM188B30J475KE18D	P	AD
C 2723	RC-KZA388WJZZY	C CERAM 10uF 6.3V GRM188B30J106ME69D	P	AM
C 2724	VCEASX1CN476MY	C ELEC 47UF 16V MVL16VC47MF80E1	P	AD
C 2725	RC-EZ1339CEZZY	C ELEC 220UF 16V	P	AF
C 2726	RC-EZ1339CEZZY	C ELEC 220UF 16V	P	AF
C 2727	VCCCCZ1HH220JY	CERAM C 0402 22PF 50V 5%	P	AA
C 2728	VCCCCZ1HH220JY	CERAM C 0402 22PF 50V 5%	P	AA
C 2729	RC-EZ1339CEZZY	C ELEC 220UF 16V	P	AF
C 2730	VCKYCZ1HB331KY	C CERAM 0402 330PF 50V 10%	P	AA
C 2731	VCKYCZ1HB331KY	C CERAM 0402 330PF 50V 10%	P	AA
C 2732	VCKYCZ1HB331KY	C CERAM 0402 330PF 50V 10%	P	AA
C 2733	VCKYCZ1AB474KY	C CERAM 0402 470NF 10V 10%	P	AB
C 2734	VCKYT1CB684KY	C CERAM 680NF 16V 2125SMD	P	AB
C 2735	VCKYT1CB684KY	C CERAM 680NF 16V 2125SMD	P	AB
C 2736	VCKYCZ1EF104ZY	C CERAM 0402 100NF 25V 20%	P	AD
C 2737	VCKYCZ1EF104ZY	C CERAM 0402 100NF 25V 20%	P	AD
C 2738	VCKYCZ1EF104ZY	C CERAM 0402 100NF 25V 20%	P	AD
C 2739	VCKYCZ1EF104ZY	C CERAM 0402 100NF 25V 20%	P	AD
C 2740	VCKYCZ1EF104ZY	C CERAM 0402 100NF 25V 20%	P	AD
C 2741	VCKYCZ1EF104ZY	C CERAM 0402 100NF 25V 20%	P	AD
C 2742	VCKYCZ1HB102KY	C CERAM 0402 1NF 50V 10%	P	AA
C 2743	VCKYCZ1HB102KY	C CERAM 0402 1NF 50V 10%	P	AA
C 2744	VCKYCZ1EF104ZY	C CERAM 0402 100NF 25V 20%	P	AD
C 2745	VCKYCZ1EF104ZY	C CERAM 0402 100NF 25V 20%	P	AD
C 2746	VCKYCZ1HB102KY	C CERAM 0402 1NF 50V 10%	P	AA
C 2747	VCKYCZ1HB102KY	C CERAM 0402 1NF 50V 10%	P	AA
C 2748	VCKYCZ1HB102KY	C CERAM 0402 1NF 50V 10%	P	AA
C 2749	RC-EZ1339CEZZY	C ELEC 220UF 16V	P	AF

REF No.	PARTS	DESCRIPTION	*	PRICE CODE
C 2751	VCEASX1CN476MY	C ELEC 47UF 16V MVL16VC47MF60E1	P	AD
C 3301	VCCCCZ1HH200JY	CERAM C 0402 20PF 50V 5%	P	AA
C 3302	VCCCCZ1HH200JY	CERAM C 0402 20PF 50V 5%	P	AA
C 3304	VCCCCZ1HH391JY	CERAM C 0402 390PF 50V 5%	P	AA
C 3305	VCKYCZ1CB123KY	C CERAM 0402 12NF 16V 10%	P	AA
C 3306	VCKYCZ1EF104ZY	C CERAM 0402 100NF 25V 20%	P	AD
C 3307	VCKYCZ1EF104ZY	C CERAM 0402 100NF 25V 20%	P	AD
C 3308	VCKYCZ0JF105ZY	C CERAM 0402 1uF 6.3V 20%	P	AD
C 3309	VCKYCZ1HB332KY	C CERAM 0402 3.3NF 50V 10%	P	AA
C 3310	VCCCCZ1HH101JY	C CERAM 0402 100PF 50V 5%	P	AA
C 3311	VCKYCZ1EF104ZY	C CERAM 0402 100NF 25V 20%	P	AD
C 3312	VCKYCZ0JF105ZY	C CERAM 0402 1uF 6.3V 20%	P	AD
C 3313	VCCCCZ1HH221JY	CERAM C 0402 220PF 50V 5%	P	AA
C 3314	RC-KZA388WJZZY	C CERAM 10uF 6.3V GRM188B30J106ME69D	P	AM
C 3315	RC-KZA116WJZZY	C CERAM 4.7UF 6.3V GRM188B30J475KE18D	P	AD
C 3316	VCKYCZ1EF104ZY	C CERAM 0402 100NF 25V 20%	P	AD
C 3317	VCKYCZ1EF104ZY	C CERAM 0402 100NF 25V 20%	P	AD
C 3320	VCKYCZ1CB103KY	C CERAM 0402 10NF 16V 10%	P	AA
C 3321	VCKYCZ1CB103KY	C CERAM 0402 10NF 16V 10%	P	AA
C 3322	VCKYCZ1CB103KY	C CERAM 0402 10NF 16V 10%	P	AA
C 3323	VCKYCZ1EF104ZY	C CERAM 0402 100NF 25V 20%	P	AD
C 3324	RC-KZA116WJZZY	C CERAM 4.7UF 6.3V GRM188B30J475KE18D	P	AD
C 3325	VCKYCZ1EF104ZY	C CERAM 0402 100NF 25V 20%	P	AD
C 3326	RC-KZA116WJZZY	C CERAM 4.7UF 6.3V GRM188B30J475KE18D	P	AD
C 3327	VCCCCZ1HH221JY	CERAM C 0402 220PF 50V 5%	P	AA
C 3328	VCCCCZ1HH221JY	CERAM C 0402 220PF 50V 5%	P	AA
C 3329	VCCCCZ1HH221JY	CERAM C 0402 220PF 50V 5%	P	AA
C 3330	VCCCCZ1HH180JY	CERAM C 0402 18PF 50V 5%	P	AA
C 3331	VCKYCZ1CB473KY	C CERAM 0402 47NF 16V 10%	P	AB
C 3332	VCKYCZ1EF104ZY	C CERAM 0402 100NF 25V 20%	P	AD
C 3333	VCEASX0JN477MY	C ELEC 470UF 6.3V MLA6.3VC470MF80	P	AF
C 3334	VCKYCZ1CB473KY	C CERAM 0402 47NF 16V 10%	P	AB
C 3335	VCCCCZ1HH221JY	CERAM C 0402 220PF 50V 5%	P	AA
C 3336	VCCCCZ1HH180JY	CERAM C 0402 18PF 50V 5%	P	AA
C 3337	VCCCCZ1HH221JY	CERAM C 0402 220PF 50V 5%	P	AA
C 3401	VCKYCZ1EF104ZY	C CERAM 0402 100NF 25V 20%	P	AD
C 3402	VCKYCZ1EF104ZY	C CERAM 0402 100NF 25V 20%	P	AD
C 3403	VCKYCZ1HB331KY	C CERAM 0402 330PF 50V 10%	P	AA
C 3404	VCKYCZ1HB331KY	C CERAM 0402 330PF 50V 10%	P	AA
C 3405	VCKYCZ1EF104ZY	C CERAM 0402 100NF 25V 20%	P	AD
C 3406	VCKYCZ1EF104ZY	C CERAM 0402 100NF 25V 20%	P	AD
C 3407	VCKYCZ1EF104ZY	C CERAM 0402 100NF 25V 20%	P	AD
C 3410	VCKYCZ1CB103KY	C CERAM 0402 10NF 16V 10%	P	AA
C 3411	VCKYCZ1EF104ZY	C CERAM 0402 100NF 25V 20%	P	AD
C 3412	VCKYCZ1HB102KY	C CERAM 0402 1NF 50V 10%	P	AA
C 3413	RC-KZA810WJQZY	C CERAM 4.7UF GRM155B30G475ME87D	P	AB
C 3414	RC-KZA388WJZZY	C CERAM 10uF 6.3V GRM188B30J106ME69D	P	AM
C 3415	VCKYCZ1EF104ZY	C CERAM 0402 100NF 25V 20%	P	AD
C 3416	VCKYCZ1EF104ZY	C CERAM 0402 100NF 25V 20%	P	AD
C 3417	RC-KZA810WJQZY	C CERAM 4.7UF GRM155B30G475ME87D	P	AB
C 3418	VCKYCZ1EF104ZY	C CERAM 0402 100NF 25V 20%	P	AD
C 3419	VCKYCZ1EF104ZY	C CERAM 0402 100NF 25V 20%	P	AD
C 3420	VCKYCZ1EF104ZY	C CERAM 0402 100NF 25V 20%	P	AD
C 3421	VCKYCZ1HB102KY	C CERAM 0402 1NF 50V 10%	P	AA
C 3422	VCKYCY0JB105KY	CONDENSADOR GRM39B 105K 6.3 (1608)SMD	P	AB
C 3423	RC-KZA388WJZZY	C CERAM 10uF 6.3V GRM188B30J106ME69D	P	AM
C 3424	VCKYCZ1EF104ZY	C CERAM 0402 100NF 25V 20%	P	AD
C 3425	VCKYCZ0JF105ZY	C CERAM 0402 1uF 6.3V 20%	P	AD
C 3426	VCKYCZ1EF104ZY	C CERAM 0402 100NF 25V 20%	P	AD
C 3427	VCKYCZ0JF105ZY	C CERAM 0402 1uF 6.3V 20%	P	AD
C 3428	VCKYCZ1EF104ZY	C CERAM 0402 100NF 25V 20%	P	AD
C 3429	VCKYCZ0JF105ZY	C CERAM 0402 1uF 6.3V 20%	P	AD
C 3430	VCKYCZ0JF105ZY	C CERAM 0402 1uF 6.3V 20%	P	AD
C 3431	VCKYCZ1EF104ZY	C CERAM 0402 100NF 25V 20%	P	AD
C 3432	VCKYCZ0JF105ZY	C CERAM 0402 1uF 6.3V 20%	P	AD
C 3433	VCKYCZ1EF104ZY	C CERAM 0402 100NF 25V 20%	P	AD
C 3434	RC-KZA116WJZZY	C CERAM 4.7UF 6.3V GRM188B30J475KE18D	P	AD
C 3435	VCKYCZ1EF104ZY	C CERAM 0402 100NF 25V 20%	P	AD
C 3436	VCKYCZ0JF105ZY	C CERAM 0402 1uF 6.3V 20%	P	AD
C 3437	VCKYCZ0JF105ZY	C CERAM 0402 1uF 6.3V 20%	P	AD
C 3438	VCKYCZ1EF104ZY	C CERAM 0402 100NF 25V 20%	P	AD
C 3439	VCKYCZ0JF105ZY	C CERAM 0402 1uF 6.3V 20%	P	AD
C 3440	VCKYCZ1EF104ZY	C CERAM 0402 100NF 25V 20%	P	AD

REF No.	PARTS	DESCRIPTION	*	PRICE CODE
C 3441	VCKYCZ1EF104ZY	C CERAM 0402 100NF 25V 20%	P	AD
C 3442	VCKYCZ0JF105ZY	C CERAM 0402 1uF 6.3V 20%	P	AD
C 3443	VCKYCZ1EF104ZY	C CERAM 0402 100NF 25V 20%	P	AD
C 3444	VCKYCZ0JF105ZY	C CERAM 0402 1uF 6.3V 20%	P	AD
C 3449	VCKYCZ0JF105ZY	C CERAM 0402 1uF 6.3V 20%	P	AD
C 3450	VCKYCZ1EF104ZY	C CERAM 0402 100NF 25V 20%	P	AD
C 3451	RC-KZA116WJZZY	C CERAM 4.7UF 6.3V GRM188B30J475KE18D	P	AD
C 3452	VCKYCZ0JF105ZY	C CERAM 0402 1uF 6.3V 20%	P	AD
C 3453	VCKYCZ1EF104ZY	C CERAM 0402 100NF 25V 20%	P	AD
C 3454	VCKYCZ0GB225MY	C CERAM 0402 2.2UF 4V 10%	P	AC
C 3455	VCKYCZ1EF104ZY	C CERAM 0402 100NF 25V 20%	P	AD
C 3456	VCKYCZ0GB225MY	C CERAM 0402 2.2UF 4V 10%	P	AC
C 3457	VCKYCZ1EF104ZY	C CERAM 0402 100NF 25V 20%	P	AD
C 3458	VCKYCZ0GB225MY	C CERAM 0402 2.2UF 4V 10%	P	AC
C 3459	VCKYCZ1EF104ZY	C CERAM 0402 100NF 25V 20%	P	AD
C 3460	VCKYCZ0GB225MY	C CERAM 0402 2.2UF 4V 10%	P	AC
C 3461	VCKYCZ1EF104ZY	C CERAM 0402 100NF 25V 20%	P	AD
C 3462	VCKYCZ0JF105ZY	C CERAM 0402 1uF 6.3V 20%	P	AD
C 3463	VCKYCZ1EF104ZY	C CERAM 0402 100NF 25V 20%	P	AD
C 3464	RC-KZA116WJZZY	C CERAM 4.7UF 6.3V GRM188B30J475KE18D	P	AD
C 3465	VCKYCZ0GB225MY	C CERAM 0402 2.2UF 4V 10%	P	AC
C 3466	VCKYCZ1EF104ZY	C CERAM 0402 100NF 25V 20%	P	AD
C 3467	VCKYCZ0JF105ZY	C CERAM 0402 1uF 6.3V 20%	P	AD
C 3468	RC-KZA388WJZZY	C CERAM 10uF 6.3V GRM188B30J106ME69D	P	AM
C 3469	VCKYCZ0JF105ZY	C CERAM 0402 1uF 6.3V 20%	P	AD
C 3470	VCKYCZ0JF105ZY	C CERAM 0402 1uF 6.3V 20%	P	AD
C 3471	VCKYCZ1EF104ZY	C CERAM 0402 100NF 25V 20%	P	AD
C 3472	VCKYCZ1HB102KY	C CERAM 0402 1NF 50V 10%	P	AA
C 3473	RC-KZA388WJZZY	C CERAM 10uF 6.3V GRM188B30J106ME69D	P	AM
C 3474	VCKYCZ0JF105ZY	C CERAM 0402 1uF 6.3V 20%	P	AD
C 3475	RC-KZA388WJZZY	C CERAM 10uF 6.3V GRM188B30J106ME69D	P	AM
C 3476	VCKYCZ0JF105ZY	C CERAM 0402 1uF 6.3V 20%	P	AD
C 3477	VCKYCZ1EF104ZY	C CERAM 0402 100NF 25V 20%	P	AD
C 3478	VCKYCZ1HB102KY	C CERAM 0402 1NF 50V 10%	P	AA
C 3479	RC-KZA116WJZZY	C CERAM 4.7UF 6.3V GRM188B30J475KE18D	P	AD
C 3480	VCKYCZ1EF104ZY	C CERAM 0402 100NF 25V 20%	P	AD
C 3481	RC-KZA116WJZZY	C CERAM 4.7UF 6.3V GRM188B30J475KE18D	P	AD
C 3482	RC-KZA388WJZZY	C CERAM 22UF 6.3V JMK212B/J226KG-T	P	AE
C 3483	RC-KZA388WJZZY	C CERAM 10uF 6.3V GRM188B30J106ME69D	P	AM
C 3484	VCEASX1CN476MY	C ELEC 47UF 16V MVL16VC47MF60E1	P	AD
C 3485	RC-KZA388WJZZY	C CERAM 10uF 6.3V GRM188B30J106ME69D	P	AM
C 3501	VCKYCZ0JF105ZY	C CERAM 0402 1uF 6.3V 20%	P	AD
C 3502	VCKYCZ0JF105ZY	C CERAM 0402 1uF 6.3V 20%	P	AD
C 3503	VCKYCZ0JF105ZY	C CERAM 0402 1uF 6.3V 20%	P	AD
C 3504	VCKYCZ1EF104ZY	C CERAM 0402 100NF 25V 20%	P	AD
C 3505	RC-KZA388WJZZY	C CERAM 22UF 6.3V JMK212B/J226KG-T	P	AE
C 3506	VCKYCZ1EF104ZY	C CERAM 0402 100NF 25V 20%	P	AD
C 3507	RC-KZA388WJZZY	C CERAM 22UF 6.3V JMK212B/J226KG-T	P	AE
C 3508	VCKYCZ1EF104ZY	C CERAM 0402 100NF 25V 20%	P	AD
C 3509	VCKYCZ1EF104ZY	C CERAM 0402 100NF 25V 20%	P	AD
C 3510	VCKYCZ0JF105ZY	C CERAM 0402 1uF 6.3V 20%	P	AD
C 3511	VCKYCZ1EF104ZY	C CERAM 0402 100NF 25V 20%	P	AD
C 3512	VCKYCZ0JF105ZY	C CERAM 0402 1uF 6.3V 20%	P	AD
C 3513	VCKYCZ1EF104ZY	C CERAM 0402 100NF 25V 20%	P	AD
C 3514	VCKYCZ1EF104ZY	C CERAM 0402 100NF 25V 20%	P	AD
C 3515	VCKYCZ1EF104ZY	C CERAM 0402 100NF 25V 20%	P	AD
C 3516	VCKYCZ1EF104ZY	C CERAM 0402 100NF 25V 20%	P	AD
C 3517	RC-KZA388WJZZY	C CERAM 10uF 6.3V GRM188B30J106ME69D	P	AM
C 3518	RC-KZA388WJZZY	C CERAM 10uF 6.3V GRM188B30J106ME69D	P	AM
C 3519	VCKYCZ0JF105ZY	C CERAM 0402 1uF 6.3V 20%	P	AD
C 3520	VCAAPE0J227MY	C ELEC 220UF 20V 6.3V 6SVP100M	P	AH
C 3521	VCKYCZ1EF104ZY	C CERAM 0402 100NF 25V 20%	P	AD
C 3522	VCKYCZ1EF104ZY	C CERAM 0402 100NF 25V 20%	P	AD
C 3523	VCKYCZ1EF104ZY	C CERAM 0402 100NF 25V 20%	P	AD
C 3524	VCKYCZ1EF104ZY	C CERAM 0402 100NF 25V 20%	P	AD
C 3525	VCKYCZ1EF104ZY	C CERAM 0402 100NF 25V 20%	P	AD
C 3526	VCKYCZ1EF104ZY	C CERAM 0402 100NF 25V 20%	P	AD
C 3527	VCKYCZ1EF104ZY	C CERAM 0402 100NF 25V 20%	P	AD
C 3528	VCKYCZ1EF104ZY	C CERAM 0402 100NF 25V 20%	P	AD
C 3529	VCKYCZ1EF104ZY	C CERAM 0402 100NF 25V 20%	P	AD
C 3530	VCKYCZ1EF104ZY	C CERAM 0402 100NF 25V 20%	P	AD
C 3531	VCKYCZ1EF104ZY	C CERAM 0402 100NF 25V 20%	P	AD
C 3532	VCKYCZ1EF104ZY	C CERAM 0402 100NF 25V 20%	P	AD

REF No.	PARTS	DESCRIPTION	*	PRICE CODE
C 3533	VCKYCZ1EF104ZY	C CERAM 0402 100NF 25V 20%	P	AD
C 3534	VCKYCZ1EF104ZY	C CERAM 0402 100NF 25V 20%	P	AD
C 3535	VCKYCZ1EF104ZY	C CERAM 0402 100NF 25V 20%	P	AD
C 3536	VCKYCZ1EF104ZY	C CERAM 0402 100NF 25V 20%	P	AD
C 3537	VCKYCZ1EF104ZY	C CERAM 0402 100NF 25V 20%	P	AD
C 3538	VCKYCZ1EF104ZY	C CERAM 0402 100NF 25V 20%	P	AD
C 3539	VCKYCZ1EF104ZY	C CERAM 0402 100NF 25V 20%	P	AD
C 3540	VCKYCZ1EF104ZY	C CERAM 0402 100NF 25V 20%	P	AD
C 3541	VCKYCZ1EF104ZY	C CERAM 0402 100NF 25V 20%	P	AD
C 3542	VCKYCZ1EF104ZY	C CERAM 0402 100NF 25V 20%	P	AD
C 3543	VCKYCZ1EF104ZY	C CERAM 0402 100NF 25V 20%	P	AD
C 3544	VCKYCZ1EF104ZY	C CERAM 0402 100NF 25V 20%	P	AD
C 3545	VCKYCZ1EF104ZY	C CERAM 0402 100NF 25V 20%	P	AD
C 3546	VCKYCZ1EF104ZY	C CERAM 0402 100NF 25V 20%	P	AD
C 3547	VCEASY1CN107MY	C ELEC 100UF 20% 16V MVL16VC100MF61	P	AB
C 3548	RC-KZA388WJZZY	C CERAM 10uF 6.3V GRM188B30J106ME69D	P	AM
C 3549	RC-KZA388WJZZY	C CERAM 10uF 6.3V GRM188B30J106ME69D	P	AM
C 3601	RC-KZA388WJZZY	C CERAM 10uF 6.3V GRM188B30J106ME69D	P	AM
C 3602	VCKYCZ1EF104ZY	C CERAM 0402 100NF 25V 20%	P	AD
C 3603	VCKYCZ1EF104ZY	C CERAM 0402 100NF 25V 20%	P	AD
C 3604	VCKYCZ1EF104ZY	C CERAM 0402 100NF 25V 20%	P	AD
C 3605	VCKYCZ1EF104ZY	C CERAM 0402 100NF 25V 20%	P	AD
C 3606	VCKYCZ1CB103KY	C CERAM 0402 10NF 16V 10%	P	AA
C 3607	VCKYCZ1EF104ZY	C CERAM 0402 100NF 25V 20%	P	AD
C 3608	VCKYCZ1EF104ZY	C CERAM 0402 100NF 25V 20%	P	AD
C 3609	VCKYCZ1EF104ZY	C CERAM 0402 100NF 25V 20%	P	AD
C 3610	VCKYCZ1CB103KY	C CERAM 0402 10NF 16V 10%	P	AA
C 3611	VCKYCZ1CB103KY	C CERAM 0402 10NF 16V 10%	P	AA
C 3615	VCKYCZ1EF104ZY	C CERAM 0402 100NF 25V 20%	P	AD
C 3616	VCKYCZ1EF104ZY	C CERAM 0402 100NF 25V 20%	P	AD
C 3701	VCKYCZ1HB102KY	C CERAM 0402 1NF 50V 10%	P	AA
C 3702	VCKYCZ1HB102KY	C CERAM 0402 1NF 50V 10%	P	AA
C 3703	VCKYCZ1EF104ZY	C CERAM 0402 100NF 25V 20%	P	AD
C 3704	VCKYCZ1EF104ZY	C CERAM 0402 100NF 25V 20%	P	AD
C 3705	VCKYCZ1CB103KY	C CERAM 0402 10NF 16V 10%	P	AA
C 3706	VCKYCZ1CB103KY	C CERAM 0402 10NF 16V 10%	P	AA
C 3707	VCKYCZ1EF104ZY	C CERAM 0402 100NF 25V 20%	P	AD
C 3708	VCKYCZ1EF104ZY	C CERAM 0402 100NF 25V 20%	P	AD
C 3709	VCKYCZ1EF104ZY	C CERAM 0402 100NF 25V 20%	P	AD
C 3710	VCKYCZ1EF104ZY	C CERAM 0402 100NF 25V 20%	P	AD
C 3711	VCKYCZ1EF104ZY	C CERAM 0402 100NF 25V 20%	P	AD
C 3712	VCKYCZ1EF104ZY	C CERAM 0402 100NF 25V 20%	P	AD
C 3713	VCKYCZ1EF104ZY	C CERAM 0402 100NF 25V 20%	P	AD
C 3714	VCKYCZ1EF104ZY	C CERAM 0402 100NF 25V 20%	P	AD
C 3715	VCKYCZ1EF104ZY	C CERAM 0402 100NF 25V 20%	P	AD
C 3716	VCKYCZ1EF104ZY	C CERAM 0402 100NF 25V 20%	P	AD
C 3717	VCKYCZ1EF104ZY	C CERAM 0402 100NF 25V 20%	P	AD
C 3718	VCKYCZ1EF104ZY	C CERAM 0402 100NF 25V 20%	P	AD
C 3719	VCKYCZ1EF104ZY	C CERAM 0402 100NF 25V 20%	P	AD
C 3720	VCKYCZ1EF104ZY	C CERAM 0402 100NF 25V 20%	P	AD
C 3721	VCKYCZ1EF104ZY	C CERAM 0402 100NF 25V 20%	P	AD
C 3722	VCKYCZ1EF104ZY	C CERAM 0402 100NF 25V 20%	P	AD
C 3723	VCKYCZ1EF104ZY	C CERAM 0402 100NF 25V 20%	P	AD
C 3724	RC-KZA388WJZZY	C CERAM 10uF 6.3V GRM188B30J106ME69D	P	AM
C 3725	VCKYCZ1EF104ZY	C CERAM 0402 100NF 25V 20%	P	AD
C 3726	VCKYCZ1EF104ZY	C CERAM 0402 100NF 25V 20%	P	AD
C 3727	VCKYCZ1EF104ZY	C CERAM 0402 100NF 25V 20%	P	AD
C 3728	VCKYCZ1EF104ZY	C CERAM 0402 100NF 25V 20%	P	AD
C 3729	RC-KZA388WJZZY	C CERAM 10uF 6.3V GRM188B30J106ME69D	P	AM
C 3730	VCKYCZ1EF104ZY	C CERAM 0402 100NF 25V 20%	P	AD
C 3731	VCKYCZ1EF104ZY	C CERAM 0402 100NF 25V 20%	P	AD
C 3732	VCKYCZ1EF104ZY	C CERAM 0402 100NF 25V 20%	P	AD
C 3733	RC-KZA388WJZZY	C CERAM 10uF 6.3V GRM188B30J106ME69D	P	AM
C 3734	RC-KZA388WJZZY	C CERAM 10uF 6.3V GRM188B30J106ME69D	P	AM
C 3735	VCKYCZ1EF104ZY	C CERAM 0402 100NF 25V 20%	P	AD
C 3736	VCKYCZ1EF104ZY	C CERAM 0402 100NF 25V 20%	P	AD
C 3737	VCKYCZ1EF104ZY	C CERAM 0402 100NF 25V 20%	P	AD
C 3738	VCKYCZ1EF104ZY	C CERAM 0402 100NF 25V 20%	P	AD
C 3739	VCKYCZ1EF104ZY	C CERAM 0402 100NF 25V 20%	P	AD
C 3740	RC-KZA388WJZZY	C CERAM 10uF 6.3V GRM188B30J106ME69D	P	AM
C 3741	RC-KZA388WJZZY	C CERAM 10uF 6.3V GRM188B30J106ME69D	P	AM
C 3742	VCKYCZ0JF105ZY	C CERAM 0402 1uF 6.3V 20%	P	AD
C 3743	VCKYCZ1EF104ZY	C CERAM 0402 100NF 25V 20%	P	AD

REF No.	PARTS	DESCRIPTION	*	PRICE CODE
C 3744	RC-KZA385WJZZY	C CERAM 22UF 6.3V JMK212BJ226KG-T	P	AE
C 3745	VCCCCZ1HH200JY	CERAM C 0402 20PF 50V 5%	P	AA
C 3746	VCCCCZ1HH200JY	CERAM C 0402 20PF 50V 5%	P	AA
C 3747	VCKYCZ1EF104ZY	C CERAM 0402 100NF 25V 20%	P	AD
C 3748	VCKYCZ1EF104ZY	C CERAM 0402 100NF 25V 20%	P	AD
C 3749	RC-KZA385WJZZY	C CERAM 22UF 6.3V JMK212BJ226KG-T	P	AE
C 3750	VCKYCZ1EF104ZY	C CERAM 0402 100NF 25V 20%	P	AD
C 4401	RC-KZA388WJZZY	C CERAM 10uF 6.3V GRM188B30J106ME69D	P	AM
C 4402	VCKYCZ0JF105ZY	C CERAM 0402 1uF 6.3V 20%	P	AD
C 4403	VCKYCZ0JF105ZY	C CERAM 0402 1uF 6.3V 20%	P	AD
C 4405	VCKYCZ1EF104ZY	C CERAM 0402 100NF 25V 20%	P	AD
C 4406	VCKYCZ1EF104ZY	C CERAM 0402 100NF 25V 20%	P	AD
C 4407	VCKYCZ1EF104ZY	C CERAM 0402 100NF 25V 20%	P	AD
C 4408	RC-KZA388WJZZY	C CERAM 10uF 6.3V GRM188B30J106ME69D	P	AM
C 4409	VCEASX1CN107MY	C ELEC 100UF 16V MVL16VC100MF80E1	P	AD
C 4410	VCKYCZ1EF104ZY	C CERAM 0402 100NF 25V 20%	P	AD
C 4415	RC-KZA237WJZZY	C CERAM EMK212BJ106KGFT 10UF 16V 10%	P	AD
C 4416	VCKYCZ0JF105ZY	C CERAM 0402 1uF 6.3V 20%	P	AD
C 8401	VCKYCZ1EF104ZY	C CERAM 0402 100NF 25V 20%	P	AD
C 8402	VCKYCZ1EF104ZY	C CERAM 0402 100NF 25V 20%	P	AD
C 9501	VCKYCZ1EF104ZY	C CERAM 0402 100NF 25V 20%	P	AD
C 9503	VCKYCZ1CB103KY	C CERAM 0402 10NF 16V 10%	P	AA
C 9504	VCKYCZ1EF104ZY	C CERAM 0402 100NF 25V 20%	P	AD
C 9505	RC-KZA388WJZZY	C CERAM 10uF 6.3V GRM188B30J106ME69D	P	AM
C 9506	VCKYCZ1EF104ZY	C CERAM 0402 100NF 25V 20%	P	AD
C 9507	VCKYCZ1CB103KY	C CERAM 0402 10NF 16V 10%	P	AA
C 9508	VCKYCZ1CB103KY	C CERAM 0402 10NF 16V 10%	P	AA
C 9510	VCKYCZ1EF104ZY	C CERAM 0402 100NF 25V 20%	P	AD
C 9511	VCKYCZ1EF104ZY	C CERAM 0402 100NF 25V 20%	P	AD
C 9512	RC-KZA523WJQZY	C CERAM 1000PF 2000V GR442QR73D102KW01L	P	AC
C 9514	RC-KZA388WJZZY	C CERAM 10uF 6.3V GRM188B30J106ME69D	P	AM
C 9515	VCKYCZ1EF104ZY	C CERAM 0402 100NF 25V 20%	P	AD
C 9517	VCEASX1CN476MY	C ELEC 47UF 16V MVL16VC47MF80E1	P	AD
C 9520	RC-KZA388WJZZY	C CERAM 10uF 6.3V GRM188B30J106ME69D	P	AM
C 9551	RC-KZA616WJQZY	C CERAM 10uF 10V LMK212BJ106KGFT	P	AA
C 9552	VCKYCZ1EF104ZY	C CERAM 0402 100NF 25V 20%	P	AD
C 9553	VCKYCZ1EF104ZY	C CERAM 0402 100NF 25V 20%	P	AD
C 9554	VCKYCZ1EF104ZY	C CERAM 0402 100NF 25V 20%	P	AD
C 9556	VCAAPE1AJ127MY	C ELEC 120UF 20% 10V LOW ESR	P	AD
C 9557	VCKYCZ1EF104ZY	C CERAM 0402 100NF 25V 20%	P	AD
C 9559	VCKYCZ1EF104ZY	C CERAM 0402 100NF 25V 20%	P	AD
C 9560	VCAAPE0J227MY	C ELEC 220UF 20% 6.3V 65VP100M	P	AH
C 9561	VCKYCZ1EF104ZY	C CERAM 0402 100NF 25V 20%	P	AD
C 9562	VCKYCZ1EF104ZY	C CERAM 0402 100NF 25V 20%	P	AD
C 9563	VCKYCZ1EF104ZY	C CERAM 0402 100NF 25V 20%	P	AD
C 9564	VCKYCZ1EF104ZY	C CERAM 0402 100NF 25V 20%	P	AD
C 9565	VCKYCY0JB105KY	CONDENSADOR GRM39B 105K 6.3 (1608)SMD	P	AB
C 9566	VCCCCZ1HH200JY	C CERAM 0402 12PF 50V 5%	P	AA
C 9567	VCKYCZ1EF104ZY	C CERAM 0402 100NF 25V 20%	P	AD
C 9568	VCCCCZ1HH200JY	C CERAM 0402 12PF 50V 5%	P	AA
C 9569	VCKYCY0JB105KY	CONDENSADOR GRM39B 105K 6.3 (1608)SMD	P	AB
C 9570	VCKYCZ1EF104ZY	C CERAM 0402 100NF 25V 20%	P	AD
C 9571	VCKYCZ1EF104ZY	C CERAM 0402 100NF 25V 20%	P	AD
C 9572	VCKYCZ1EF104ZY	C CERAM 0402 100NF 25V 20%	P	AD
C 9573	VCKYCZ1EF104ZY	C CERAM 0402 100NF 25V 20%	P	AD
C 9574	RC-KZA388WJZZY	C CERAM 10uF 6.3V GRM188B30J106ME69D	P	AM
C 9575	RC-KZA237WJZZY	C CERAM EMK212BJ106KGFT 10UF 16V 10%	P	AD
C 9576	RC-KZA616WJQZY	C CERAM 10uF 10V LMK212BJ106KGFT	P	AA
C 9577	RC-KZA616WJQZY	C CERAM 10uF 10V LMK212BJ106KGFT	P	AA
C 9601	VCKYCZ1CB103KY	C CERAM 0402 10NF 16V 10%	P	AA
C 9604	VCEASX0JN107MY	C ELEC 100UF 6.3V MVL6.3VC100MF60E1	P	AD
C 9605	VCKYCZ1EF104ZY	C CERAM 0402 100NF 25V 20%	P	AD
C 9606	VCKYCZ1EF104ZY	C CERAM 0402 100NF 25V 20%	P	AD
C 9607	RC-KZA116WJZZY	C CERAM 4.7UF 6.3V GRM188B30J475KE18D	P	AD
C 9608	RC-KZA385WJZZY	C CERAM 22UF 6.3V JMK212BJ226KG-T	P	AE
C 9609	RC-KZA385WJZZY	C CERAM 22UF 6.3V JMK212BJ226KG-T	P	AE
C 9610	RC-KZA385WJZZY	C CERAM 22UF 6.3V JMK212BJ226KG-T	P	AE
C 9611	VCEASX1CN107MY	C ELEC 100UF 16V MVL16VC100MF80E1	P	AD
C 9612	VCKYCZ1EF104ZY	C CERAM 0402 100NF 25V 20%	P	AD
C 9613	RC-KZA237WJZZY	C CERAM EMK212BJ106KGFT 10UF 16V 10%	P	AD
C 9614	VCKYCZ1EF104ZY	C CERAM 0402 100NF 25V 20%	P	AD
C 9615	VCKYCZ1CB103KY	C CERAM 0402 10NF 16V 10%	P	AA
C 9617	VCKYCZ1EF104ZY	C CERAM 0402 100NF 25V 20%	P	AD

REF No.	PARTS	DESCRIPTION	*	PRICE CODE
C 9618	RC-KZA237WJZY	C CERAM EMK212B106KGFT 10UF 16V 10%	P	AD
C 9619	VCKYCZ1EF104ZY	C CERAM 0402 100NF 25V 20%	P	AD
C 9620	VCCCCZ1HH150JY	C CERAM 0402 15PF 50V 5%	P	AA
C 9621	RC-KZA388WJZY	C CERAM 10uF 6,3V GRM188B30J106ME69D	P	AM
C 9622	RC-KZA385WJZY	C CERAM 22UF 6,3V JMK212BJ226KG-T	P	AE
C 9623	RC-KZA385WJZY	C CERAM 22UF 6,3V JMK212BJ226KG-T	P	AE
C 9624	VCKYCY0JB105KY	CONDENSADOR GRM39B 105K 6.3 (1608)SMD	P	AB
C 9626	RC-KZA385WJZY	C CERAM 22UF 6,3V JMK212BJ226KG-T	P	AE
C 9627	RC-KZA385WJZY	C CERAM 22UF 6,3V JMK212BJ226KG-T	P	AE
C 9628	VCKYCZ1HB332KY	C CERAM 0402 3,3NF 50V 10%	P	AA
C 9629	VCKYCZ1EB103KY	C CERAM 0402 10NF 25V 10%	P	AA
C 9630	RC-KZA388WJZY	C CERAM 10uF 6,3V GRM188B30J106ME69D	P	AM
C 9631	RC-KZA388WJZY	C CERAM 10uF 6,3V GRM188B30J106ME69D	P	AM
C 9632	VCKYCZ1EF104ZY	C CERAM 0402 100NF 25V 20%	P	AD
C 9633	VCKYCZ1EF104ZY	C CERAM 0402 100NF 25V 20%	P	AD
C 9634	VCKYCZ1EF104ZY	C CERAM 0402 100NF 25V 20%	P	AD
C 9635	VCAAPE0J227MY	C ELEC 220UF 20% 6,3V 6SVP100M	P	AH
C 9636	VCKYCZ1EF104ZY	C CERAM 0402 100NF 25V 20%	P	AD
C 9637	RC-KZA116WJZY	C CERAM 4,7UF 6,3V GRM188B30J475KE18D	P	AD
C 9638	VCKYCY0JB105KY	CONDENSADOR GRM39B 105K 6.3 (1608)SMD	P	AB
C 9639	RC-KZA116WJZY	C CERAM 4,7UF 6,3V GRM188B30J475KE18D	P	AD
C 9640	VCKYCZ1EF104ZY	C CERAM 0402 100NF 25V 20%	P	AD
C 9641	RC-KZA116WJZY	C CERAM 4,7UF 6,3V GRM188B30J475KE18D	P	AD
C 9642	VCKYCY0JB105KY	CONDENSADOR GRM39B 105K 6.3 (1608)SMD	P	AB
C 9643	RC-KZA116WJZY	C CERAM 4,7UF 6,3V GRM188B30J475KE18D	P	AD
C 9644	VCKYCZ1EF104ZY	C CERAM 0402 100NF 25V 20%	P	AD
C 9645	RC-KZA116WJZY	C CERAM 4,7UF 6,3V GRM188B30J475KE18D	P	AD
C 9646	VCKYCY0JB105KY	CONDENSADOR GRM39B 105K 6.3 (1608)SMD	P	AB
C 9647	RC-KZA116WJZY	C CERAM 4,7UF 6,3V GRM188B30J475KE18D	P	AD
C 9648	VCKYCZ1EF104ZY	C CERAM 0402 100NF 25V 20%	P	AD
C 9649	RC-KZA237WJZY	C CERAM EMK212B106KGFT 10UF 16V 10%	P	AD
C 9650	VCKYCY0JB105KY	CONDENSADOR GRM39B 105K 6.3 (1608)SMD	P	AB
C 9651	RC-KZA116WJZY	C CERAM 4,7UF 6,3V GRM188B30J475KE18D	P	AD
C 9652	VCKYCZ1CB103KY	C CERAM 0402 10NF 16V 10%	P	AA
C 9653	RC-KZA385WJZY	C CERAM 22UF 6,3V JMK212BJ226KG-T	P	AE
C 9654	VCKYCZ1HB472KY	C CERAM 0402 4,7NF 50V 10%	P	AA
C 9655	VCKYCZ1EF104ZY	C CERAM 0402 100NF 25V 20%	P	AD
C 9656	VCKYCY0JB105KY	CONDENSADOR GRM39B 105K 6.3 (1608)SMD	P	AB
C 9658	RC-KZA385WJZY	C CERAM 22UF 6,3V JMK212BJ226KG-T	P	AE
C 9659	VCKYCZ1EB103KY	C CERAM 0402 10NF 25V 10%	P	AA
C 9660	VCKYCZ1HB332KY	C CERAM 0402 3,3NF 50V 10%	P	AA
C 9661	RC-KZA385WJZY	C CERAM 22UF 6,3V JMK212BJ226KG-T	P	AE
C 9662	VCKYCZ1EF104ZY	C CERAM 0402 100NF 25V 20%	P	AD
C 9664	VCAAPE0J227MY	C ELEC 220UF 20% 6,3V 6SVP100M	P	AH
C 9665	RC-KZA237WJZY	C CERAM EMK212B106KGFT 10UF 16V 10%	P	AD
C 9701	RC-KZA388WJZY	C CERAM 10uF 6,3V GRM188B30J106ME69D	P	AM
C 9702	RC-KZA388WJZY	C CERAM 10uF 6,3V GRM188B30J106ME69D	P	AM
C 9703	RC-KZA388WJZY	C CERAM 10uF 6,3V GRM188B30J106ME69D	P	AM
C 9704	RC-KZA388WJZY	C CERAM 10uF 6,3V GRM188B30J106ME69D	P	AM
C 9705	VCKYCZ1EF104ZY	C CERAM 0402 100NF 25V 20%	P	AD
C 9706	RC-KZA237WJZY	C CERAM EMK212B106KGFT 10UF 16V 10%	P	AD
C 9707	VCKYCZ1CB682KY	C CERAM 0402 6,8NF 16V 10%	P	AA
C 9708	VCKYCZ1CF103ZY	C CERAM 0402 10NF 16V 20%	P	AA
C 9709	VCCCCZ1HH220JY	CERAM C 0402 22PF 50V 5%	P	AA
<b>RESISTORS</b>				
R 0502	VRS-CZ1JF103JY	RES 0402 10KOHM 5% 1/16W SMD	P	AA
R 0503	VRS-CZ1JF101JY	RES 0402 100 OHM 5% 1/16W SMD	P	AA
R 0504	VRS-CZ1JF101JY	RES 0402 100 OHM 5% 1/16W SMD	P	AA
R 0505	VRS-CZ1JF473JY	RES 0402 47KOHM 5% 1/16W SMD	P	AA
R 0506	VRS-CZ1JF473JY	RES 0402 47KOHM 5% 1/16W SMD	P	AA
R 0508	VRS-CZ1JF103JY	RES 0402 10KOHM 5% 1/16W SMD	P	AA
R 0509	VRS-CZ1JF103JY	RES 0402 10KOHM 5% 1/16W SMD	P	AA
R 0510	VRS-CZ1JF123JY	RES 0402 12KOHM 5% 1/16W SMD	P	AA
R 0511	VRS-CZ1JF750JY	RES 0402 75 OHM 5% 1/16W SMD	P	AA
R 0512	VRS-CZ1JF470JY	RES 0402 47 OHM 5% 1/16W SMD	P	AA
R 0513	VRS-CZ1JF102JY	RES 0402 1KOHM 5% 1/16W SMD	P	AA
R 0514	VRS-CZ1JF332JY	RES 0402 3,3KOHM 5% 1/16W SMD	P	AA
R 0515	VRS-CZ1JF750JY	RES 0402 75 OHM 5% 1/16W SMD	P	AA
R 0516	VRS-CZ1JF470JY	RES 0402 47 OHM 5% 1/16W SMD	P	AA
R 0517	VRS-CZ1JF182JY	RES 0402 1,8KOHM 5% 1/16W SMD	P	AA
R 0518	VRS-CZ1JF750JY	RES 0402 75 OHM 5% 1/16W SMD	P	AA
R 0519	VRS-CZ1JF470JY	RES 0402 47 OHM 5% 1/16W SMD	P	AA

REF No.	PARTS	DESCRIPTION	*	PRICE CODE
R 0551	VRS-CZ1JF221JY	RES 0402 220 OHM 5% 1/16W SMD	P	AA
R 0552	VRS-CZ1JF221JY	RES 0402 220 OHM 5% 1/16W SMD	P	AA
R 0555	VRS-CZ1JF104JY	RES 0402 100KOHM 5% 1/16W SMD	P	AA
R 0556	VRS-CZ1JF104JY	RES 0402 100KOHM 5% 1/16W SMD	P	AA
R 0557	VRS-CZ1JF100JY	RES 0402 10 OHM 5% 1/16W SMD	P	AA
R 0558	VRS-CZ1JF100JY	RES 0402 10 OHM 5% 1/16W SMD	P	AA
R 0561	VRS-CZ1JF223JY	RES 0402 22KOHM 5% 1/16W SMD	P	AA
R 0562	VRS-CZ1JF223JY	RES 0402 22KOHM 5% 1/16W SMD	P	AA
R 0563	VRS-CZ1JF223JY	RES 0402 22KOHM 5% 1/16W SMD	P	AA
R 0565	VRS-CZ1JF223JY	RES 0402 22KOHM 5% 1/16W SMD	P	AA
R 0567	VRS-CZ1JF473JY	RES 0402 47KOHM 5% 1/16W SMD	P	AA
R 0568	VRS-CZ1JF473JY	RES 0402 47KOHM 5% 1/16W SMD	P	AA
R 0569	VRS-CZ1JF101JY	RES 0402 100 OHM 5% 1/16W SMD	P	AA
R 0572	VRS-CZ1JF471JY	RES 0402 470 OHM 5% 1/16W SMD	P	AA
R 0573	VRS-CZ1JF471JY	RES 0402 470 OHM 5% 1/16W SMD	P	AA
R 0574	VRS-CZ1JF103JY	RES 0402 10KOHM 5% 1/16W SMD	P	AA
R 0575	VRS-CZ1JF103JY	RES 0402 10KOHM 5% 1/16W SMD	P	AA
R 0576	VRS-CZ1JF101JY	RES 0402 100 OHM 5% 1/16W SMD	P	AA
R 0577	VRS-CZ1JF101JY	RES 0402 100 OHM 5% 1/16W SMD	P	AA
R 0578	VRS-CZ1JF470JY	RES 0402 47 OHM 5% 1/16W SMD	P	AA
R 0579	VRS-CZ1JF470JY	RES 0402 47 OHM 5% 1/16W SMD	P	AA
R 0580	VRS-CZ1JF470JY	RES 0402 47 OHM 5% 1/16W SMD	P	AA
R 0581	VRS-CZ1JF933JY	RES 0402 3,3 OHM 5% 1/16W SMD	P	AA
R 0582	VRS-CZ1JF123JY	RES 0402 12KOHM 5% 1/16W SMD	P	AA
R 0584	VRS-CZ1JF750JY	RES 0402 75 OHM 5% 1/16W SMD	P	AA
R 0585	VRS-CZ1JF750JY	RES 0402 75 OHM 5% 1/16W SMD	P	AA
R 0586	VRS-CZ1JF750JY	RES 0402 75 OHM 5% 1/16W SMD	P	AA
R 0589	VRS-CZ1JF750JY	RES 0402 75 OHM 5% 1/16W SMD	P	AA
R 0590	VRS-CZ1JF103JY	RES 0402 10KOHM 5% 1/16W SMD	P	AA
R 0591	VRS-CZ1JF103JY	RES 0402 10KOHM 5% 1/16W SMD	P	AA
R 0592	VRS-CZ1JF750JY	RES 0402 75 OHM 5% 1/16W SMD	P	AA
R 0593	VRS-CZ1JF750JY	RES 0402 75 OHM 5% 1/16W SMD	P	AA
R 0594	VRS-CZ1JF750JY	RES 0402 75 OHM 5% 1/16W SMD	P	AA
R 0595	VRS-CZ1JF750JY	RES 0402 75 OHM 5% 1/16W SMD	P	AA
R 0596	VRS-CZ1JF103JY	RES 0402 10KOHM 5% 1/16W SMD	P	AA
R 0597	VRS-CZ1JF470JY	RES 0402 47 OHM 5% 1/16W SMD	P	AA
R 0598	VRS-CZ1JF510JY	RES 0402 51 OHM 5% 1/16W SMD	P	AA
R 0599	VRS-CZ1JF123JY	RES 0402 12KOHM 5% 1/16W SMD	P	AA
R 0600	VRS-CZ1JF470JY	RES 0402 47 OHM 5% 1/16W SMD	P	AA
R 0601	VRS-CZ1JF470JY	RES 0402 47 OHM 5% 1/16W SMD	P	AA
R 0602	VRS-CZ1JF470JY	RES 0402 47 OHM 5% 1/16W SMD	P	AA
R 0603	VRS-CZ1JF470JY	RES 0402 47 OHM 5% 1/16W SMD	P	AA
R 0604	VRS-CZ1JF240JY	RES 0402 24 OHM 5% 1/16W SMD	P	AA
R 0605	VRS-CZ1JF123JY	RES 0402 12KOHM 5% 1/16W SMD	P	AA
R 0606	VRS-CZ1JF123JY	RES 0402 12KOHM 5% 1/16W SMD	P	AA
R 0607	VRS-CZ1JF100JY	RES 0402 10 OHM 5% 1/16W SMD	P	AA
R 0608	VRS-CZ1JF113JY	RES 0402 11KOHM 5% 1/16W SMD	P	AA
R 0609	VRS-CZ1JF102JY	RES 0402 1KOHM 5% 1/16W SMD	P	AA
R 0610	VRS-CZ1JF103JY	RES 0402 10KOHM 5% 1/16W SMD	P	AA
R 0611	VRS-CZ1JF123JY	RES 0402 12KOHM 5% 1/16W SMD	P	AA
R 0612	VRS-CZ1JF100JY	RES 0402 10 OHM 5% 1/16W SMD	P	AA
R 0614	VRS-CZ1JF104JY	RES 0402 100KOHM 5% 1/16W SMD	P	AA
R 0615	VRS-CZ1JF104JY	RES 0402 100KOHM 5% 1/16W SMD	P	AA
R 1104	VRS-CZ1JF000JY	RES 0402 0 OHM 5% 1/16W SMD	P	AA
R 1106	VRS-CZ1JF202JY	RES 0402 20KOHM 5% 1/16W SMD	P	AA
R 1107	VRS-CZ1JF000JY	RES 0402 0 OHM 5% 1/16W SMD	P	AA
R 1108	VRS-CZ1JF000JY	RES 0402 0 OHM 5% 1/16W SMD	P	AA
R 1125	VRS-CZ1JF101JY	RES 0402 100 OHM 5% 1/16W SMD	P	AA
R 1136	VRS-CZ1JF101JY	RES 0402 100 OHM 5% 1/16W SMD	P	AA
R 1501	VRS-CZ1JF103JY	RES 0402 10KOHM 5% 1/16W SMD	P	AA
R 1502	VRS-CZ1JF103JY	RES 0402 10KOHM 5% 1/16W SMD	P	AA
R 1503	VRS-CZ1JF473JY	RES 0402 47KOHM 5% 1/16W SMD	P	AA
R 1504	VRS-CZ1JF473JY	RES 0402 47KOHM 5% 1/16W SMD	P	AA
R 1505	VRS-CZ1JF473JY	RES 0402 47KOHM 5% 1/16W SMD	P	AA
R 1506	VRS-CZ1JF473JY	RES 0402 47KOHM 5% 1/16W SMD	P	AA
R 1507	VRS-CZ1JF103JY	RES 0402 10KOHM 5% 1/16W SMD	P	AA
R 1508	VRS-CZ1JF103JY	RES 0402 10KOHM 5% 1/16W SMD	P	AA
R 1509	VRS-CZ1JF473JY	RES 0402 47KOHM 5% 1/16W SMD	P	AA
R 1510	VRS-CZ1JF473JY	RES 0402 47KOHM 5% 1/16W SMD	P	AA
R 1511	VRS-CZ1JF473JY	RES 0402 47KOHM 5% 1/16W SMD	P	AA
R 1512	VRS-CZ1JF473JY	RES 0402 47KOHM 5% 1/16W SMD	P	AA
R 1514	VRS-CZ1JF750JY	RES 0402 75 OHM 5% 1/16W SMD	P	AA
R 1515	VRS-CZ1JF101JY	RES 0402 100 OHM 5% 1/16W SMD	P	AA

REF No.	PARTS	DESCRIPTION	*	PRICE CODE
R 1516	VRS-CZ1JF750JY	RES 0402 75 OHM 5% 1/16W SMD	P	AA
R 1517	VRS-CZ1JF221JY	RES 0402 220 OHM 5% 1/16W SMD	P	AA
R 1528	VRS-CZ1JB4641FT	RES 0402 4K64 OHM 1% 1/16W SMD	P	AA
R 1532	VRS-CZ1JF273JY	RES 0402 27KOHM 5% 1/16W SMD	P	AA
R 1535	VRS-CZ1JF472JY	RES 0402 4.7KOHM 5% 1/16W SMD	P	AA
R 1537	VRS-CZ1JF220JY	RES 0402 22 OHM 5% 1/16W SMD	P	AA
R 1538	VRS-CZ1JF102JY	RES 0402 10 OHM 5% 1/16W SMD	P	AA
R 1539	VRS-CZ1JF101JY	RES 0402 100 OHM 5% 1/16W SMD	P	AA
R 1540	VRS-CZ1JF101JY	RES 0402 100 OHM 5% 1/16W SMD	P	AA
R 1541	VRS-CZ1JF102JY	RES 0402 1KOHM 5% 1/16W SMD	P	AA
R 1542	VRS-CZ1JF101JY	RES 0402 100 OHM 5% 1/16W SMD	P	AA
R 1543	VRS-CZ1JF101JY	RES 0402 100 OHM 5% 1/16W SMD	P	AA
R 1544	VRS-CZ1JF102JY	RES 0402 1KOHM 5% 1/16W SMD	P	AA
R 1545	VRS-CZ1JF101JY	RES 0402 100 OHM 5% 1/16W SMD	P	AA
R 1546	VRS-CZ1JF101JY	RES 0402 100 OHM 5% 1/16W SMD	P	AA
R 1547	VRS-CZ1JF102JY	RES 0402 1KOHM 5% 1/16W SMD	P	AA
R 1548	VRS-CZ1JF101JY	RES 0402 100 OHM 5% 1/16W SMD	P	AA
R 1549	VRS-CZ1JF101JY	RES 0402 100 OHM 5% 1/16W SMD	P	AA
R 1550	VRS-CZ1JF472JY	RES 0402 4.7KOHM 5% 1/16W SMD	P	AA
R 1551	VRS-CZ1JF472JY	RES 0402 4.7KOHM 5% 1/16W SMD	P	AA
R 1552	VRS-CZ1JF103JY	RES 0402 10KOHM 5% 1/16W SMD	P	AA
R 1554	VRS-CZ1JF000JY	RES 0402 0 OHM 5% 1/16W SMD	P	AA
R 1555	VRS-CZ1JF472JY	RES 0402 4.7KOHM 5% 1/16W SMD	P	AA
R 2507	VRS-CZ1JF472JY	RES 0402 4.7KOHM 5% 1/16W SMD	P	AA
R 2511	VRS-CZ1JF472JY	RES 0402 4.7KOHM 5% 1/16W SMD	P	AA
R 2604	VRS-CZ1JF103JY	RES 0402 10KOHM 5% 1/16W SMD	P	AA
R 2605	VRS-CZ1JF472JY	RES 0402 4.7KOHM 5% 1/16W SMD	P	AA
R 2607	VRS-CZ1JF472JY	RES 0402 4.7KOHM 5% 1/16W SMD	P	AA
R 2614	VRS-CZ1JF000JY	RES 0402 0 OHM 5% 1/16W SMD	P	AA
R 2624	VRS-TW2HPR56JY	RES LCR1/4R15J 0.56 OHM 5% 1/2W SMD	P	AA
R 2625	VRS-TW2HPR56JY	RES LCR1/4R15J 0.56 OHM 5% 1/2W SMD	P	AA
R 2626	VRS-CZ1JF104JY	RES 0402 100KOHM 5% 1/16W SMD	P	AA
R 2627	VRS-CZ1JF103JY	RES 0402 10KOHM 5% 1/16W SMD	P	AA
R 2628	VRS-CZ1JF000JY	RES 0402 0 OHM 5% 1/16W SMD	P	AA
R 2630	VRS-CZ1JF103JY	RES 0402 10KOHM 5% 1/16W SMD	P	AA
R 2637	VRS-CZ1JF000JY	RES 0402 0 OHM 5% 1/16W SMD	P	AA
R 2638	VRS-CZ1JF000JY	RES 0402 0 OHM 5% 1/16W SMD	P	AA
R 2639	VRS-CZ1JF000JY	RES 0402 0 OHM 5% 1/16W SMD	P	AA
R 2647	VRS-CZ1JF471JY	RES 0402 470 OHM 5% 1/16W SMD	P	AA
R 2648	VRS-CZ1JF000JY	RES 0402 0 OHM 5% 1/16W SMD	P	AA
R 2649	VRS-CZ1JF103JY	RES 0402 10KOHM 5% 1/16W SMD	P	AA
R 2659	VRS-CZ1JF330JY	RES 0402 33 OHM 5% 1/16W SMD	P	AA
R 2660	VRS-CZ1JF330JY	RES 0402 33 OHM 5% 1/16W SMD	P	AA
R 2702	VRS-CZ1JF203JY	RES 0402 20KOHM 5% 1/16W SMD	P	AA
R 2703	VRS-CZ1JF330JY	RES 0402 33 OHM 5% 1/16W SMD	P	AA
R 2704	VRS-CZ1JF222JY	RES 0402 2.2KOHM 5% 1/16W SMD	P	AA
R 2705	VRS-CZ1JF472JY	RES 0402 4.7KOHM 5% 1/16W SMD	P	AA
R 2706	VRS-CZ1JF103JY	RES 0402 10KOHM 5% 1/16W SMD	P	AA
R 2707	VRS-CZ1JF103JY	RES 0402 10KOHM 5% 1/16W SMD	P	AA
R 2708	VRS-CZ1JF330JY	RES 0402 33 OHM 5% 1/16W SMD	P	AA
R 2709	VRS-CZ1JF330JY	RES 0402 33 OHM 5% 1/16W SMD	P	AA
R 2710	VRS-CZ1JF330JY	RES 0402 33 OHM 5% 1/16W SMD	P	AA
R 2711	VRS-CZ1JF100JY	RES 0402 10 OHM 5% 1/16W SMD	P	AA
R 2712	VRS-CZ1JF103JY	RES 0402 10KOHM 5% 1/16W SMD	P	AA
R 2713	VRS-CZ1JF330JY	RES 0402 33 OHM 5% 1/16W SMD	P	AA
R 2714	VRS-CZ1JF330JY	RES 0402 33 OHM 5% 1/16W SMD	P	AA
R 2715	VRS-CZ1JF100JY	RES 0402 10 OHM 5% 1/16W SMD	P	AA
R 2716	VRS-CZ1JF330JY	RES 0402 33 OHM 5% 1/16W SMD	P	AA
R 2717	VRS-CZ1JF000JY	RES 0402 0 OHM 5% 1/16W SMD	P	AA
R 2718	VRS-CZ1JF332JY	RES 0402 3.3KOHM 5% 1/16W SMD	P	AA
R 2719	VRS-CZ1JF332JY	RES 0402 3.3KOHM 5% 1/16W SMD	P	AA
R 2720	VRS-CZ1JF332JY	RES 0402 3.3KOHM 5% 1/16W SMD	P	AA
R 2721	VRS-CZ1JF332JY	RES 0402 3.3KOHM 5% 1/16W SMD	P	AA
R 2722	VRS-CZ1JF220JY	RES 0402 22 OHM 5% 1/16W SMD	P	AA
R 2723	VRS-CZ1JF220JY	RES 0402 22 OHM 5% 1/16W SMD	P	AA
R 2724	VRS-CZ1JF333JY	RES 0402 33KOHM 5% 1/16W SMD	P	AA
R 2725	VRS-CZ1JF100JY	RES 0402 10 OHM 5% 1/16W SMD	P	AA
R 2726	VRS-CZ1JF100JY	RES 0402 10 OHM 5% 1/16W SMD	P	AA
R 2727	VRS-TQ2EF220JY	RES OX 22 OHM 5% 1/4W SMD	P	AA
R 2728	VRS-CZ1JF103JY	RES 0402 10KOHM 5% 1/16W SMD	P	AA
R 2729	VRS-CZ1JF103JY	RES 0402 10KOHM 5% 1/16W SMD	P	AA
R 2730	VRS-CZ1JF104JY	RES 0402 100KOHM 5% 1/16W SMD	P	AA
R 2731	VRS-CZ1JF472JY	RES 0402 4.7KOHM 5% 1/16W SMD	P	AA

REF No.	PARTS	DESCRIPTION	*	PRICE CODE
R 2732	VRS-CZ1JF102JY	RES 0402 1KOHM 5% 1/16W SMD	P	AA
R 2733	VRS-CZ1JF103JY	RES 0402 10KOHM 5% 1/16W SMD	P	AA
R 2734	VRS-CZ1JF6R2JY	RES 0402 6.2 OHM 5% 1/16W SMD	P	AA
R 2735	VRS-CZ1JF6R2JY	RES 0402 6.2 OHM 5% 1/16W SMD	P	AA
R 2736	VRS-CZ1JF101JY	RES 0402 100 OHM 5% 1/16W SMD	P	AA
R 2737	VRS-CZ1JF6R2JY	RES 0402 6.2 OHM 5% 1/16W SMD	P	AA
R 2738	VRS-CZ1JF6R2JY	RES 0402 6.2 OHM 5% 1/16W SMD	P	AA
R 2740	VRS-CZ1JF102JY	RES 0402 1KOHM 5% 1/16W SMD	P	AA
R 2741	VRS-CZ1JF103JY	RES 0402 10KOHM 5% 1/16W SMD	P	AA
R 2742	VRS-CZ1JF103JY	RES 0402 10KOHM 5% 1/16W SMD	P	AA
R 3301	VRS-CZ1JF101JY	RES 0402 100 OHM 5% 1/16W SMD	P	AA
R 3302	VRS-CZ1JF683JY	RES 0402 68K OHM 5% 1/16W SMD	P	AA
R 3303	VRS-CZ1JF912FY	RES 0402 9.1KOHM 1% 1/16W SMD	P	AA
R 3305	VRS-CZ1JF472JY	RES 0402 4.7KOHM 5% 1/16W SMD	P	AA
R 3306	VRS-CZ1JF100JY	RES 0402 10 OHM 5% 1/16W SMD	P	AA
R 3307	VRS-CZ1JF510JY	RES 0402 51 OHM 5% 1/16W SMD	P	AA
R 3308	VRS-CZ1JF103JY	RES 0402 10KOHM 5% 1/16W SMD	P	AA
R 3309	VRS-CZ1JF202JY	RES 0402 2KOHM 5% 1/16W SMD	P	AA
R 3310	VRS-CZ1JF102JY	RES 0402 1KOHM 5% 1/16W SMD	P	AA
R 3311	VRS-CZ1JF102JY	RES 0402 1KOHM 5% 1/16W SMD	P	AA
R 3313	VRS-CZ1JF100JY	RES 0402 10 OHM 5% 1/16W SMD	P	AA
R 3316	VRS-CZ1JF101JY	RES 0402 100 OHM 5% 1/16W SMD	P	AA
R 3317	VRS-CZ1JF102JY	RES 0402 1KOHM 5% 1/16W SMD	P	AA
R 3318	VRS-CZ1JF102JY	RES 0402 1KOHM 5% 1/16W SMD	P	AA
R 3320	VRS-CZ1JF472JY	RES 0402 4.7KOHM 5% 1/16W SMD	P	AA
R 3321	VRS-CZ1JF101JY	RES 0402 100 OHM 5% 1/16W SMD	P	AA
R 3322	VRS-CZ1JF102JY	RES 0402 1KOHM 5% 1/16W SMD	P	AA
R 3323	VRS-CZ1JF472JY	RES 0402 4.7KOHM 5% 1/16W SMD	P	AA
R 3324	VRS-CZ1JF391FY	RES 0402 390 OHM 1% 1/16W SMD	P	AA
R 3325	VRS-CZ1JF430FY	RES 0402 43 OHM 1% 1/16W SMD	P	AA
R 3326	VRS-CZ1JF472JY	RES 0402 4.7KOHM 5% 1/16W SMD	P	AA
R 3327	VRS-CZ1JF472JY	RES 0402 4.7KOHM 5% 1/16W SMD	P	AA
R 3328	VRS-CZ1JF101JY	RES 0402 100 OHM 5% 1/16W SMD	P	AA
R 3329	VRS-CZ1JF101JY	RES 0402 100 OHM 5% 1/16W SMD	P	AA
R 3330	VRS-CZ1JF101FY	RES 0402 100 OHM 1% 1/16W SMD	P	AA
R 3331	VRS-CZ1JF101FY	RES 0402 100 OHM 1% 1/16W SMD	P	AA
R 3332	VRS-CZ1JF101FY	RES 0402 100 OHM 1% 1/16W SMD	P	AA
R 3333	VRS-CZ1JF101FY	RES 0402 100 OHM 1% 1/16W SMD	P	AA
R 3334	VRS-CZ1JF620JY	RES 0402 62 OHM 5% 1/16W SMD	P	AA
R 3336	VRS-CZ1JF151JY	RES 0402 150 OHM 5% 1/16W SMD	P	AA
R 3337	VRS-CZ1JF472JY	RES 0402 4.7KOHM 5% 1/16W SMD	P	AA
R 3338	VRS-CZ1JF472JY	RES 0402 4.7KOHM 5% 1/16W SMD	P	AA
R 3339	VRS-CZ1JF472JY	RES 0402 4.7KOHM 5% 1/16W SMD	P	AA
R 3340	VRS-CZ1JF102JY	RES 0402 1KOHM 5% 1/16W SMD	P	AA
R 3341	VRS-CZ1JF620JY	RES 0402 62 OHM 5% 1/16W SMD	P	AA
R 3342	VRS-CZ1JF472JY	RES 0402 4.7KOHM 5% 1/16W SMD	P	AA
R 3343	VRS-CZ1JF472JY	RES 0402 4.7KOHM 5% 1/16W SMD	P	AA
R 3351	VRS-CZ1JF101JY	RES 0402 100 OHM 5% 1/16W SMD	P	AA
R 3352	VRS-CZ1JF101JY	RES 0402 100 OHM 5% 1/16W SMD	P	AA
R 3355	VRS-CZ1JF302FY	RES 0402 3 KOHM 1% 1/16W SMD	P	AA
R 3356	VRS-CZ1JB2870FT	RES 0402 287 OHM 1% 1/16W SMD	P	AA
R 3357	VRS-CZ1JF750JY	RES 0402 75 OHM 5% 1/16W SMD	P	AA
R 3358	VRS-CZ1JF750JY	RES 0402 75 OHM 5% 1/16W SMD	P	AA
R 3359	VRS-CZ1JF750JY	RES 0402 75 OHM 5% 1/16W SMD	P	AA
R 3360	VRS-CZ1JF472JY	RES 0402 4.7KOHM 5% 1/16W SMD	P	AA
R 3361	VRS-CZ1JF472JY	RES 0402 4.7KOHM 5% 1/16W SMD	P	AA
R 3362	VRS-CZ1JF472JY	RES 0402 4.7KOHM 5% 1/16W SMD	P	AA
R 3363	VRS-CZ1JF472JY	RES 0402 4.7KOHM 5% 1/16W SMD	P	AA
R 3365	VRS-CZ1JF750JY	RES 0402 75 OHM 5% 1/16W SMD	P	AA
R 3402	VRS-CZ1JF220JY	RES 0402 22 OHM 5% 1/16W SMD	P	AA
R 3403	VRS-CZ1JF102JY	RES 0402 1KOHM 5% 1/16W SMD	P	AA
R 3404	VRS-CZ1JF102JY	RES 0402 1KOHM 5% 1/16W SMD	P	AA
R 3405	VRS-CZ1JB9091FT	RES 0402 9K09 OHM 1% 1/16W SMD	P	AA
R 3410	VRS-CZ1JF182JY	RES 0402 1.8KOHM 5% 1/16W SMD	P	AA
R 3411	VRS-CZ1JF102JY	RES 0402 1KOHM 5% 1/16W SMD	P	AA
R 3412	VRS-CZ1JF272JY	RES 0402 2.7KOHM 5% 1/16W SMD	P	AA
R 3413	VRS-CZ1JF103JY	RES 0402 10KOHM 5% 1/16W SMD	P	AA
R 3414	VRS-TQ2EF101JY	RES OX 100 OHM 5% 1/4W SMD	P	AA
R 3415	VRS-CZ1JB3012FT	RES 0402 30K1 OHM 1% 1/16W SMD	P	AA
R 3501	VRS-CZ1JF560JY	RES 0402 56 OHM 5% 1/16W SMD	P	AA
R 3502	VRS-CZ1JF560JY	RES 0402 56 OHM 5% 1/16W SMD	P	AA
R 3503	VRS-CZ1JF560JY	RES 0402 56 OHM 5% 1/16W SMD	P	AA
R 3504	VRS-CZ1JF560JY	RES 0402 56 OHM 5% 1/16W SMD	P	AA





REF No.	PARTS	DESCRIPTION	*	PRICE CODE
R 9566	VRS-CZ1JF103JY	RES 0402 10KOHM 5% 1/16W SMD	P	AA
R 9567	VRS-CZ1JF103JY	RES 0402 10KOHM 5% 1/16W SMD	P	AA
R 9568	VRS-CZ1JF103FY	RES 0402 10KOHM 1% 1/16W SMD	P	AA
R 9569	VRS-CZ1JF103JY	RES 0402 10KOHM 5% 1/16W SMD	P	AA
R 9570	VRS-CZ1JF104JY	RES 0402 100KOHM 5% 1/16W SMD	P	AA
R 9571	VRS-CZ1JF103JY	RES 0402 10KOHM 5% 1/16W SMD	P	AA
R 9573	VRS-CZ1JF104JY	RES 0402 100KOHM 5% 1/16W SMD	P	AA
R 9607	VRS-CZ1JF220JY	RES 0402 22 OHM 5% 1/16W SMD	P	AA
R 9608	VRS-CZ1JF472JY	RES 0402 4.7KOHM 5% 1/16W SMD	P	AA
R 9609	VRS-CZ1JF331JY	RES 0402 330 OHM 5% 1/16W SMD	P	AA
R 9610	VRS-CZ1JF103JY	RES 0402 10KOHM 5% 1/16W SMD	P	AA
R 9611	VRS-CZ1JF000JY	RES 0402 0 OHM 5% 1/16W SMD	P	AA
R 9612	VRS-CZ1JF000JY	RES 0402 0 OHM 5% 1/16W SMD	P	AA
R 9613	VRS-CZ1JF102FY	RES 0402 1KOHM 1% 1/16W SMD	P	AA
R 9615	VRS-CZ1JF000JY	RES 0402 0 OHM 5% 1/16W SMD	P	AA
R 9616	VRS-CZ1JF332FY	RES 0402 3.3KOHM 1% 1/16W SMD	P	AA
R 9617	VRS-CZ1JF242JY	RES 0402 2.4KOHM 5% 1/16W SMD	P	AA
R 9618	VRS-CZ1JF153FY	RES 0402 15KOHM 1% 1/16W SMD	P	AA
R 9619	VRS-CZ1JF220JY	RES 0402 22 OHM 5% 1/16W SMD	P	AA
R 9620	VRS-CZ1JF000JY	RES 0402 0 OHM 5% 1/16W SMD	P	AA
R 9621	VRS-CZ1JF103JY	RES 0402 10KOHM 5% 1/16W SMD	P	AA
R 9622	VRS-CZ1JF183FY	RES 0402 18KOHM 1% 1/16W SMD	P	AA
R 9623	VRS-CZ1JF393FY	RES 0402 39KOHM 1% 1/16W SMD	P	AA
R 9624	VRS-CZ1JF561JY	RES 0402 560 OHM 5% 1/16W SMD	P	AA
R 9625	VRS-CZ1JF102JY	RES 0402 1KOHM 5% 1/16W SMD	P	AA
R 9627	VRS-CZ1JF132FY	RES 0402 1.3KOHM 1% 1/16W SMD	P	AA
R 9628	VRS-CZ1JF102FY	RES 0402 1KOHM 1% 1/16W SMD	P	AA
R 9629	VRS-CZ1JF103JY	RES 0402 10KOHM 5% 1/16W SMD	P	AA
R 9630	VRS-CZ1JF103JY	RES 0402 10KOHM 5% 1/16W SMD	P	AA
R 9631	VRS-CZ1JF104JY	RES 0402 100KOHM 5% 1/16W SMD	P	AA
R 9632	VRS-CZ1JF103JY	RES 0402 10KOHM 5% 1/16W SMD	P	AA
R 9633	VRS-CZ1JF103JY	RES 0402 10KOHM 5% 1/16W SMD	P	AA
R 9634	VRS-CZ1JF000JY	RES 0402 0 OHM 5% 1/16W SMD	P	AA
R 9635	VRS-CZ1JF103JY	RES 0402 10KOHM 5% 1/16W SMD	P	AA
R 9636	VRS-CZ1JF103JY	RES 0402 10KOHM 5% 1/16W SMD	P	AA
R 9637	VRS-CZ1JF000JY	RES 0402 0 OHM 5% 1/16W SMD	P	AA
R 9638	VRS-CZ1JF000JY	RES 0402 0 OHM 5% 1/16W SMD	P	AA
R 9639	VRS-CZ1JF103JY	RES 0402 10KOHM 5% 1/16W SMD	P	AA
R 9640	VRS-CZ1JF000JY	RES 0402 0 OHM 5% 1/16W SMD	P	AA
R 9643	VRS-CZ1JF000JY	RES 0402 0 OHM 5% 1/16W SMD	P	AA
R 9644	VRS-CZ1JF471JY	RES 0402 470 OHM 5% 1/16W SMD	P	AA
R 9645	VRS-CZ1JF471JY	RES 0402 470 OHM 5% 1/16W SMD	P	AA
R 9646	VRS-CZ1JF101JY	RES 0402 100 OHM 5% 1/16W SMD	P	AA
R 9647	VRS-CZ1JF101JY	RES 0402 100 OHM 5% 1/16W SMD	P	AA
R 9649	VRS-CZ1JF101JY	RES 0402 100 OHM 5% 1/16W SMD	P	AA
R 9650	VRS-CZ1JF102JY	RES 0402 1KOHM 5% 1/16W SMD	P	AA
R 9652	VRS-CZ1JF182FY	RES 0402 1.8KOHM 1% 1/16W SMD	P	AA
R 9653	VRS-CZ1JF102FY	RES 0402 1KOHM 1% 1/16W SMD	P	AA
R 9657	VRS-CZ1JF000JY	RES 0402 0 OHM 5% 1/16W SMD	P	AA
R 9660	VRS-CZ1JF223JY	RES 0402 22KOHM 5% 1/16W SMD	P	AA
R 9661	VRS-CZ1JF682JY	RES 0402 6.8KOHM 5% 1/16W SMD	P	AA
R 9701	VRS-CZ1JF000JY	RES 0402 0 OHM 5% 1/16W SMD	P	AA
R 9702	VRS-CZ1JF181JY	RES 0402 180 OHM 5% 1/16W SMD	P	AA
R 9703	VRS-CZ1JF103JY	RES 0402 10KOHM 5% 1/16W SMD	P	AA
R 9704	VRS-CZ1JF332FY	RES 0402 3.3KOHM 1% 1/16W SMD	P	AA
R 9705	VRS-CZ1JF392JY	RES 0402 3.9KOHM 5% 1/16W SMD	P	AA
R 9706	VRS-CZ1JF153FY	RES 0402 15KOHM 1% 1/16W SMD	P	AA
R 9707	VRS-CZ1JF103JY	RES 0402 10KOHM 5% 1/16W SMD	P	AA
R 9708	VRS-CZ1JF620FY	RES 0402 62 OHM 1% 1/16W SMD	P	AA
R 9709	VRS-CZ1JF101JY	RES 0402 100 OHM 5% 1/16W SMD	P	AA
<b>TRANSFORMER</b>				
T 9501	RTRNZ129WJQZY	TRANSFORMER TLA-6T214ALF(-T)	P	AG
<b>MISCELLANEOUS PARTS</b>				
J 0502	QJAKEA073WJZZ	JACK LGY6502-0800F	P	AD
J 0551	QJAKJA024WJZZ	HEADPHONE CKX-035-347DBZ	P	AB
J 0552	QJAKLA037WJQZ	JACK RCA-639HA-00A-09	P	AE
J 2701	QJAKJ0101SEZZ	JACK MINIATURE PHONE MORNING STAR	P	AB
J 9501	QJAKZA105WJQZQ	JACK GCR15-N3-080A100 TRAY	P	AF
J 9551	QSOCZA278WJQZ	SOCKET USB DOUBLE UAR64	P	AE
J 9552	QSOCZA205WJQZ	SOCKET UAR27-4K5COL	P	AC
P 2701	QPLGNA160WJZZY	CONNECTOR SM04B-PASS-TBT(LF)	P	AD

REF No.	PARTS	DESCRIPTION	*	PRICE CODE
P 2702	QPLGNA158WJZZY	CONNECTOR SM02B-PASS-TBT (LF)(SN)	P	AC
P 3401	QPLGNB077WJZZY	CONNECTOR A1251WRO-8PS-5E JWT	P	AC
P 9601	QPLGN0186FJZZY	CONNECTOR S14B-PH-SM4-TB	P	AE
SC 0501	QSOCNA229WJZZ	CONNECTOR DHR20-151F200/H-DBR10-A0020D	P	AE
SC 0552	QSOCZA161WJZZ	SCART RGB-11H	P	--
SC 1501	QSOCZA175WJZZY	CONNECTOR HDMI A111924-A-15-R	P	AE
SC 1502	QSOCZA264WJQZY	CONNECTOR HDMI CSS5019-0731E	P	AH
SC 1503	QSOCZA264WJQZY	CONNECTOR HDMI CSS5019-0731E	P	AH
SC 1504	QSOCZA264WJQZY	CONNECTOR HDMI CSS5019-0731E	P	AH
SC 2601	QCNCWA995WJZZY	CONNECTOR LVDS 51 PINS P-TWO 187059-51221	P	AF
SC 2603	QCNCWB015WJZZY	CONNECTOR LVDS 41 PINS P-TWO 187060-41221	P	AE
SC 4401	QCNCMA340WJSA	C.I.CARD SLOT ICMG68H-DS111NF(LF)(SN)JST	P	AK

### CABINET AND MECHANICAL PARTS 40"

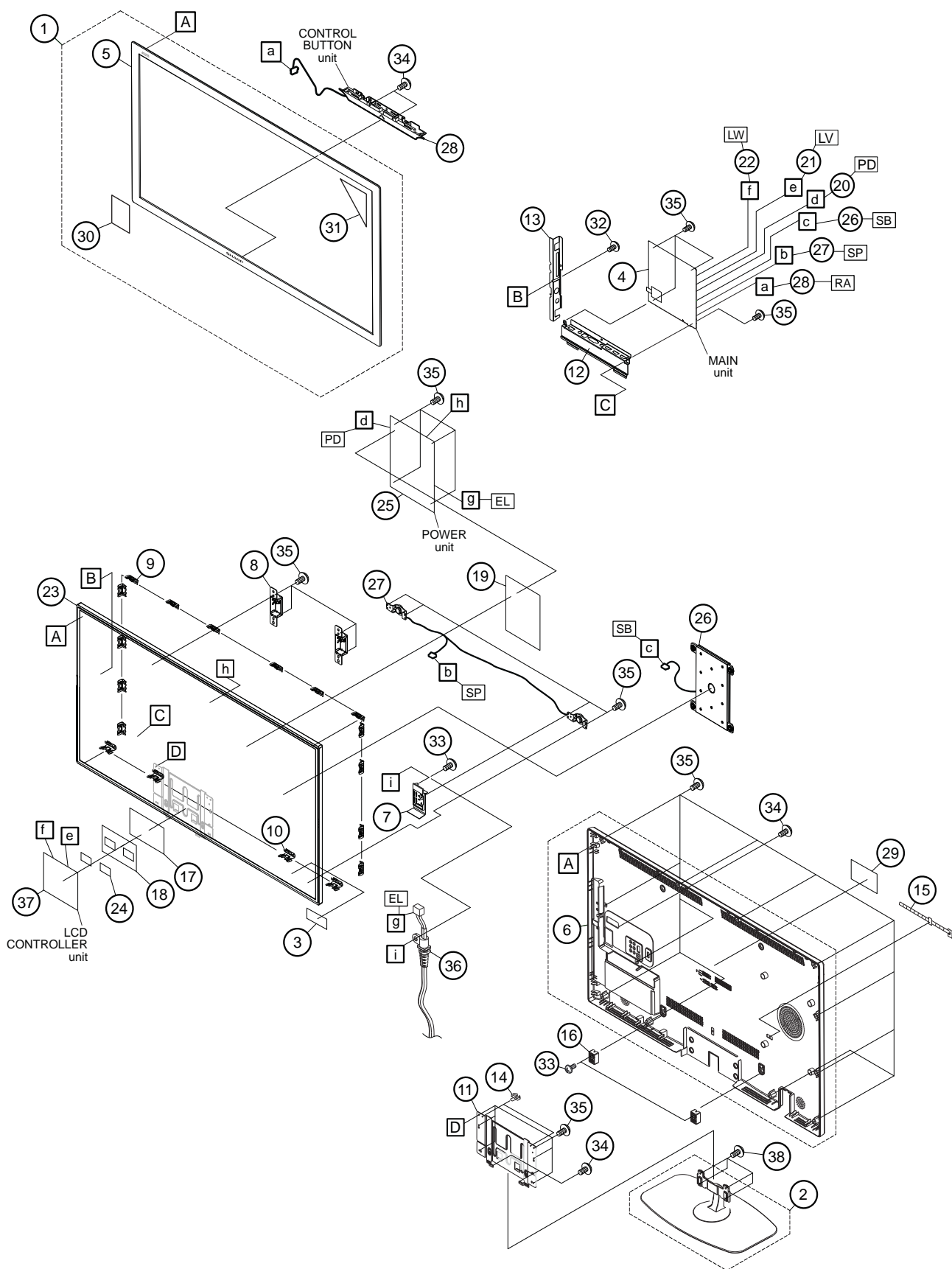

# CABINET AND MECHANICAL PARTS 46"

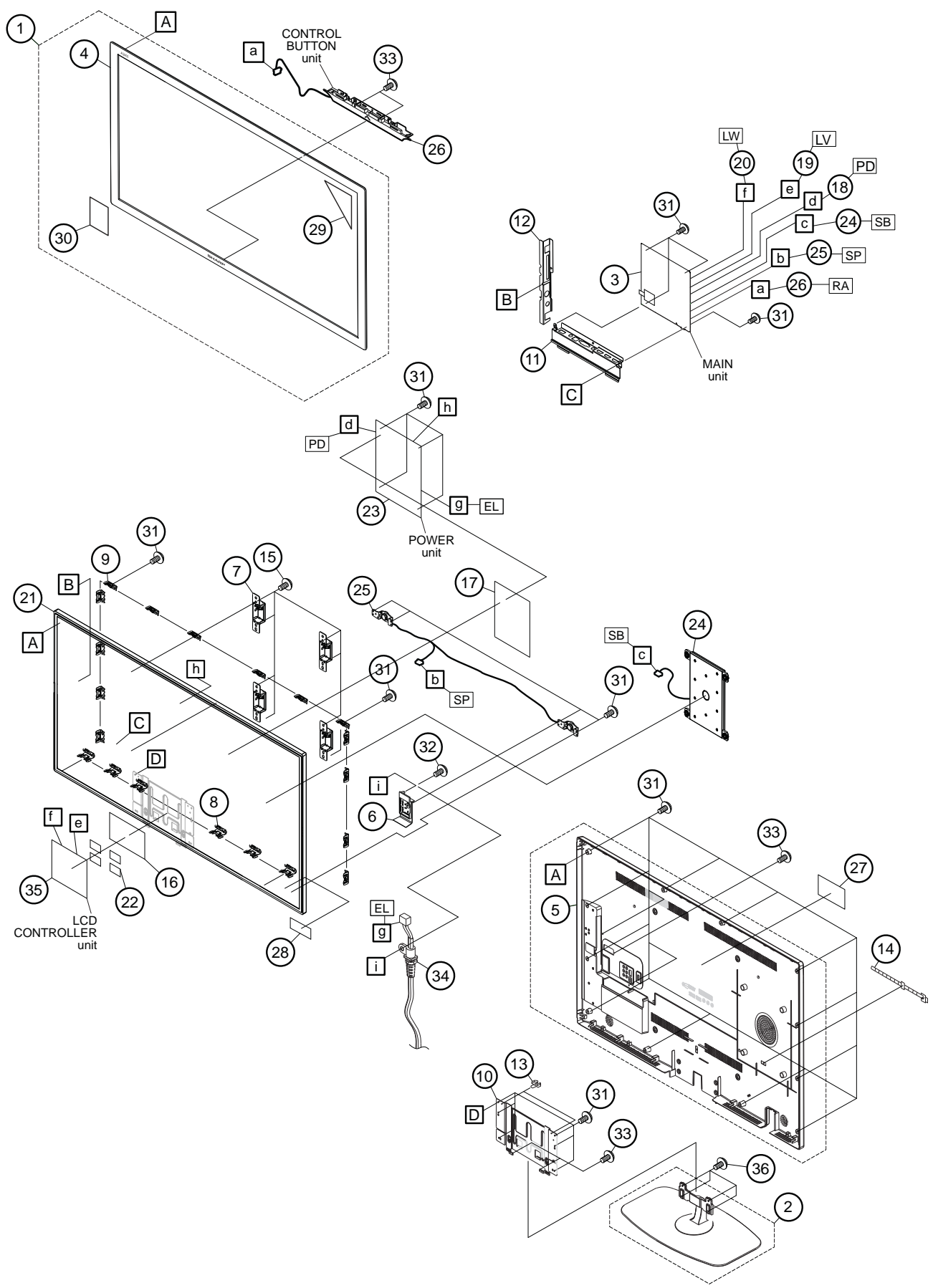

**40" CABINET AND MECHANICAL PART LISTING**

REF No.	PARTS	DESCRIPTION	*	PRICE CODE
1	CCABAC762WJ01	KS-CAB-A LC40LE63*E/730E	P	BA
2	CDAI-A804WJ01	KS-STAND LC40LE730E	P	BE
3	TLABZC453WJZZ	PANEL LABEL	P	AA
4	DUNTKF915FM02	ADJUST MAIN UNIT LE730	P	CC
5	GCABAC762WJ1A	FRONT CABINET	P	--
6	GCABBB993WJ1A	REAR CABINET	P	BH
7	GCOVAE259WJ1A	AC HOLDER BRACKET POWER SWITCH	P	--
8	LANGKD343WJFW	VESA BRACKET	P	AK
9	LANGKD368WJFW	PANEL BRACKET HOLDER (TOP AND SIDE)	P	BB
10	LANGKD369WJFW	PANEL BRACKET HOLDER BOTTOM	P	BC
11	LANGKD370WJFW	STAND BRACKET	P	BG
12	LANGKD378WJFW	TERMINAL COVER BOTTOM	P	AH
13	LANGKD379WJFW	TERMINAL COVER SIDE	P	AH
14	LHLDWA048WJKZ	BRIDA CABLE	P	AA
15	LHLDWA303WJKA	WIRE HOLDER	P	AC
16	LHLDZA929WJZZ	HOLDER	P	AE
17	PZETKA640WJZZ	INSULATION SHEET FOR CONTROLLER PWB	P	AG
18	PZETKA641WJZZ	INSULATION SHEET FOR PANEL	P	AF
19	PZETKA645WJKZ	INSULATION SHEET POWER	P	AM
20	QCNW-M004WJQZ	CABLE (PD)	P	AK
21	QCNW-M251WJQZ	CABLE (LV) 51PINS	P	AQ
22	QCNW-M252WJQZ	CABLE (LW) 41PINS	P	AQ
23	R1LK400D3LB43P	40" LCD MODULE LK400D3LB43P	P	DG
24	RCORFA061WJZZ	FERRITE CORE/CS-FPC E04FG460812-T	P	--
△	RDENCA440WJQZ	POWER WITH LED DRIVER 40" LE730	P	BN
26	RSP-ZA549WJZZ	SPEAKER 6 OHM 12W FULL RANGE	P	BA
27	RSP-ZA550WJZZ	SPEAKER 2x4 OHM 5W TWEETER	P	AU
28	RUNTKA880WJPA2	CONTROL BUTTON UNIT LE730E BLACK	P	BC
29	TLABNC117WJZZ	ETIQUETA MODELO 3M 7291 ADHESIVO AP-360	P	AA
30	TLABZC949WJZZ	CE ENERGY LABEL	P	AH
31	TLABZC950WJZZ	POP LABEL	P	--
32	XBPS730P06000	SCREW PAN ST ZN M3x6	P	AA
33	XEPS730P08WS0	SCREW PAN ST ZN 3x8	P	AA
34	XEPS730P12WS0	SCREW PAN ST ZN 3x12	P	AA
35	QACCKA058WJPZ	AC CORD LE730	P	AQ
36	RUNTK4593TPZU	LCD CONTROLER UNIT	P	BQ
37	LX-BZA429WJF8	STAND SCREW M4x10 BK (CSAKAA186WJ01)	P	--

**46" CABINET AND MECHANICAL PART LISTING**

REF No.	PARTS	DESCRIPTION	*	PRICE CODE
1	CCABAC769WJ01	KS-CAB-A LC46LE63*E	P	BD
2	CDAI-A805WJ01	KS-STAND LC46LE730E	P	BE
3	DUNTKF915FM02	ADJUST MAIN UNIT LE730	P	CC
4	GCABAC769WJ1A	FRONT CABINET	P	BD
5	GCABBB994WJ1A	REAR CABINET	P	BN
6	GCOVAE259WJ1A	AC HOLDER BRACKET POWER SWITCH	P	--
7	LANGKD343WJFW	VESA BRACKET	P	AK
8	LANGKD369WJFW	PANEL BRACKET HOLDER BOTTOM	P	BC
9	LANGKD373WJFW	PANEL BRACKET HOLDER TOP	P	--
10	LANGKD375WJFW	STAND BRACKET	P	--
11	LANGKD378WJFW	TERMINAL COVER BOTTOM	P	AH
12	LANGKD405WJFW	TERMINAL COVER SIDE	P	--
13	LHLDWA048WJKZ	BRIDA CABLE	P	AA
14	LHLDWA303WJKA	WIRE HOLDER	P	AC
15	LX-BZA425WJF7	SCREW WASHER M4x 8 mm. (Silver)	P	AA
16	PZETKA640WJZZ	INSULATION SHEET FOR CONTROLLER PWB	P	--
17	PZETKA645WJKZ	INSULATION SHEET POWER	P	AM
18	QCNW-M004WJQZ	CABLE (PD)	P	AK
19	QCNW-M365WJQZ	CABLE (LV) 51 PINS	P	AR
20	QCNW-M367WJQZ	CABLE (LW) 41 PINS	P	AQ
21	R1LK460D3LB33P	46" LCD MODULE LK460D3LB33P	P	DQ
22	RCORFA061WJZZ	FERRITE CORE/CS-FPC E04FG460812-T	P	--
△	RDENCA440WJQZ	POWER WITH LED DRIVER 40" LE730	P	BN
24	RSP-ZA549WJZZ	SPEAKER 6 OHM 12W FULL RANGE	P	BA
25	RSP-ZA550WJZZ	SPEAKER 2x4 OHM 5W TWEETER	P	AU
26	RUNTKA880WJPA2	CONTROL BUTTON UNIT LE730E BLACK	P	BC
27	TLABNC117WJZZ	ETIQUETA MODELO 3M 7291 ADHESIVO AP-360	P	AA
28	TLABZC453WJZZ	PANEL LABEL	P	AA
29	TLABZC950WJZZ	POP LABEL	P	--
30	TLABZD041WJZZ	CE ENERGY LABEL	P	AH
31	XBPS730P06WS0	SCREW PAN ST ZN M3x6	P	AA
32	XEPS730P08WS0	SCREW PAN ST ZN 3x8	P	AA
33	XEPS730P12WS0	SCREW PAN ST ZN 3x12	P	AA
34	QACCKA058WJPZ	AC CORD LE730	P	AQ
35	RUNTK4593TPZV	LCD CONTROLER UNIT	P	BQ
36	LX-BZA429WJF8	STAND SCREW M4x10 BK (CSAKAA186WJ01)	P	--

## Supplied accessories

Remote control unit  
(× 1)

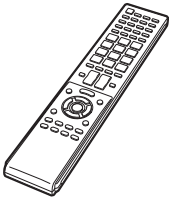

• “AAA” size battery (× 2)



• Operation manual (This publication)

• Cable tie (x1)



• Stand unit (x1)

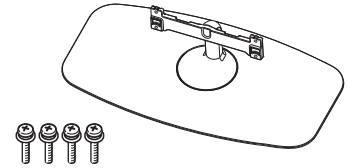

REF No.	PARTS	DESCRIPTION	*	PRICE CODE
<b>ACCESSORIES PARTS LISTING</b>				
REF No.	PARTS	DESCRIPTION	*	PRICE CODE
	LHLDWA303WJKA	WIRE HOLDER	P	AC
	RRMCGA983WJSA	REMOTE CONTROL LE730E	P	AX
	TINS-F204WJZZ	OWNERS MANUAL LE730E	P	AD
	TINS-F332WJZZ	OWNERS MANUAL LE730RU (1 LANGUAGE)	P	--
	TINS-F333WJZZ	OWNERS MANUAL LE730EV (16 LANGUAGES)	P	--
	UBATUA024WJZZ	BATERIA R03NWC/2SKD x2	P	--
<b>40" PACKING PARTS LISTING</b>				
REF No.	PARTS	DESCRIPTION	*	PRICE CODE
	SPAKCG414WJZZ	PACKING CASE LC40LE730E	P	AT
	SPAKPB475WJZZ	PE BAG 40"	P	AE
	SPAKXD432WJZZ	PACKING FOAM TOP 40"	P	AL
	SPAKXD506WJZZ	PACKING FOAM BOTTOM 40"	P	AN
<b>46" PACKING PARTS LISTING</b>				
REF No.	PARTS	DESCRIPTION	*	PRICE CODE
	SPAKFC164WJZZ	CARDBOARD MIDDLE 46LE730EE	P	AD
	SPAKPB477WJZZ	P_BAG / HOSSO-PP FOR 46	P	AF
	SPAKXD503WJZZ	PACKING FOAM TOP 46"	P	AQ
	SPAKXD504WJZZ	PACKING FOAM BOTTOM 46"	P	AP
	SPAKCG517WJZZ	PACKING CASE LC46LE730E	P	--
	SPAKCG518WJZZ	BOTTOM CASE LC46LE730E	P	AL
<b>40" LCD PANEL LK400D3LB43P PARTS LISTING</b>				
REF No.	PARTS	DESCRIPTION	*	PRICE CODE
	CANGK4919TP01	BEZEL UNIT	P	AN
	CANGK4920TP01	BEZEL UNIT	P	AQ
	CANGK4921TP01	BEZEL UNIT	P	AH
	CCOVP2987TP01	M_COVER / C-PWB	P	AK
	CHLDZ4763TP01	P CHASSIS UNIT	P	AN
	CHLDZ4764TP01	P CHASSIS UNIT	P	AR
	CHLDZ4765TP01	P CHASSIS UNIT	P	AK
	CHLDZ4766TP01	P CHASSIS UNIT	P	AK
	DSETB0002TPZZ	DIFFUSION SHEET UNIT	P	AP
	PREFL3303TPZZ	REFLECTION SHEET	P	AN

REF No.	PARTS	DESCRIPTION	*	PRICE CODE
	PSLDK3570TPZZ	DIFFUSION SHEET	P	AV
	CANGT0330TP01	INSTALLATION ANGLE UNIT	P	AW
	LX-HZ2413TPZZ	SCREW	P	AA
	LX-HZ2414TPZZ	SCREW	P	AA
	PCOVP2989TPZZ	P_COVER	P	AC
	QCNWN2665TPZZ	WIRE / LED CONNECTION CABLE	P	AT
	RUNTK5012TPZZ	LED-PWB	P	AZ
	CHLDZ4780TP02	HOLDER UNIT	P	AK
	LX-BZ2568TPZZ	SCREW	P	AA
	LX-BZ2569TPZZ	SCREW	P	AA
	LX-HZ2418TPZZ	SCREW	P	AA
	LX-UZ2067TPZZ	SCREW	P	AA
	PLGPA0791TPZZ	LIGHT GUIDE PLATE	P	BL
	POFMA1185TPZZ	LENS SHEET	P	AW
	POFMA1267TPZZ	LENS SHEET	P	AW
	PREFL3263TPZZ	REFLECTION SHEET	P	AX
	PSLDK3629TPZZ	DIFFUSION SHEET	P	AV
	QCNWN2722TPZZ	CS-FFC	P	AF
	RUNTK4593TPZU	C-PWB	P	BQ
<b>46" LCD PANEL LK460D3LB33P PARTS LISTING</b>				
REF No.	PARTS	DESCRIPTION	*	PRICE CODE
	CANGK4930TP01	BEZEL UNIT	P	AP
	CANGK4931TP01	BEZEL UNIT	P	AT
	CANGK4932TP01	BEZEL UNIT	P	AK
	CCOVP2987TP01	M_COVER / C-PWB	P	AK
	CHLDZ4784TP01	P CHASSIS UNIT	P	AP
	CHLDZ4785TP01	P CHASSIS UNIT	P	AP
	CHLDZ4786TP01	P CHASSIS UNIT	P	AM
	CHLDZ4787TP01	P CHASSIS UNIT	P	AM
	LX-HZ2413TPZZ	SCREW	P	AA
	LX-HZ2414TPZZ	SCREW	P	AA
	PCOVP2989TPZZ	P_COVER	P	AC
	QCNWN2667TPZZ	WIRE / LED CONNECTION CABLE	P	AT
	RUNTK5050TPZZ	LED-PWB	P	BB
	CHLDZ4792TP02	HOLDER UNIT	P	AL
	LX-BZ2568TPZZ	SCREW	P	AA
	LX-BZ2569TPZZ	SCREW	P	AA
	LX-HZ2418TPZZ	SCREW	P	AA
	LX-UZ2067TPZZ	SCREW	P	AA
	PLGPA0792TPZZ	LIGHT GUIDE PLATE	P	BP
	POFMA1186TPZZ	LENS SHEET	P	AY
	POFMA1262TPZZ	LENS SHEET	P	AX
	PREFL3264TPZZ	REFLECTION SHEET	P	AZ
	PSHEG0307TPZZ	HEAT RADIATION SHEET	P	AF
	PSHEG0308TPZZ	HEAT RADIATION SHEET	P	AC
	PSHEG0309TPZZ	HEAT RADIATION SHEET	P	AD
	PSLDK3609TPZZ	MICROLENS SHEET	P	BB
	PSLDK3632TPZZ	DIFFUSION SHEET	P	AY
	QCNWN2722TPZZ	CS-FFC	P	AE
	RUNTK4593TPZV	C-PWB	P	BQ

# PACKING OF THE SET 40"

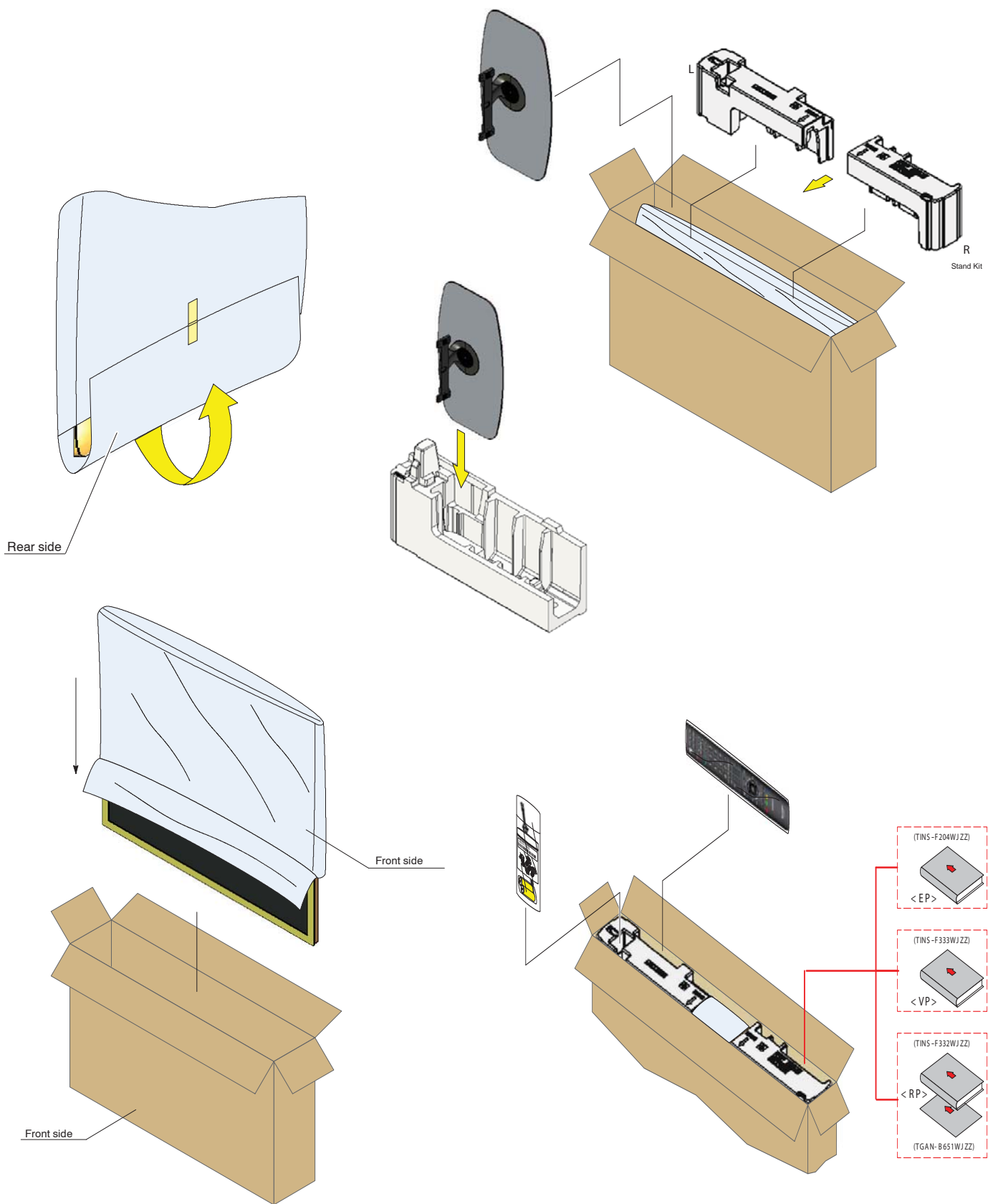

# PACKING OF THE SET 46"

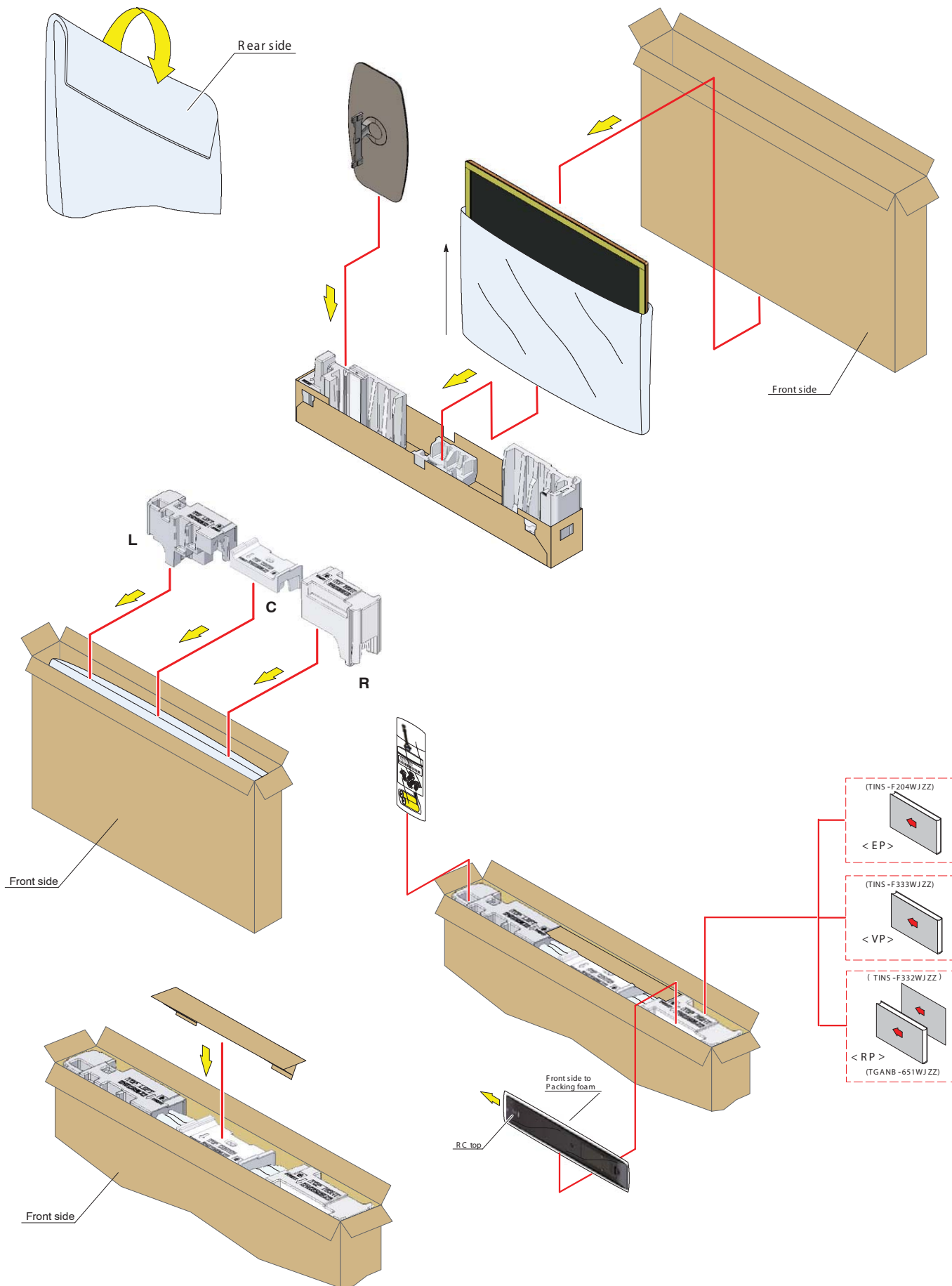

**NOTES.**



# SHARP®

**COPYRIGHT © 2011 BY SHARP CORPORATION**

ALL RIGHTS RESERVED

No part of this publication may be reproduced, stored in a retrieval system, or transmitted in any form or by any means, electronic, mechanical, photocopying, recording, or otherwise, without prior written permission of the publisher.

**SHARP CORPORATION**  
AV System Group

**SHARP ELECTRONICA ESPAÑA S.A.**  
Service Manual Group  
Engineering Dept.  
C/ Sena, 2-10  
08174 Sant Cugat del Vallès  
Barcelona  
Spain