

4-2. CHASSIS SECTION

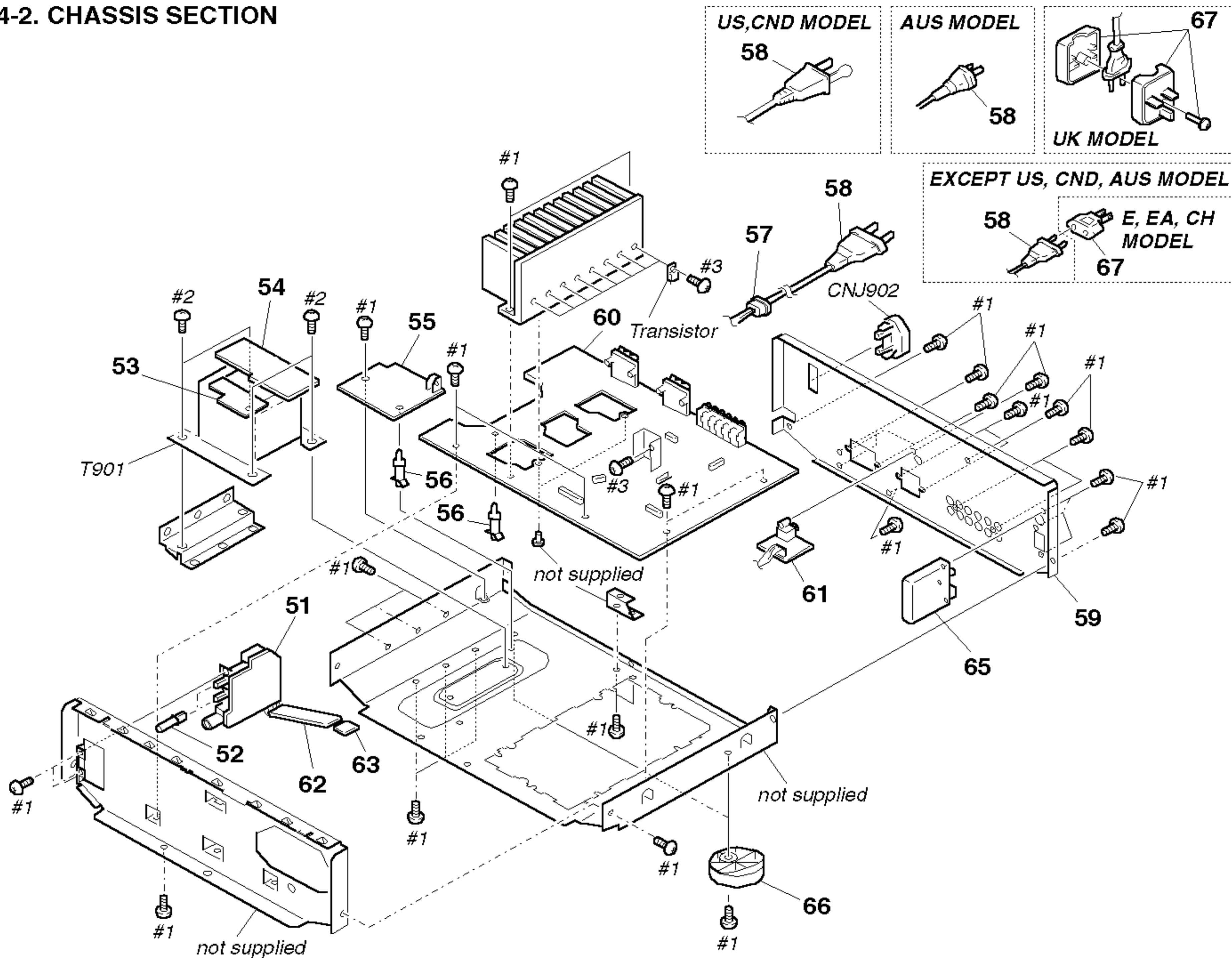

Ref. No.	Part No.	Description	Remarks	Ref. No.	Part No.	Description	Remarks
* 51	1-669-270-11	SP-SW BOARD		* 60	A-4407-529-A	MAIN BOARD, COMPLETE (DE325:AEP,G,EE)	
* 52	4-951-801-03	BUTTON (S)		* 61	1-669-273-11	MIX-OUT BOARD	
* 53	1-669-267-11	PRIMARY BOARD		* 62	1-669-271-11	SP-SW-A BOARD	
* 54	1-669-268-11	SECONDARY BOARD		* 63	1-669-272-11	SP-SW-B BOARD	
* 55	1-669-266-11	STAND BY BOARD		* 64	1-669-269-11	VOL-SEL BOARD (DE325:E,EA,CH)	
* 56	4-954-051-51	HOLDER, PC BOARD		65	1-693-407-51	TUNER (US,CND)	
* 57	3-703-244-21	BUSHING (2104), CORD		65	1-693-408-31	TUNER (EXCEPT US,CND,EE)	
△ 58	1-777-071-21	CORD, POWER (EXCEPT US,CND,AUS)		65	1-693-411-31	TUNER (EE)	
△ 58	1-696-847-21	CORD, POWER (AUS)		66	X-4947-207-2	FOOT ASSY (F50150S) (DE225:AEP,G,EE,UK/DE325:EXCEPT US,CND)	
△ 58	1-783-204-11	CORD, POWER (US,CND)		66	X-4947-208-2	FOOT ASSY (F50150S) (DE225:CND/DE325:US,CND)	
* 59	4-998-208-11	BACK PANEL (E2) (DE225:CND)		△ 67	1-569-008-21	ADAPTOR, CONVERSION 2P (E,EA,CH)	
* 59	4-998-208-21	BACK PANEL (E2) (DE225:AEP,G,EE,UK)		△ 67	1-770-019-11	ADAPTOR, CONVERSION PLUG 3P (UK)	
* 59	4-998-209-01	BACK PANEL (E3) (DE325:US)		△ CNJ902	1-251-416-11	OUTLET, A.C.(AUS)	
* 59	4-998-209-11	BACK PANEL (E3) (DE325:CND)		△ CNJ902	1-526-794-11	OUTLET, AC (AEP,G,EE,SP,MY)	
* 59	4-998-209-41	BACK PANEL (E3) (DE325:CH)		△ T901	1-431-264-11	TRANSFORMER, POWER (DE325:CND)	
* 59	4-998-209-21	BACK PANEL (E3) (DE325:AUS)		△ T901	1-431-793-11	TRANSFORMER, POWER (DE325:US)	
* 59	4-998-209-31	BACK PANEL (E3) (DE325:SP,MY)		△ T901	1-431-794-11	TRANSFORMER, POWER (DE325:E,EA,CH)	
* 59	4-998-209-51	BACK PANEL (E3) (DE325:E,EA)		△ T901	1-431-795-11	TRANSFORMER, POWER (DE325:SP,MY)	
* 59	4-998-209-61	BACK PANEL (E3) (DE325:AEP,G)		△ T901	1-431-796-11	TRANSFORMER, POWER (DE325:AEP,G,EE)	
* 59	4-998-209-71	BACK PANEL (E3) (DE325:EE)		△ T901	1-431-798-11	TRANSFORMER, POWER (DE225:AEP,G,EE,UK)	
* 60	A-4407-425-A	MAIN BOARD, COMPLETE (DE225:CND)		△ T901	1-431-799-11	TRANSFORMER, POWER (DE225:CND)	
* 60	A-4407-448-A	MAIN BOARD, COMPLETE (DE325:US)		△ T901	1-431-818-11	TRANSFORMER, POWER (DE325:AUS)	
* 60	A-4407-512-A	MAIN BOARD, COMPLETE (DE225:AEP,G,EE,UK)					
* 60	A-4407-514-A	MAIN BOARD, COMPLETE (DE325:CND)					
* 60	A-4407-517-A	MAIN BOARD, COMPLETE (DE325:E,EA,CH,AUS,SP,MY)					

The components identified by mark △ or dotted line with mark △ are critical for safety. Replace only with part number specified.

Les composants identifiés par une marque △ sont critiques pour la sécurité. Ne les remplacer que par une pièce portant le numéro spécifié.