

# 1. Exploded View & Part List

## Exploded View

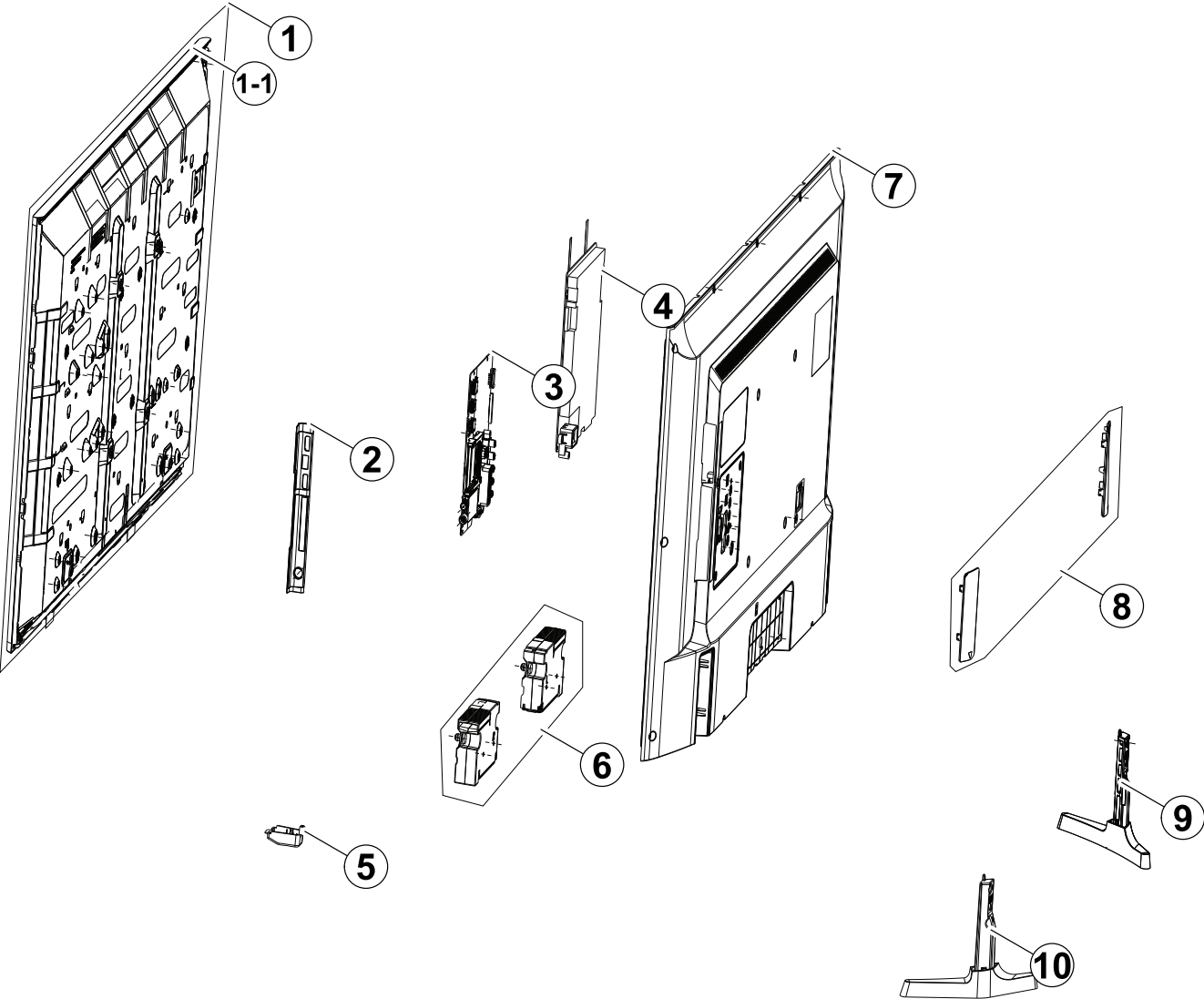

## Parts List

No.	Lvl.	Loc.	Material Code	Description & Specification	SNA	Qty.
1	2		BN95-02363B	PRODUCT LCD-BOE; CY-JJ048BGEV2V/H,J5000,H	SA	1
1-1	3	TC01A	BN96-39004A	ASSY CHASSIS TOP P; J5.2K 48,ABS+PC+MF15%	SA	1
2	3		BN61-09059A	HOLDER-SIDE AV; UF6100,HIPS,BK0020,HB,EO/	SNA	1
3	2	M0014	BN94-09511F	ASSY PCB MAIN; J5*,EU	SA	1
4	2	P001A	BN44-00852A	DC VSS-LED TV PD BD; L48MSF_FDY,L48MSF_FD	SA	1
5	2	FB05A	BN96-36076E	ASSY BOARD P; UA43J5000AWXHC_Function_Ass	SA	1
6	2	SP01A	BN96-30337C	ASSY SPEAKER P; 6ohm,4pin,10W,mega3	SA	1
7	2	R001A	BN96-38872B	ASSY COVER P-REAR; 48 J5000,PC+ABS,V1,BLK	SA	1
8	2	SG01A	BN96-37644A	ASSY GUIDE P-STAND; 48J5000,HIPS,BLACK	SA	1
9	2		BN96-39050A	ASSY STAND P-BASE (L); J5200 48,PC+ ABS,B	SA	1
10	2		BN96-39051A	ASSY STAND P-BASE (R); J5200 48,PC+ ABS,B	SA	1

## 2. Electrical Parts List

Level	Loc.	Part Code	Description & Specification	Qty.	SA/SNA
			<b>UE48J5000AWXZF (FD01)</b>		
1	S001A	BN90-06670J	ASSY STAND;UJ5000,48"	1	SNA
.2	SG01A	BN96-37644A	ASSY GUIDE P-STAND;48J5000,HIPS,BLACK	1	SA
..3		6902-000675	BAG PE;LDPE,T0.05,W200,L250,TRP,Recycle	1	SNA
..3		BN63-14240A	COVER-NECK;J5200 48",HIPS,BLACK	2	SNA
..3		BN96-18013E	ASSY ACCESSORY-SCREW;6003-001782,4EA,ALL	1	SNA
...4	SCREW	6003-001782	SCREW-TAPTYPE;BH,+,B,M4,L12,ZPC(BLK),SWR	4	SA
...4		BN69-08203E	BAG SCREW;LDPE,0.05,70,90,TRP,Vinyl pack	1	SNA
.2		BN96-39050A	ASSY STAND P-BASE (L);J5200 48,PC+ ABS,B	1	SA
..3		BN63-14388A	COVER-STAND NECK L;J5200 48INCH MINI-ARC	1	SNA
..3		BN63-14927A	COVER-STAND L;J5200 48",ABS+PC,V0,BK0007	1	SNA
.2		BN96-39051A	ASSY STAND P-BASE (R);J5200 48,PC+ ABS,B	1	SA
..3		6902-001873	BAG PE;HDPE,T0.015,W350,L300,TRP,RECYCLE	1	SNA
..3		BN63-14389A	COVER-STAND NECK R;J5200 48INCH MINI-ARC	1	SNA
...4		0103-007285	RESIN PC;HF3200H,K21294,BK0007,V2	1.5mm	110
..3		BN63-14928A	COVER-STAND R;J5200 48",ABS+PC,V0,BK0007	1	SNA
..3		BN67-00524A	RUBBER-FOOT;J4003,Silicon,12.0 X 7.0,2.	2	SNA
1	R001A	BN90-07191G	ASSY COVER REAR;JH5000,48"	1	SNA
.2	SCREW	6001-002755	SCREW-MACHINE;BH,+,M3,L6,ZPC(BLK),SWRCH1	5	SA
.2	SCREW	6003-001782	SCREW-TAPTYPE;BH,+,B,M4,L12,ZPC(BLK),SWR	14	SA
.2	R001A	BN96-38872B	ASSY COVER P-REAR;48 J5000,PC+ABS,V1,BLK	1	SA
..3	R001	BN63-14237Q	COVER-REAR;48" J5000,ABS+PC,V1,BLK,EO	1	SNA
...4		0103-005041	RESIN PC ABS;FR3200TV,901408,BK0008,1.2m	2180	SNA
..3		BN68-05603A	LABEL-E,PASS;ALL MODEL,ART PAPER 90G,60,	1	SNA
..3		BN68-07282M	LABEL-TERMINAL,SIDE;J5000/J5200,PET,T0.1	1	SNA
1		BN90-07926A	ASSY W/I;48J5000	1	SNA
.2		BN81-08159Z	PART SET-ELEC W/I;UF**,UH**,UG**,ELEC	1	SNA
.2		BN81-12183D	A/S PART SET-MECH W/I;UJ5A,U48JA*	1	SNA
1		BN91-14806Z	ASSY SHIELD;JH5000,48"	1	SNA
.2	SCREW	6001-003016	SCREW-MACHINE;PWH,+,M3.0,L5.0,ZPC(WHT),S	8	SA
.2		BN02-00102B	TAPE-FILAMENT;#8917,0.15,25,50,WHITE	0	SNA
.2	EC13	BN39-01885T	LEAD CONNECTOR;UHD 6000,Lead Connector,U	1	SA
.2	P001A	BN44-00852A	DC VSS-LED TV PD BD;L48MSF_FDYL48MSF_FD	1	SA
.2	SP01A	BN96-30337C	ASSY SPEAKER P;6ohm,4pin,10W,mega3	1	SA
.2	FB05A	BN96-36076E	ASSY BOARD P;UA43J5000AWXHC_Function_Ass	1	SA
.2	FL06	BN96-36273P	ASSY CABLE P-FFC;UA48J5003,FFC,NH,450mm,	1	SA
1		BN91-15009B	ASSY LCM-BOE;CY-JJ048BGEV2V,BN95-02363B	1	SNA
.2		BN95-02363B	PRODUCT LCD-BOE;CY-JJ048BGEV2V/H,J5000,H	1	SA

## Exploded Views and Parts List

Level	Loc.	Part Code	Description & Specification	Qty.	SA/SNA
...3	SCREW	6001-003075	SCREW-MACHINE;BH,+,M3,L4,ZPC(WHT),SWRCH1	3	SA
...3		BN68-05722A	LABEL-STICKER;ALL MODEL,POLYPROPYLENE,0.	1	SNA
...3		BN90-07271A	ASSY MISC-BLU,;	1	SNA
...4		BN02-00102B	TAPE-FILAMENT;#8917,0.15,25,50,WHITE	1	SNA
...4		BN02-00152E	TAPE ETC-SHEET FIXING;Y13 SF-LED,PET,0.0	2	SNA
...4		BN61-12528A	FRAME-MOLD MIDDLE U;J5.2K 48" (BOE),TPV	1	SNA
...4		BN61-12529A	FRAME-MOLD MIDDLE LR;J5.2K 48" (BOE),TPV	2	SNA
...4		BN61-12530A	FRAME-MOLD MIDDLE D;J5.2K 48" (BOE),TPV	1	SNA
...4		BN61-12561A	LGP-DIFFUSER PLATE;48inch J5.2K,PS,1064.	1	SNA
...4		BN63-13563A	SHEET-COMPLEX;DMOP-4R (3 tilt),PET,0.32,	1	SNA
...4		BN63-13566A	SHEET-REFLECTOR;DJY-188,PET,0.188,1089.1	1	SNA
...4		BN96-37137B	ASSY CHASSIS BOTTOM P;48J5200 BOE	1	SNA
....5		0203-006897	TAPE-DOUBLE FACE;SI,T1.0,W10,L50,WHT	1	SNA
....5		BN02-00040B	TAPE DOUBLE FACE-DIFFUSER FIXING;NNB 32/	6	SNA
....5		BN02-00040C	TAPE DOUBLE FACE-D-PLATE;F-LED ALL,MKT50	2	SNA
....5		BN02-00102B	TAPE-FILAMENT;#8917,0.15,25,50,WHITE	0	SNA
....5		BN02-00134E	TAPE ETC-SHEET FIXING;SFLED 32/40/46/55/	7	SNA
....5		BN02-00352B	TAPE OPP;PET,T0.05,W30,L50M,BLK,ULNO.E16	0	SNA
....5	EC13	BN39-02096A	LEAD CONNECTOR;5003 48inch LEAD Connecto	1	SA
....5		BN61-08815A	HOLDER-SOURCE PCB;SLIM-FLED,ABS,BLK,HB	4	SNA
....6		0103-004609	RESIN ABS;HF-0680U,K21294,BK0007,1.5mm H	6	SNA
....5		BN61-11982A	HOLDER-WALL RIVET;Y15 F-LED,CR-SPCC,L15.	4	SNA
....5		BN61-12411B	SUPPORT-PLATE;J5200 43",PC,V2,CLEAR	12	SNA
....5		BN61-12418A	FRAME-MIDDLE MOLD CORNER;POM	4	SNA
....5		BN62-00739A	INSULATION-PD BOARD;J5200,PC,0.43,170,25	1	SNA
....5	M0131	BN63-00135A	GASKET;MCX15A,Conductive Fabric,2.5mm,12	2	SNA
....5		BN63-14684A	GASKET;ID-45BNKH-10-7-15-23-C,POLYESTER,	2	SNA
....5	CC02	BN64-03161C	CHASSIS-BOTTOM;J5.2K 48",EGI-SECC,0.5,TP	1	SNA
....6		BN01-00318A	STEEL;48J5200,EGI-SECC,1121,0.5mm,665mm,	2926	SNA
...4		BN96-37296A	ASSY LED BAR P;48 FHD_FCOM_LEFT_MODULE,F	4	SNA
...4		BN96-37297A	ASSY LED BAR P;48 FHD_FCOM_RIGHT_MODULE,	4	SNA
...3		BN96-30086B	ASSY OPEN CELL;HV480FH2-600,16.7M,48inch	1	SNA
...4		BN81-11101A	A/S-SOURCE PCB'A;SOURCE PCB'A LEFT,BN44-	1	SNA
...4		BN81-11102A	A/S-ASSY PCB-SOURCE RIGHT;ASSY PCB-SOURC	1	SNA
...4		BN81-12698A	A/S-POLARIZER-TFT;POLARIZER-TFT,38-10022	1	SNA
...4		BN81-12699A	A/S-IC DRIVER SOURCE;IC DRIVER SOURCE,47	1	SNA
...4		BN81-12700A	A/S-POLARIZER-C/F;POLARIZER-C/F,38-10022	1	SNA
...3	OC-TC	BN96-30720A	ASSY CABLE P-FFC;H5000,FFC,NH,54mm 1,68	2	SNA
...3	TCON	BN96-34103B	ASSY T CON P;44-9771073 / 9771089,48FHD	1	SA
...3	TC01A	BN96-39004A	ASSY CHASSIS TOP P;J5.2K 48,ABS+PC+MF15%	1	SA

Level	Loc.	Part Code	Description & Specification	Qty.	SA/SNA
...4		BN60-00667A	SPACER-GASKET;Y13 SF-LED,GASKET(FG200A),	2	SNA
...4		BN60-00715A	SPACER-TOP,CORNER;Y13 Slim F-LED,GASKET*	4	SNA
...4		BN60-01076A	SPACER-GASKET;Y14,CONDUCTIVE FABRIC,L16,	2	SNA
...4		BN60-01251A	SPACER-TOP(UD);J5500 BOE 48",PET,L1064,G	2	SNA
...4		BN60-01251B	SPACER-TOP(LR);J5500 BOE 48",PET,L590,GO	2	SNA
...4		BN63-07229L	SHEET-COVER;rose70",PET+SI,T0.052,W30mm,	2	SNA
...4		BN63-10886D	SHEET-COVER;U28D590,PET+SI,0.052,W35mm,1	1	SNA
...4	AC157	BN64-03308A	CHASSIS-TOP;J5.2K 48",PC+ABS+GF15%,Black	1	SNA
1	M0017	BN91-16921F	ASSY CHASSIS;J5*,M3	1	SNA
.2	M0014	BN94-09511F	ASSY PCB MAIN;J5*,EU	1	SA
..3		BN61-09059A	HOLDER-SIDE AV;UF6100,HIPS,BK0020,HB,EO/	1	SNA
...4		0103-004628	RESIN HIPS;HF-1690H,K2901,BK0020,1.5mm H	13	SNA
..3	FB01A	BN97-07120D	ASSY DRM-KEY;NT14L_DRM-KEY(CI+)	1	SNA
...4		BN46-00328B	KEY CODE-CERTIFI;CI+,TV,NT14, EU	1	SNA
..3		BN97-09263C	ASSY SMD;UJ5*,UJ5*	1	SNA
...4		0202-001899	SOLDER-CREAM;M705-GRN360-K2-VT,20-38um,S	5	SNA
...4	DS01A	0401-001056	DIODE-SWITCHING;MMBD4148SE,100V,200mA,SO	1	SA
...4	DS01A	0401-001116	DIODE-SWITCHING;BAV99DW,75V,215mA,SOT-36	2	SA
...4		0403-001552	DIODE-ZENER;DDZ16,15.69/16.51V,500mW,SOD	1	SA
...4		0403-001783	DIODE-ZENER;BZB84-C6V2,5.8/6.6V,300mW,SO	3	SNA
...4		0403-001784	DIODE-ZENER;NZH7V5C,7.29/7.67V,500mW,SOD	1	SNA
...4		0403-001785	DIODE-ZENER;NZH5V1B,4.94/5.2V,500mW,SOD-	1	SA
...4		0403-001797	DIODE-ZENER;NZH3V0B,2.85/3.15V,500mW,SOD	1	SNA
...4		0404-001404	DIODE-SCHOTTKY;BAT721C,40V,200mA,SOT-23,	2	SA
...4		0406-001200	DIODE-TVS;RCLAMP0504F,6/-/V,150W,SC-70	1	SA
...4		0406-001628	DIODE-TVS;AOZ8804ADI,6/-/V,150W,SLP2510	4	SA
...4		0501-000279	TR-SMALL SIGNAL;KSA1182-Y,PNP,150mW,SOT-	1	SA
...4		0501-000445	TR-SMALL SIGNAL;KTC3875S-Y,NPN,150mW,SOT	6	SC
...4		0505-002560	FET-SILICON;AO6415,P,-20V,-3.3A,0.15ohm,	3	SA
...4		0505-003397	FET-SILICON;2N7002K,N,60V,380mA,1.19ohm,	6	SA
...4		0801-002780	IC-CMOS LOGIC;74LVC1G17,SCHMITT-TRIGGER	2	SA
...4		0801-003330	IC-CMOS LOGIC;Octal buffer,DQFN,20P,4.5x	1	SA
...4		1001-001860	IC-ANALOG SWITCH;NX5L2750CGU,QFN,10P,1.4	1	SNA
...4		1103-001531	IC-EEPROM;S-24C256CI-J8T1U4,256Kbit,32Kx	1	SA
...4		1105-002527	IC-DDR3 SDRAM;K4B2G1646Q-BCK0,DDR3,2Gbit	1	SA
...4		1201-003671	IC-AUDIO AMP;NTP7414,MLF,48P,7x7mm,DUAL,	1	SA
...4		1203-004363	IC-VOL. DETECTOR;SOT-23,3Z30,2.9x1.6mm,P	1	SA
...4		1203-006017	IC-VOL. DETECTOR;RT9824GJ8,TSOT23,8P,2.9	1	SA
...4		1203-006130	IC-POSI.FIXED REG.;S-1172B25-U5T1G,SOT-8	1	SA
...4		1203-007694	IC-DC/DC CONVERTER;SN1106041DDAR,DDA,8Z3	2	SA

Exploded Views and Parts List

Level	Loc.	Part Code	Description & Specification	Qty.	SA/SNA
...4		1203-007984	IC-DC/DC CONVERTER;AOZ3015PI,SO-8,8P,6.2	1	SA
...4		1203-008103	IC-POSIFIXED REG.;S-13A1D15-E800,HSOP,8	1	SNA
...4		1203-008104	IC-POSIFIXED REG.;S-13A1D18-E800,HSOP,8	1	SNA
...4		1203-008105	IC-POSIFIXED REG.;S-13A1D33-E800,HSOP,8	1	SNA
...4		1204-003492	IC-DECODER;SENK14,LFBGA,624P,21x21mm,PLA	1	SA
...4		1205-004447	IC-SWITCH;TPS2051CDBVR,SOT23-5,5P,3x1.65	2	SA
...4		1405-001271	VARISTOR;35V,20Vdc,5A,1.0x0.5mm,TP,100V,	15	SA
...4		2007-000137	R-CHIP;2Kohm,5%,1/16W,TP,1005	5	SNA
...4		2007-000138	R-CHIP;100ohm,5%,1/16W,TP,1005	17	SA
...4		2007-000142	R-CHIP;2.7Kohm,5%,1/16W,TP,1005	2	SNA
...4		2007-000143	R-CHIP;4.7Kohm,5%,1/16W,TP,1005	40	SNA
...4		2007-000148	R-CHIP;10Kohm,5%,1/16W,TP,1005	31	SA
...4		2007-000153	R-CHIP;22Kohm,5%,1/16W,TP,1005	7	SNA
...4		2007-000157	R-CHIP;47Kohm,5%,1/16W,TP,1005	4	SNA
...4		2007-000162	R-CHIP;100Kohm,5%,1/16W,TP,1005	6	SNA
...4		2007-000168	R-CHIP;470Kohm,5%,1/16W,TP,1005	3	SNA
...4		2007-000171	R-CHIP;0ohm,5%,1/16W,TP,1005	5	SNA
...4		2007-000172	R-CHIP;10ohm,5%,1/16W,TP,1005	2	SNA
...4		2007-000173	R-CHIP;22ohm,5%,1/16W,TP,1005	10	SNA
...4		2007-000174	R-CHIP;47ohm,5%,1/16W,TP,1005	2	SNA
...4		2007-000256	R-CHIP;1.6Kohm,1%,1/10W,TP,1608	1	SA
...4		2007-000475	R-CHIP;1Mohm,1%,1/10W,TP,1608	1	SA
...4		2007-000691	R-CHIP;3.3Mohm,5%,1/10W,TP,1608	1	SA
...4		2007-000695	R-CHIP;3.3ohm,5%,1/10W,TP,1608	4	SNA
...4		2007-000775	R-CHIP;33Kohm,5%,1/16W,TP,1005	2	SNA
...4		2007-000931	R-CHIP;470ohm,5%,1/8W,TP,2012	1	SC
...4		2007-000932	R-CHIP;470ohm,5%,1/16W,TP,1005	5	SNA
...4		2007-001168	R-CHIP;75ohm,5%,1/4W,TP,3216	1	SA
...4		2007-001292	R-CHIP;33ohm,5%,1/16W,TP,1005	12	SNA
...4		2007-001298	R-CHIP;51ohm,5%,1/16W,TP,1005	2	SNA
...4		2007-001313	R-CHIP;330ohm,5%,1/16W,TP,1005	2	SNA
...4		2007-001325	R-CHIP;3.3Kohm,5%,1/16W,TP,1005	1	SNA
...4		2007-003025	R-CHIP;6.8ohm,5%,1/16W,TP,1005	2	SA
...4		2007-007095	R-CHIP;390ohm,5%,1/16W,TP,1005	1	SA
...4		2007-007107	R-CHIP;100Kohm,1%,1/16W,TP,1005	1	SNA
...4		2007-007108	R-CHIP;43.2Kohm,1%,1/16W,TP,1005	1	SA
...4		2007-007139	R-CHIP;47Kohm,1%,1/16W,TP,1005,0.35T	1	SA
...4		2007-007142	R-CHIP;10Kohm,1%,1/16W,TP,1005	2	SNA
...4		2007-007156	R-CHIP;1ohm,5%,1/16W,TP,1005	7	SNA
...4		2007-007306	R-CHIP;100ohm,1%,1/16W,TP,1005	4	SNA

Level	Loc.	Part Code	Description & Specification	Qty.	SA/SNA
...4		2007-007309	R-CHIP;12Kohm,1%,1/16W,TP,1005,0.35T	1	SA
...4		2007-007311	R-CHIP;22Kohm,1%,1/16W,TP,1005	1	SA
...4		2007-007317	R-CHIP;2.2Kohm,1%,1/16W,TP,1005	2	SA
...4		2007-007318	R-CHIP;1Kohm,1%,1/16W,TP,1005	17	SNA
...4		2007-007517	R-CHIP;240ohm,1%,1/16W,TP,1005	1	SNA
...4		2007-007538	R-CHIP;56Kohm,1%,1/16W,TP,1005	1	SA
...4		2007-008015	R-CHIP;75ohm,1%,1/16W,TP,1005	4	SNA
...4		2007-008275	R-CHIP;30Kohm,1%,1/16W,TP,1005	1	SNA
...4		2007-008332	R-CHIP;11.5Kohm,1%,1/16W,TP,1005	1	SA
...4		2007-009138	R-CHIP;33Kohm,1%,1/16W,TP,1005	2	SNA
...4		2011-001261	R-NETWORK;33ohm,5%,1/16W,L,CHIP,8P,TP,2.	2	SA
...4		2011-001262	R-NETWORK;22ohm,5%,1/16W,L,CHIP,8P,TP,2.	2	SA
...4		2011-001344	R-NETWORK;100ohm,5%,1/16W,L,CHIP,8P,TP,2	5	SA
...4		2011-001345	R-NETWORK;10Kohm,5%,1/16W,L,CHIP,8P,TP,2	4	SA
...4		2011-001396	R-NETWORK;4.7Kohm,5%,1/16W,L,CHIP,8P,TP,	5	SA
...4		2011-001449	R-NETWORK;22ohm,5%,1/16W,L,4Points,TP,10	1	SA
...4		2011-001527	R-NETWORK;4.7Kohm,5%,1/16W,L,CHIP,4P,TP,	1	SNA
...4	AD480	2203-000233	C-CER,CHIP;0.1nF,5%,50V,C0G,TP,1005	6	SA
...4	AD480	2203-000278	C-CER,CHIP;0.01nF,0.5pF,50V,C0G,TP,1005	1	SA
...4	AD480	2203-000359	C-CER,CHIP;0.15nF,5%,50V,C0G,TP,1005,0.5	4	SNA
...4	AD480	2203-000438	C-CER,CHIP;1nF,10%,50V,X7R,TP,1005	7	SA
...4	AD480	2203-000489	C-CER,CHIP;2.2nF,10%,50V,X7R,TP,1005	1	SA
...4	AD480	2203-000585	C-CER,CHIP;0.22nF,10%,50V,X7R,TP,1005	1	SA
...4	AD480	2203-000627	C-CER,CHIP;0.022nF,5%,50V,C0G,TP,1005	2	SNA
...4	AD480	2203-000714	C-CER,CHIP;3.3nF,10%,50V,X7R,TP,1005	6	SA
...4	AD480	2203-000812	C-CER,CHIP;0.033nF,5%,50V,C0G,TP,1005	1	SA
...4	AD480	2203-000940	C-CER,CHIP;0.47nF,10%,50V,X7R,TP,1005	4	SA
...4	AD480	2203-000995	C-CER,CHIP;0.047nF,5%,50V,C0G,TP,1005	3	SA
...4	AD480	2203-001412	C-CER,CHIP;0.03nF,5%,50V,NP0,TP,1005	5	SNA
...4	AD480	2203-002285	C-CER,CHIP;10nF,10%,50V,X7R,TP,1005	12	SNA
...4	AD480	2203-005054	C-CER,CHIP;0.0047nF,0.25pF,50V,NP0,TP,10	2	SA
...4	AD480	2203-005249	C-CER,CHIP;100nF,10%,50V,X7R,TP,1608	13	SNA
...4	AD480	2203-006048	C-CER,CHIP;100nF,10%,10V,X7R,TP,1005	86	SA
...4	AD480	2203-006126	C-CER,CHIP;47nF,10%,16V,X7R,TP,1005	8	SNA
...4	AD480	2203-006324	C-CER,CHIP;2200nF,10%,10V,X5R,TP,1608	5	SA
...4	AD480	2203-006348	C-CER,CHIP;1000nF,10%,25V,X5R,TP,1608,0.	4	SA
...4	AD480	2203-006361	C-CER,CHIP;10000nF,10%,10V,X5R,TP,2012	4	SC
...4	AD480	2203-006474	C-CER,CHIP;22000nF,20%,6.3V,X5R,TP,2012	14	SA
...4	AD480	2203-006562	C-CER,CHIP;1000nF,10%,10V,X5R,TP,1005	14	SNA
...4	AD480	2203-006636	C-CER,CHIP;220nF,10%,25V,X7R,TP,1608	2	SA

## Exploded Views and Parts List

Level	Loc.	Part Code	Description & Specification	Qty.	SA/SNA
...4	AD480	2203-006890	C-CER,CHIP;10000nF,20%,6.3V,X5R,TP,1608	30	SNA
...4	AD480	2203-007176	C-CER,CHIP;10000nF,10%,16V,X5R,TP,2012,1	6	SNA
...4	AD480	2203-007240	C-CER,CHIP;22000nF,20%,6.3V,X5R,TP,1608(	2	SA
...4	AD480	2203-007269	C-CER,CHIP;22000nF,20%,10V,X5R,TP,2012(2	4	SA
...4	AD480	2203-007270	C-CER,CHIP;10000nF,10%,10V,X5R,TP,1608,0	5	SNA
...4	AD480	2203-007306	C-CER,CHIP;10000nF,10%,25V,X5R,TP,2012,1	1	SNA
...4	AD480	2203-007544	C-CER,CHIP;100nF,10%,50V,X7R,TP,1005,0.5	2	SA
...4		2503-001051	C-NETWORK;100nFx4,20%,16V,2012	1	SA
...4		2703-000158	INDUCTOR-SMD;1uH,10%,2012,.40Ohm,50mA,45,	3	SA
...4		2703-000213	INDUCTOR-SMD;470nH,10%,1608,1.35Ohm,35mA	1	SA
...4		2703-003149	INDUCTOR-SMD;2.2uH,20%,5050,0.055Ohm,300	1	SA
...4		2703-003790	INDUCTOR-SMD;4.7uH,20%,8080,0.025ohm,450	1	SA
...4		2703-003930	INDUCTOR-SMD;4.7uH,20%,5050,0.072Ohm,245	4	SA
...4		2703-004145	INDUCTOR-SMD;2.2uH,20%,6.5 x 6.9mm,0.20o	1	SNA
...4		2801-003773	CRYSTAL-SMD;12MHz,30ppm,28-AAN,20pF,50oh	1	SA
...4		3301-002039	BEAD-SMD;26ohm,1608,TP	41	SA
...4		3701-001861	CONNECTOR-HDMI;19P,FEMALE,AU,0.5mm,BLK,S	2	SA
...4		3707-001106	CONNECTOR-OPTICAL;STRAIGHT W/L,SPDIF	1	SA
...4		3708-003073	CONNECTOR-FPC/FFC/PIC;51P,0.5mm,SMD,AU,N	1	SA
...4		3709-001712	CONNECTOR-CARD SLOT;68P,1.27mm,ANGLE,AU,	1	SA
...4	EH01	3711-008131	HEADER-BOARD TO CABLE;BOX,4P,1R,2.5mm,AN	1	SA
...4	EH01	3711-008521	HEADER-BOARD TO CABLE;BOX,8P,1R,2mm,ANGL	1	SA
...4	EH01	3711-008634	HEADER-BOARD TO CABLE;BOX,10P,2R,2mm,ANG	1	SA
...4		3722-003457	JACK-USB;4P/IC,NI,BLK,A	1	SA
...4	JACK PIN	3722-003546	JACK-PIN;5P+Screw hole,NI+SN,G,Y/BLU/RED	1	SA
...4		3722-003667	JACK-PHONE;1P/7C,SN/NI,BLK,STRAIGHT,3.6P	1	SA
...4	ET01	BN40-00282A	TUNER;DTOS40EIH276A,DTOS40EIH276A,DVB-TC	1	SA
...4		BN41-02098B	PCB MAIN;NT14L,FR-4,4,1.2,122*193.5,1	1	SNA
...4		BN97-09351A	ASSY MICOM-SUB;T-N14LJDEUS,UAD50	1	SNA
....5		1107-002226	IC-NOR FLASH;W25Q40CLSSIP,4Mbit,SOIC,8P,	1	SA
...4		BN97-10088A	ASSY MICOM;T-N14LJDEUC,UED51,1107-002252	1	SNA
....5		1107-002252	IC-NAND FLASH;1Gbit,128Mx8,TSOP,48P,12x2	1	SA
....5		BN46-00447E	S/W MANUAL;T-N14LJDEUC,NLDVBEU4J	1	SNA
....5		BN46-00456A	S/W MICOM;T-N14LJDEUC,2014.11.18	1	SNA
...3	T0066	BP62-00017A	HEAT SINK-ES;SP-50L2HX,A6063S,T2.0,26.2,	1	SNA
1	ACCE1	BN92-16870U	ASSY ACCESSORY;J5*,EU/CIS/N.AFR	1	SNA
.2		BN68-07519A	LABEL-ENERGY;EU,Jordan all(A+),WW,PP,0.1	1	SNA
.2		BN96-35734G	ASSY ACCESSORY CABLE;UJ5D	1	SNA
...3	T0268	3903-000849	CBF-POWER CORD;DT,CEE,LP-21L,250V,2.5A,B	1	SC
...3		4301-000121	BATTERY-MN;1.5V,R03,10.5x44.5m,7.5g,AAA	2	SNA



Level	Loc.	Part Code	Description & Specification	Qty.	SA/SNA
..3		6902-001965	BAG PE;LDPE,BIOBASED,T0.05,W200,L300,TRP	1	SNA
..3	REMO2	AA59-00741A	REMOCON;TM1240,44,3.0V,F5020/EU	1	SA
.2		BN96-37696D	ASSY ACCESSORY MANUAL;J5*,EU/CIS/N.AFR	1	SNA
..3		6902-001964	BAG PE;LDPE,BIOBASED,T0.03,W200,L300,TRP	1	SNA
..3	T0527	BN68-00513A	LABEL-E,PASS;ALL MODEL,YUPO(110G),BLACK,	1	SNA
..3		BN68-00514K	MANUAL FLYER-07,WARRANTY CARD;comm,Samsu	1	SNA
..3		BN68-04972E	LEAFLET-06,REGULATORY GUIDE;ALL,SAMSUNG,	1	SNA
..3		BN68-07425L	MANUAL USERS;UJ5000,ZF/XN,ENG/FRA/DEU/DU	1	SNA
..3		BN68-07598A	LEAFLET-FICHE;ALL,W/P	1	SNA
1		BN92-17098R	ASSY P/MATERIAL;UJ5000,48"	1	SNA
.2		6902-001956	BAG ROLL;HDPE/PE FOAM,HDPE T0.018mm,T0.2	3	SNA
.2		6902-002233	BAG AIR;LDPE,-,T0.2,W900,L1850,TRP,-,-,-	1	SNA
.2		6922-000003	BAND;PP,T0.8,W18,L1650M,TRP,DA69-90145A	0	SNA
.2		BN02-00319B	TAPE OPP;OPP,T0.05,W75,L800m,CLEAR	3	SNA
.2	AS080	BN63-07229A	SHEET-COVER;rose70",SI,T0.052,W50mm,100M	1	SNA
.2		BN68-02422B	LABEL-WARNING SHIPPING;ALL MODEL,A/P,T0.	1	SNA
.2		BN69-03982L	PAD PACKING-EDGE;EDGE,PAPER,-,T5,W100,L2	1	SNA
.2		BN69-05418N	WRAP;T0.017,750,2000000,2000000,750	0	SNA
.2		BN69-06640E	PAD-TRUCK PAD;TRUCK PAD,PAPER,-,DW-BC,41	1	SNA
.2		BN69-06641A	PAD;PAD,PAPER,-,CB-SW4,1130,1060,-,-,-	1	SNA
.2		BN69-11261A	CUSHION-FRONT;50"/55" Model,EPS,16.7g/l	1	SNA
.2		BN69-12286A	CUSHION SET;J5200 48INCH MINI-ARCH,EPS	1	SNA
..3		0103-005099	RESIN EPS;BASF303,Natural,Natural	459	SNA
.2		BN69-12476S	PALLET;UE48J5000,WOOD,-,1090,1255,141,-,	1	SNA
1		BN92-17302A	ASSY LABEL;J5000,UJ5D	1	SNA
.2		0203-001598	TAPE-FILAMENT;#8915,0.15,12,55000,CLR	0	SNA
.2		BN68-06708G	LABEL RATING;Monitor,WW,PP,T0.161,93,73,	1	SNA
.2		BN68-07652H	LEAFLET-QSG;UJ5000,MOJO*	1	SNA
1		BN92-18026X	ASSY BOX;JH5000,48"	1	SNA
.2		BH68-00662A	LABEL BOX-01;ALL MODEL,ART PAPER,60,110,	1	SNA
.2		BN69-12409K	BOX UNIT;48J5000-ARC,CB,A-01,DW1,W1246,D	1	SNA