



VACUUM CLEANER

SERVICE MANUAL

CAUTION

BEFORE SERVICING THE UNIT, READ THE "SAFETY PRECAUTIONS" IN THIS MANUAL.

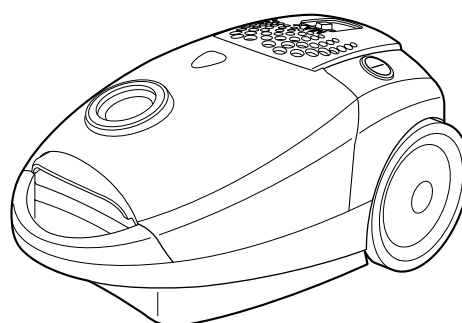

MODEL : V-CB584SEQ

V-CB584ST

V-CB574ST

V-CB564ST



CONTENTS

SAFETY PRECAUTIONS.....	3
DESCRIPTION	4
SPECIFICATIONS	4
DISASSEMBLY INSTRUCTIONS.....	5~6
TROUBLESHOOTING GUIDE	7~9
BLOCK DIAGRAM.....	10
SCHEMATIC DIAGRAM	10
CIRCUIT DIAGRAM	10
EXPLODED VIEW	11~14
REPLACEMENT PARTS LIST	15~16
APPENDIX	17~19
1. THE TYPE OF POWER PLUG AND PARTS NUMBER	17
2. COLOR & PARTS NUMBER	18
3. MOTOR & P.C.B ASSY & CORD REEL ASM PARTS NUMBER	19

SAFETY PRECAUTIONS

BEFORE OPERATING THIS VACUUM CLEANER, READ THIS SERVICE MANUAL THOROUGHLY, AND OBSERVE EACH POINT CAREFULLY.

1. Change the paper bag or clean the cloth bag in case the indicator moves toward red.

- 1) If the dust bag is full, intake power will be reduced.
- 2) When the dust bag is full of dust, pull out the dust bag from the inside of body base.

2. Filter

- 1) The filter is composed of a clean filter, an exhaust filter and a paper bag or a cloth bag.
- 2) Never use the vacuum cleaner without filters. It may harm to the motor.
- 3) When the cloth bag, the clean filter and the exhaust filter are soiled, wash the filter with neutral cleanser.

Note : Re-use of the cloth bag, clean filter and exhaust filter.

- Never wash the filter in a washing machine or in a dishwasher.
- Never use hot water for washing the filter.
- Re-use the filter after drying it completely in the shade.
- Do not dry near fire or direct sun ray.

3. Dust indicator

Dust indicator shows you red color when the filter is full of dust.

Then, change the paper bag with new one or clean the cloth bag.

4. Avoid suction such materials as:

- 1) Liquid or wet dust:
Clogging the ventilation holes, reduces the intake power significantly and harms the motor.
- 2) Inflammable liquids such as benzene, alcohol or solvents.
- 3) Burning objects such as cigarette butts.
- 4) Bulky objects such as vinyl, paper etc.
- 5) Sharp objects such as needles, pins, metal or glass particles etc.

5. Attachments

- Nozzle : For cleaning wooden floor, the room floor and carpet.
- Crevice Tool: for cleaning any crevice, inside corners of window frames.

However, do not use the crevice tool more than 20 minutes because it may cause harm to the motor.

6. Close supervision is necessary when this vacuum cleaner is used by or near children. Children's carelessness may cause damage to the cleaner or injure persons.

7. Air exhausted from the vacuum cleaner is normally warm. But if extraordinarily hot air is exhausted, check if the telescopic tube, hose or dust bag is clogged or not.

8. Electric shock could occur if used outdoors or on wet surfaces.

DESCRIPTION

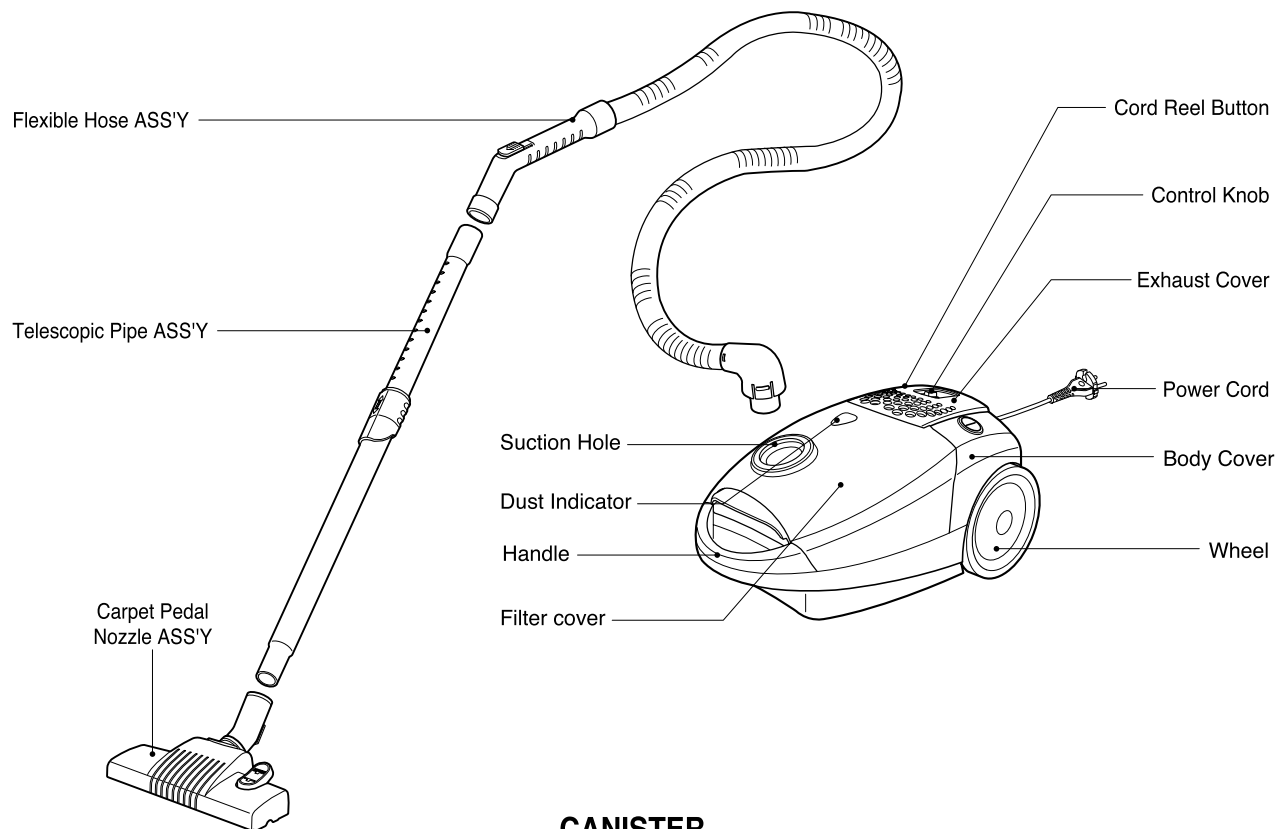

CANISTER

ATTACHMENTS

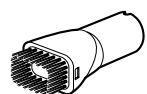

DUSTING BRUSH



CREVICE TOOL

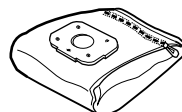

CLOTH BAG ASS'Y
(OPTION)

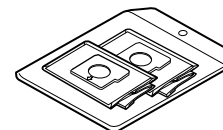

FILTER BAG ASS'Y
(OPTION)

SPECIFICATIONS

- **MODEL** : REFER TO THE COVER PAGE
- **POWER SOURCE** : ON RATING PLATE
- **POWER CONSUMPTION** : ON RATING PLATE
- **POWER CONTROL** :
 - **MAIN** : SLIDE ON BODY
(V-CB584SEQ/ST, V-CB574ST, V-CB564ST)
- **CAPACITY** : 4 ℓ
- **CORD LENGTH** : 6.3 m
- **HOSE LENGTH** : 1.5 m
- **NET WEIGHT** : 5 kg
- **PACKING WEIGHT** : 8.5 kg

- **NET DIMENSION** : 470 × 310 × 240 (L × W × H)mm
- **PACKING DIMENSION** : 575 × 330 × 330 (L × W × H)mm
(with telescopic pipe)
- **ATTACHMENTS**
 - HOSE 1EA
 - TELESCOPIC PIPE ASSY
(V-CB584SEQ/ST, V-CB574ST, V-CB564ST))..... 1EA
 - NOZZLE ASSY1EA
 - CREVICE TOOL..... 1EA
 - DUSTING BRUSH..... 1EA
 - CLOTH BAG ASY (OPTION)1EA
 - EXTRA PAPER BAG ASSY (PAPER, OPTION).....1EA

- This specifications are subject to change according to the buyer's request.

DISASSEMBLY INSTRUCTIONS

NOTE: Before attempting to service or adjust any part of the vacuum cleaner, disconnect the electrical power supply cord from the wall outlet.

- Almost all of the parts of this vacuum cleaner can be disassembled with a screw driver and each connecting component easily fits each other. Disassemble one by one referring to the exploded view.
- If possible, don't disassemble except for the necessary parts. It is not necessary to disassemble the parts that are not detailed in the exploded view.

1. Detach Body Cover Assembly from Body Base Assembly

- 1) Open filter cover by pushing cover latch.

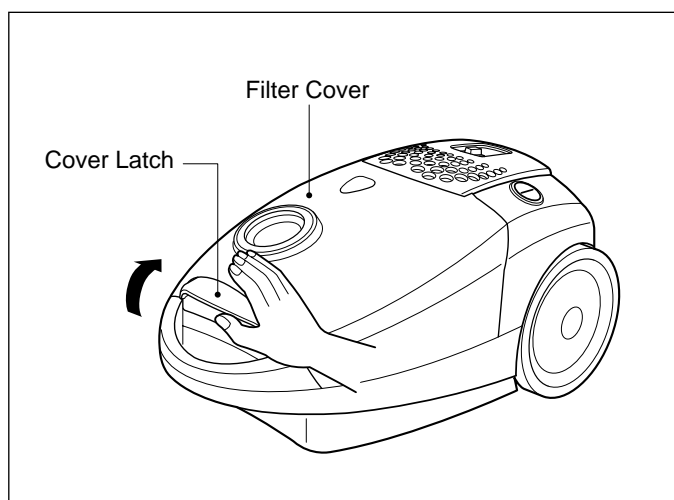

- 2) Remove exhaust filter cover & exhaust filter. Then remove four screws.

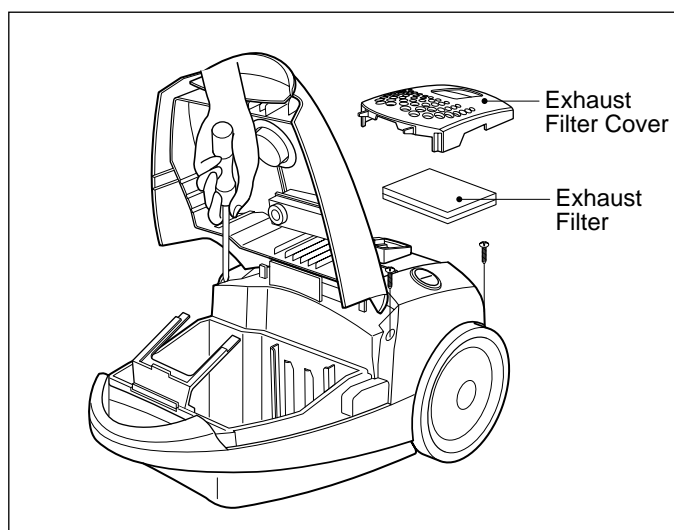

2. P.W.B Assembly Replacement

- 1) Remove control cover using the flat driver, push it in the direction of arrow.

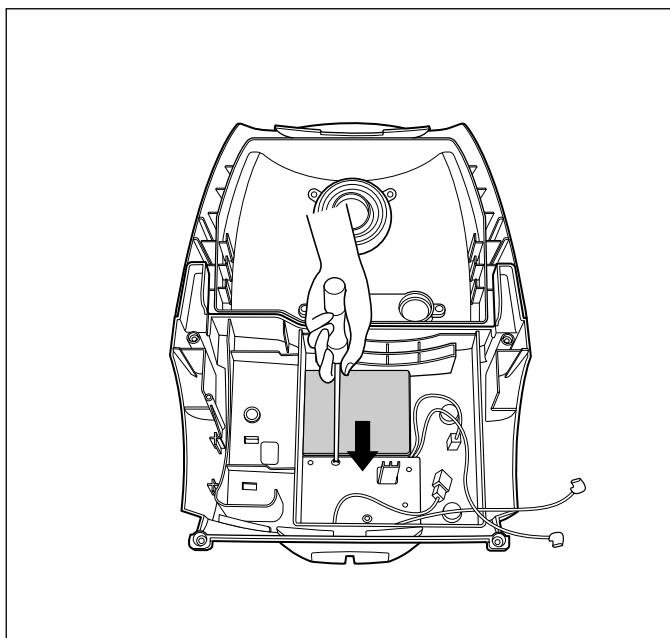

- 2) Detach P.W.B assembly after removing control cover, switch button, spring and knob.

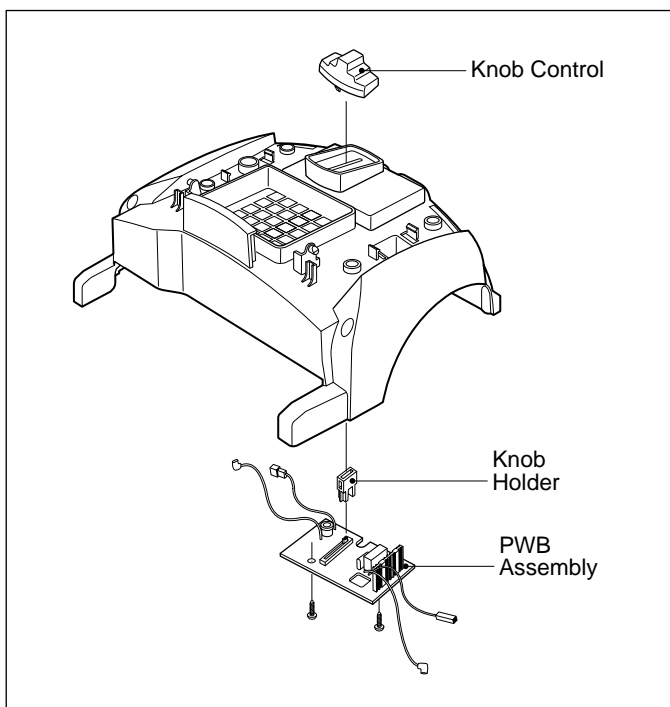

- 3) When you re-assembling the P.W.B assembly, assemble after sliding the lever of P.W.B assembly and switch knob to the Upward.

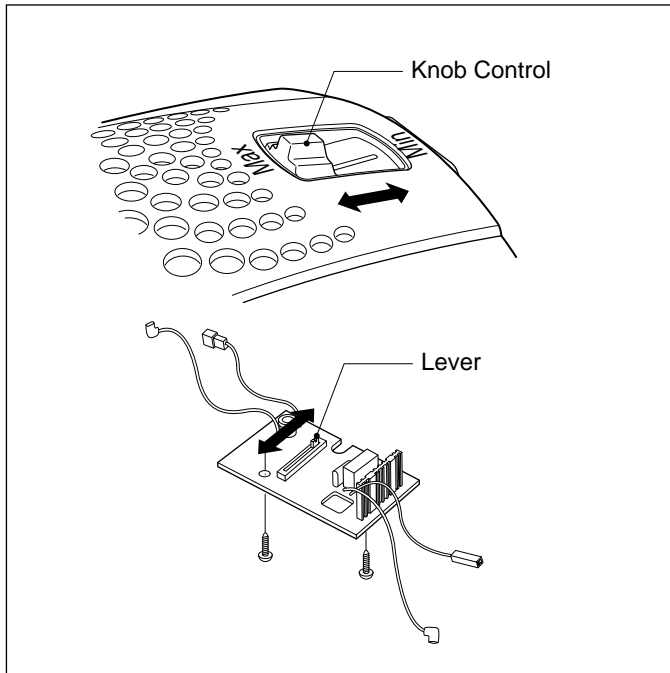

3. Filter Cover Assembly

- 1) Remove filter cover assembly by pushing filter cover in the direction of arrow.

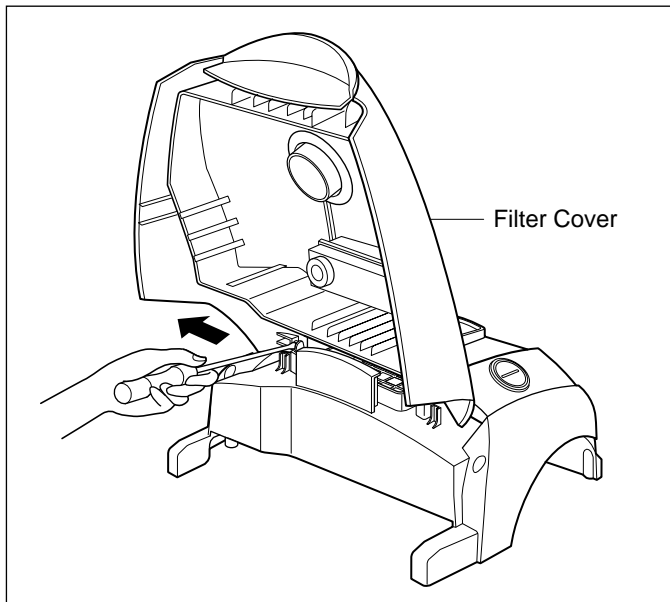

4. Motor Assembly Replacement.

- Lift the motor assembly in the direction of the arrow after stripping off the lead wires.

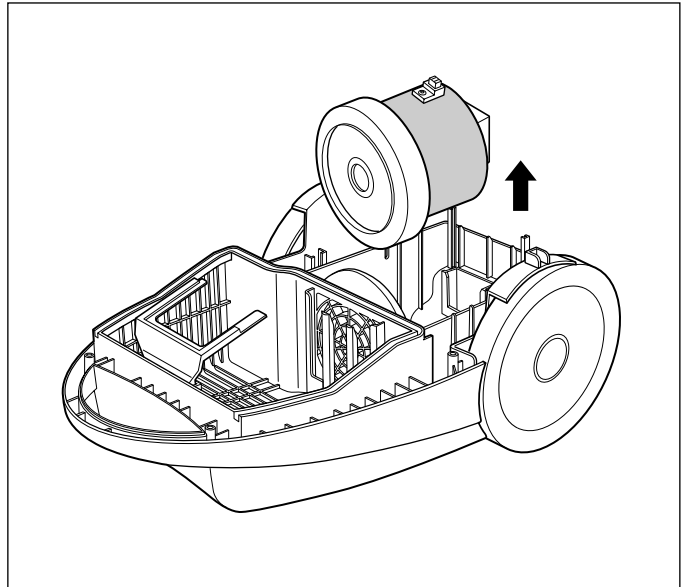

5. Cord Reel Assembly Replacement

- Lift the cord reel assembly from the body base in the direction of the arrow.

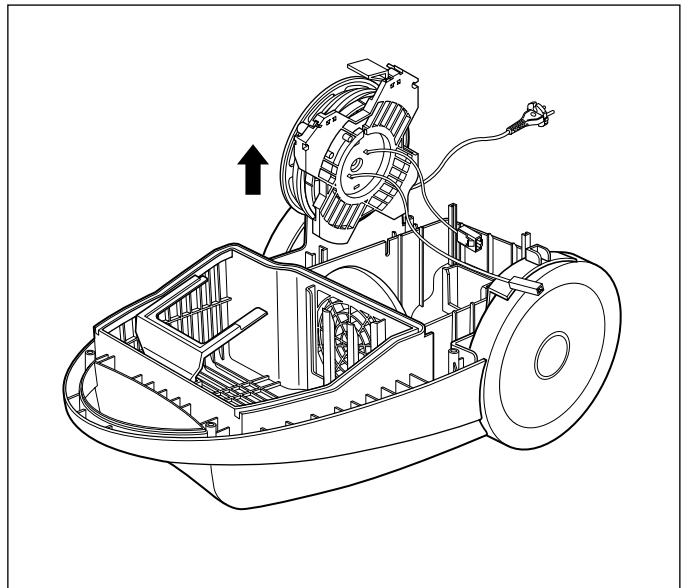

TROUBLE SHOOTING GUIDE

1. SWITCH ON BUT MOTOR DOES NOT RUN.

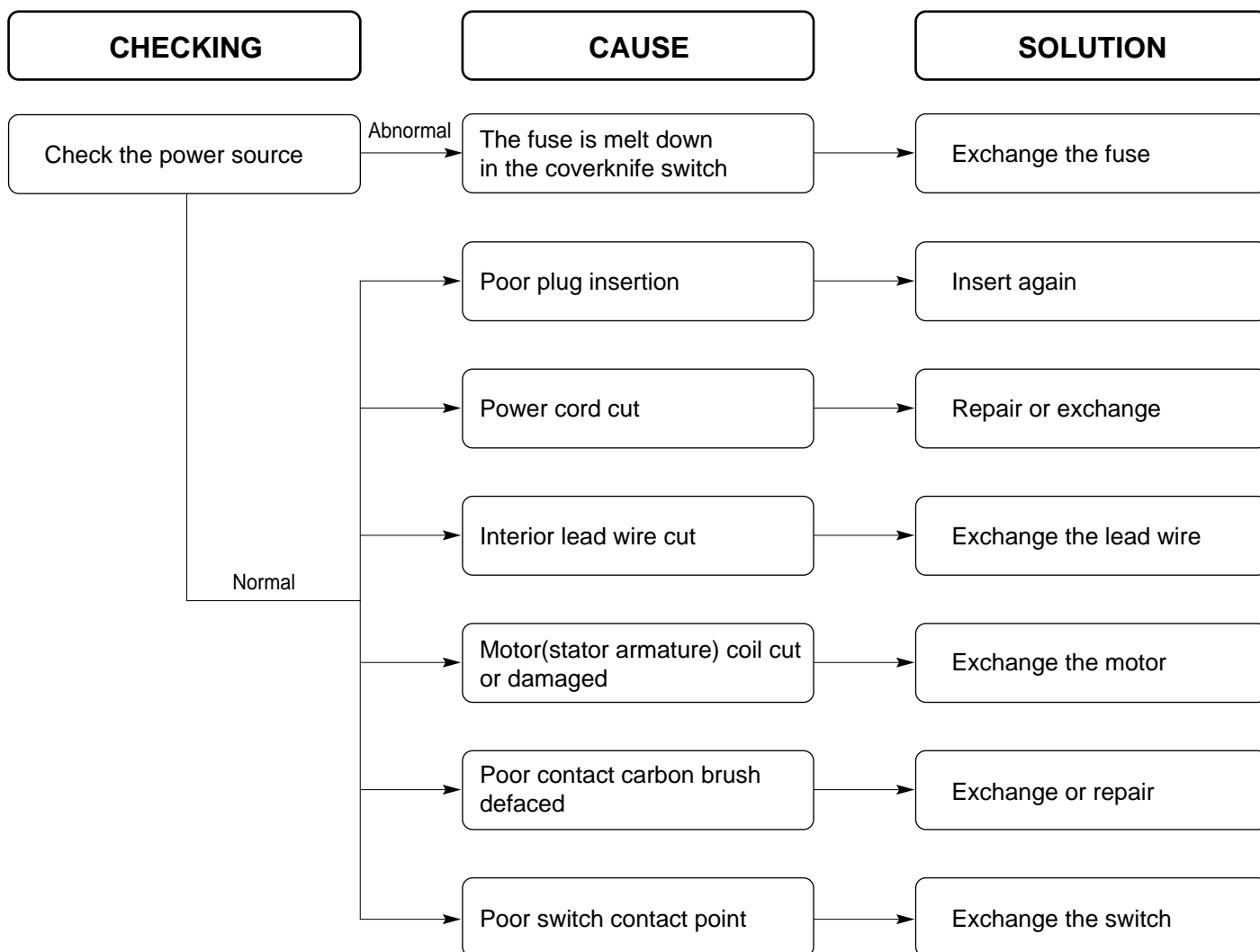

2. SWITCH ON, MOTOR DOES NOT RUN BUT BUZZES.

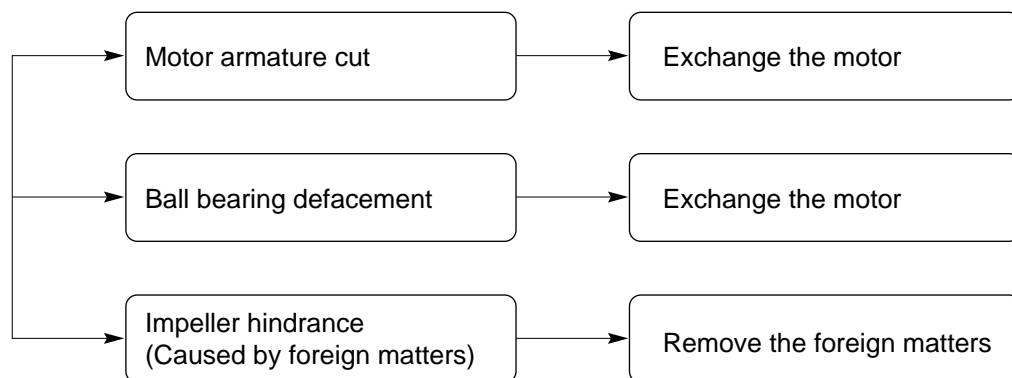

3. SWITCH OFF BUT MOTOR RUNS.

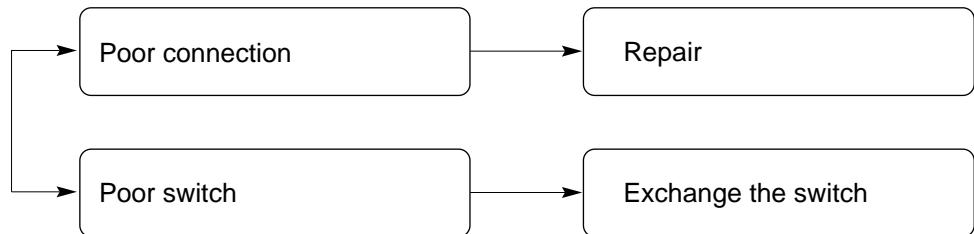

4. WEAK SUCTION POWER

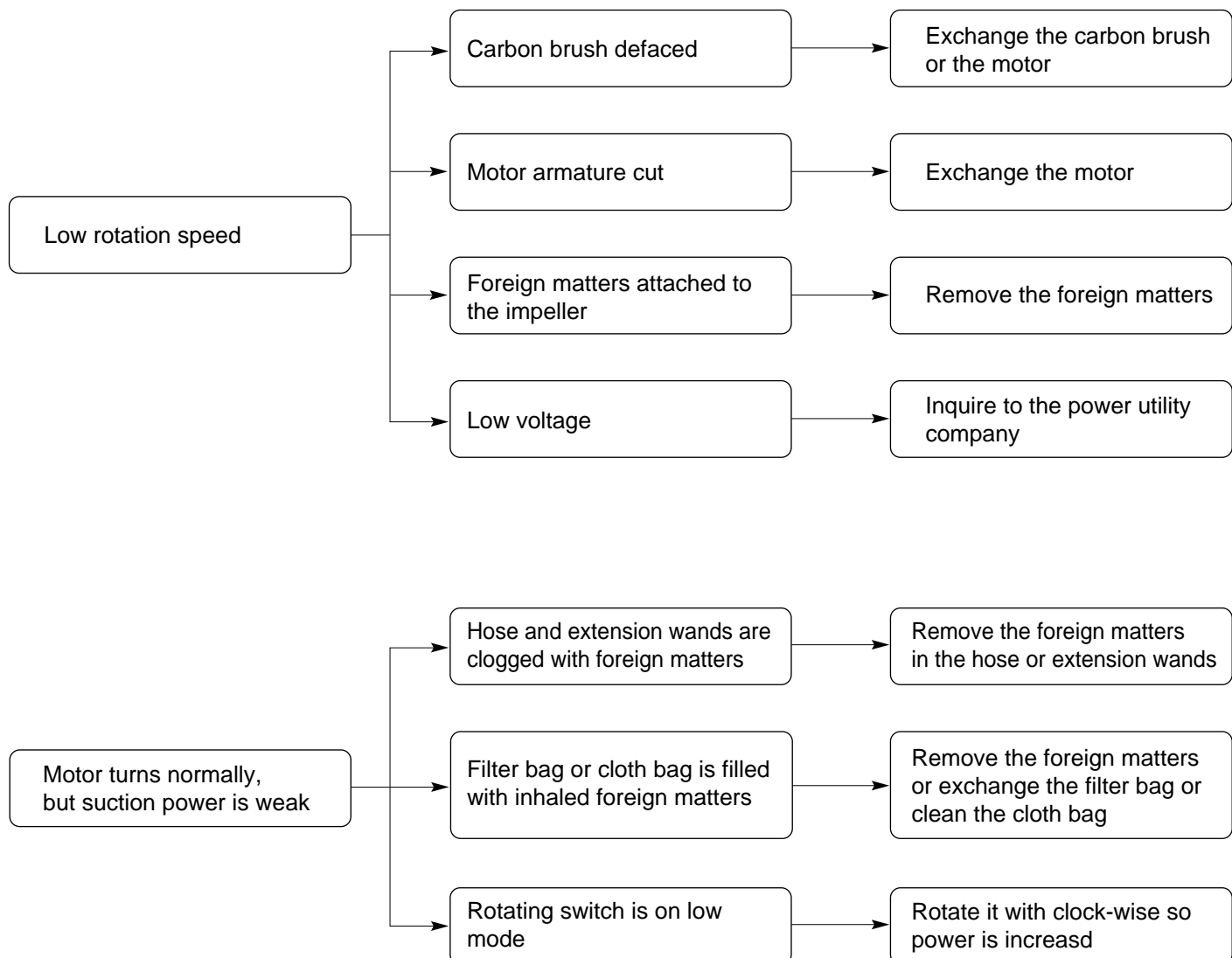

5. VIBRATION NOISES

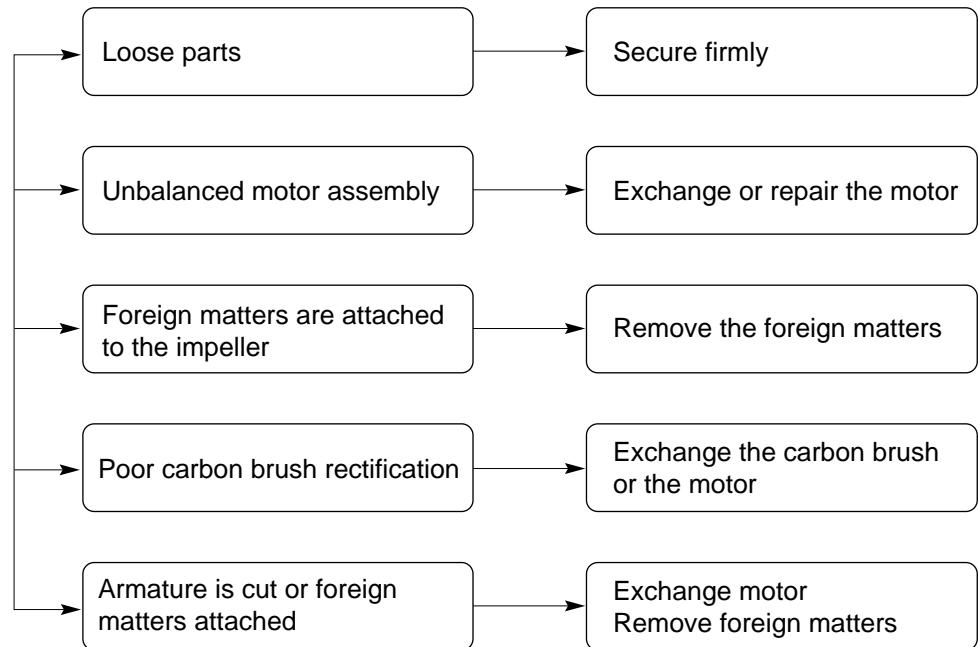

6. RADIO, TV RECEPTION DISTURBANCE

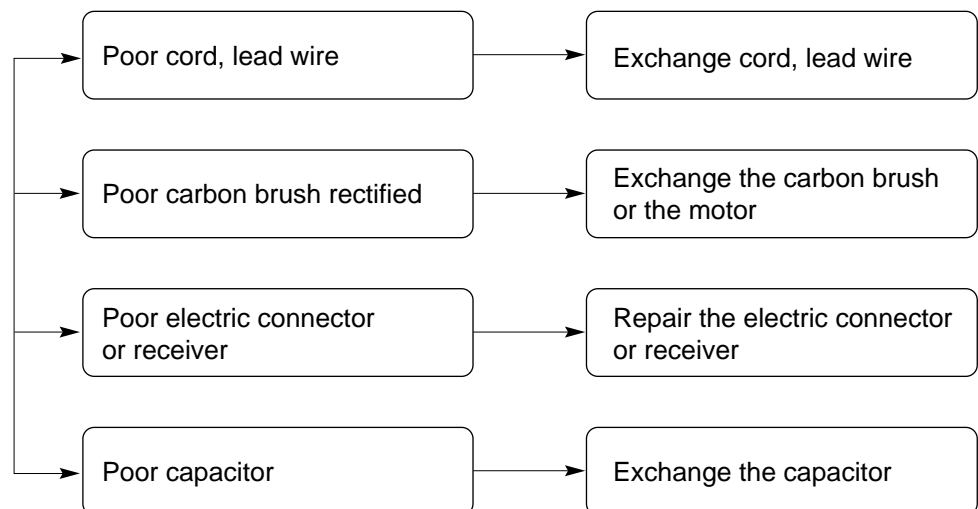

7. IMPROPER TUBE OR NOZZLE CONNECTION

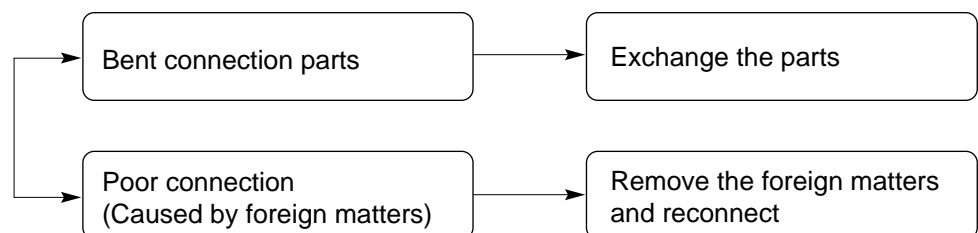

BLOCK DIAGRAM

V-CB564ST/V-CB574ST/V-CB584ST/SEQ

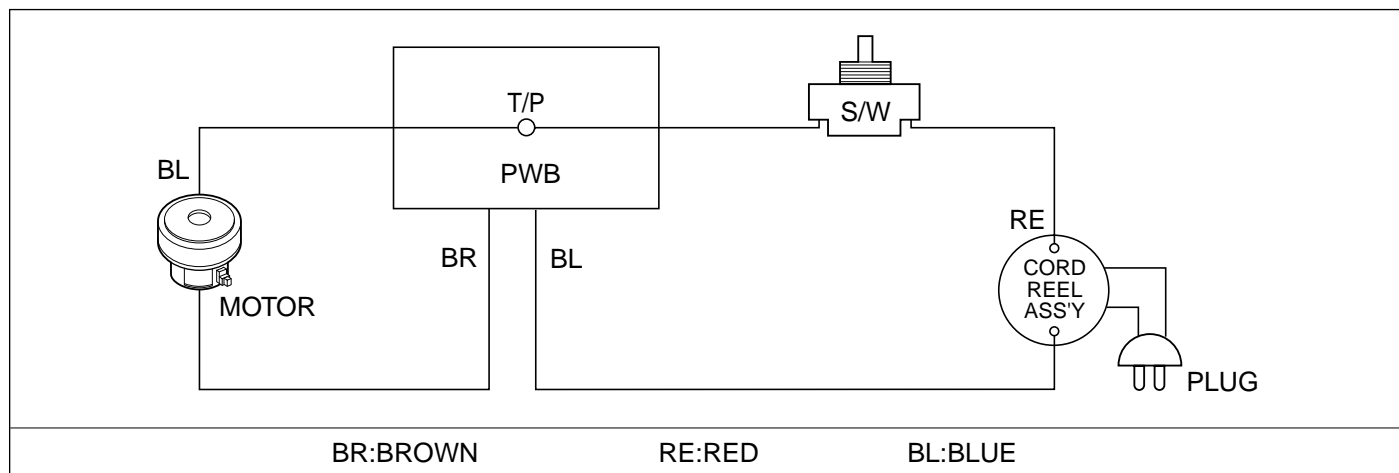

SCHEMATIC DIAGRAM

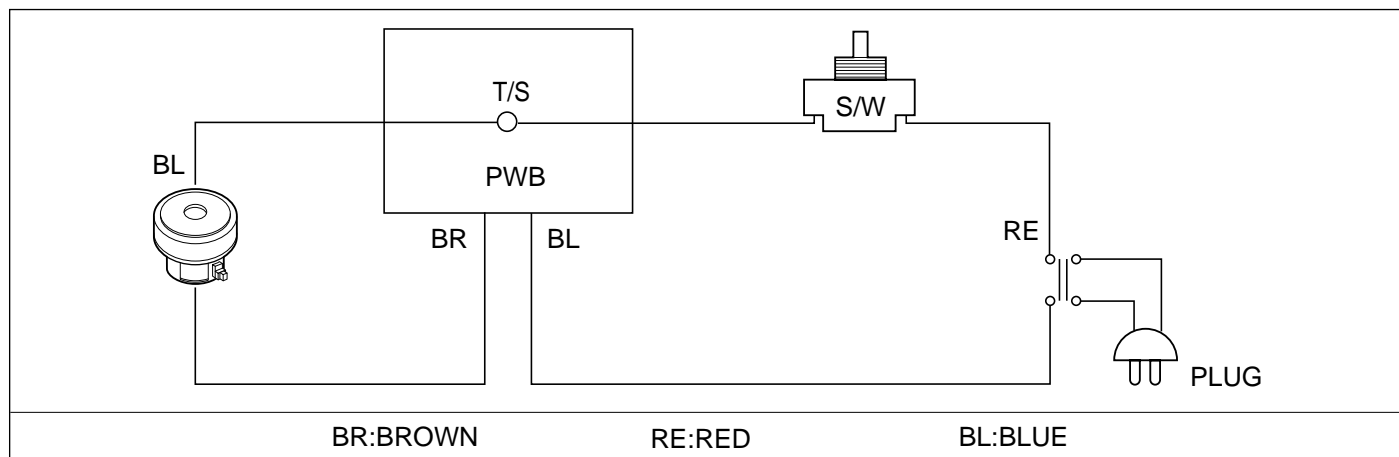

CIRCUIT DIAGRAM

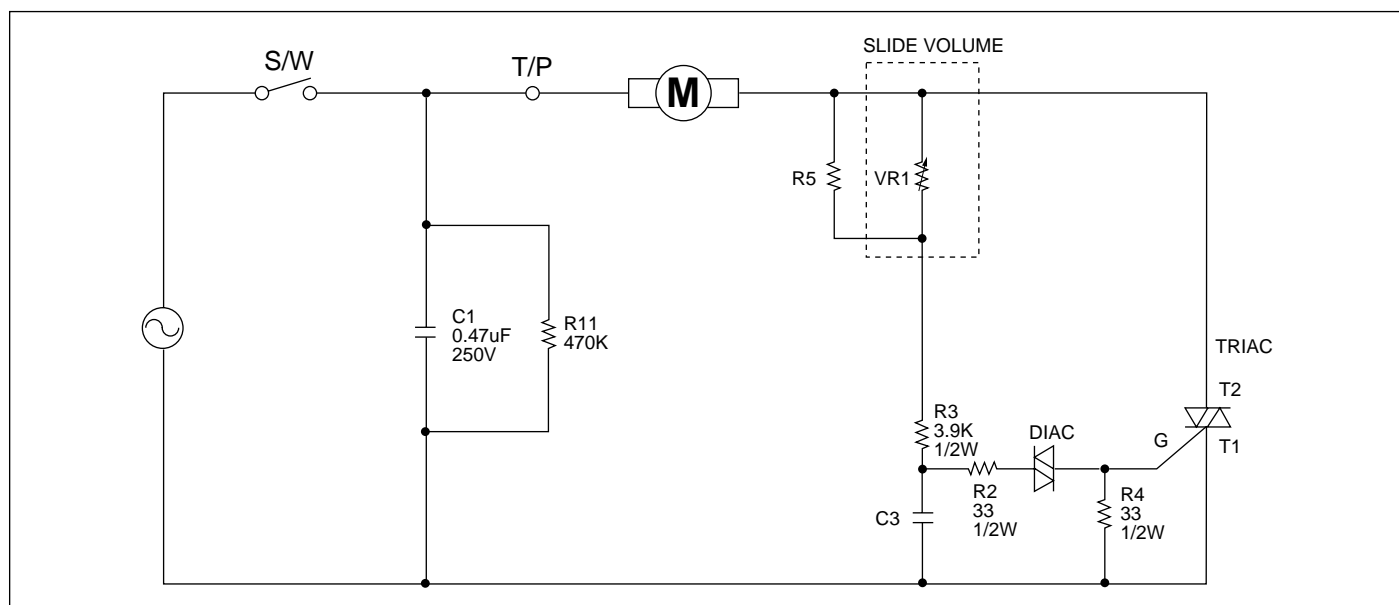

EXPLODED VIEW

BASE ASSEMBLY, BODY

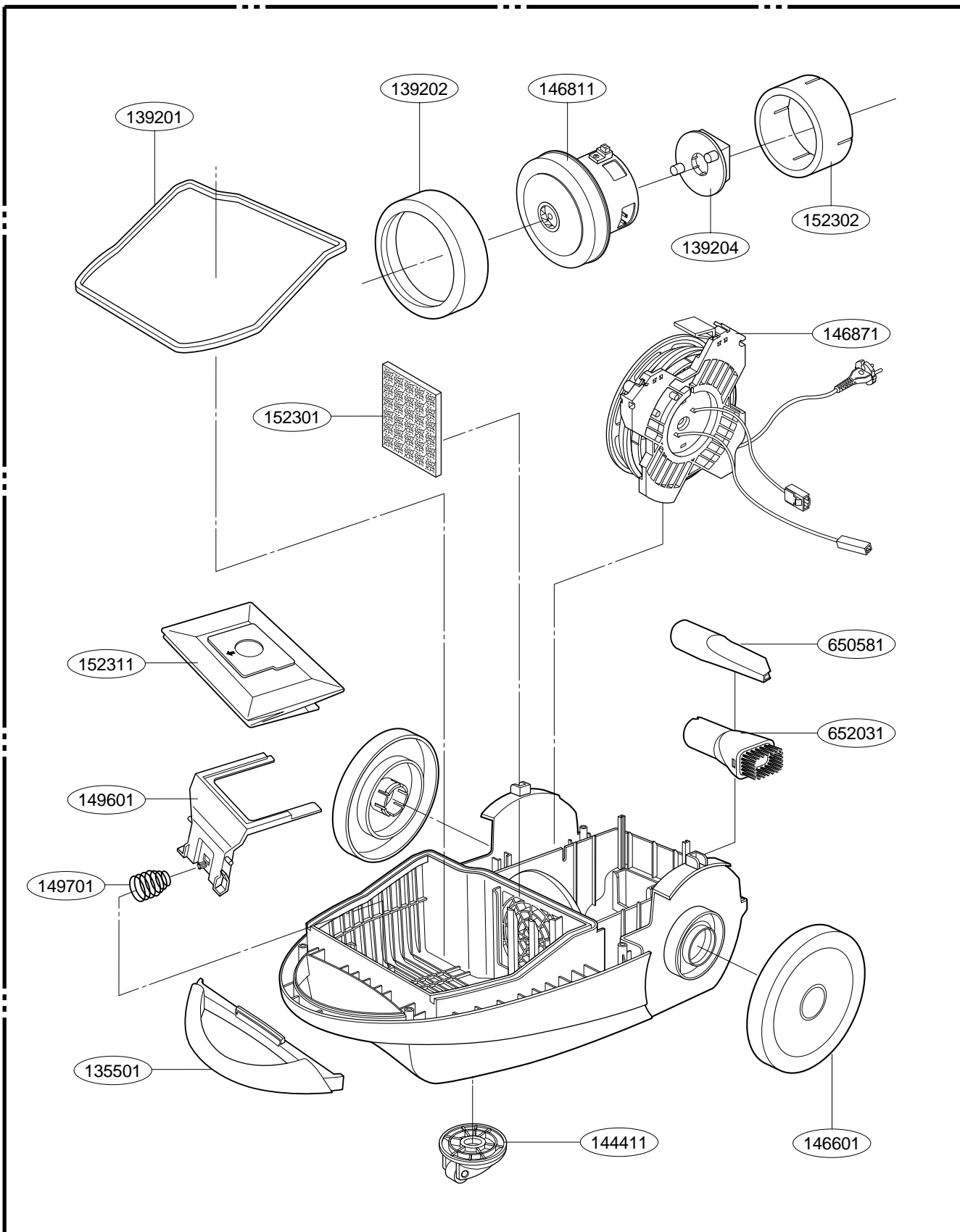

EXPLODED VIEW

COVER ASSEMBLY, BODY

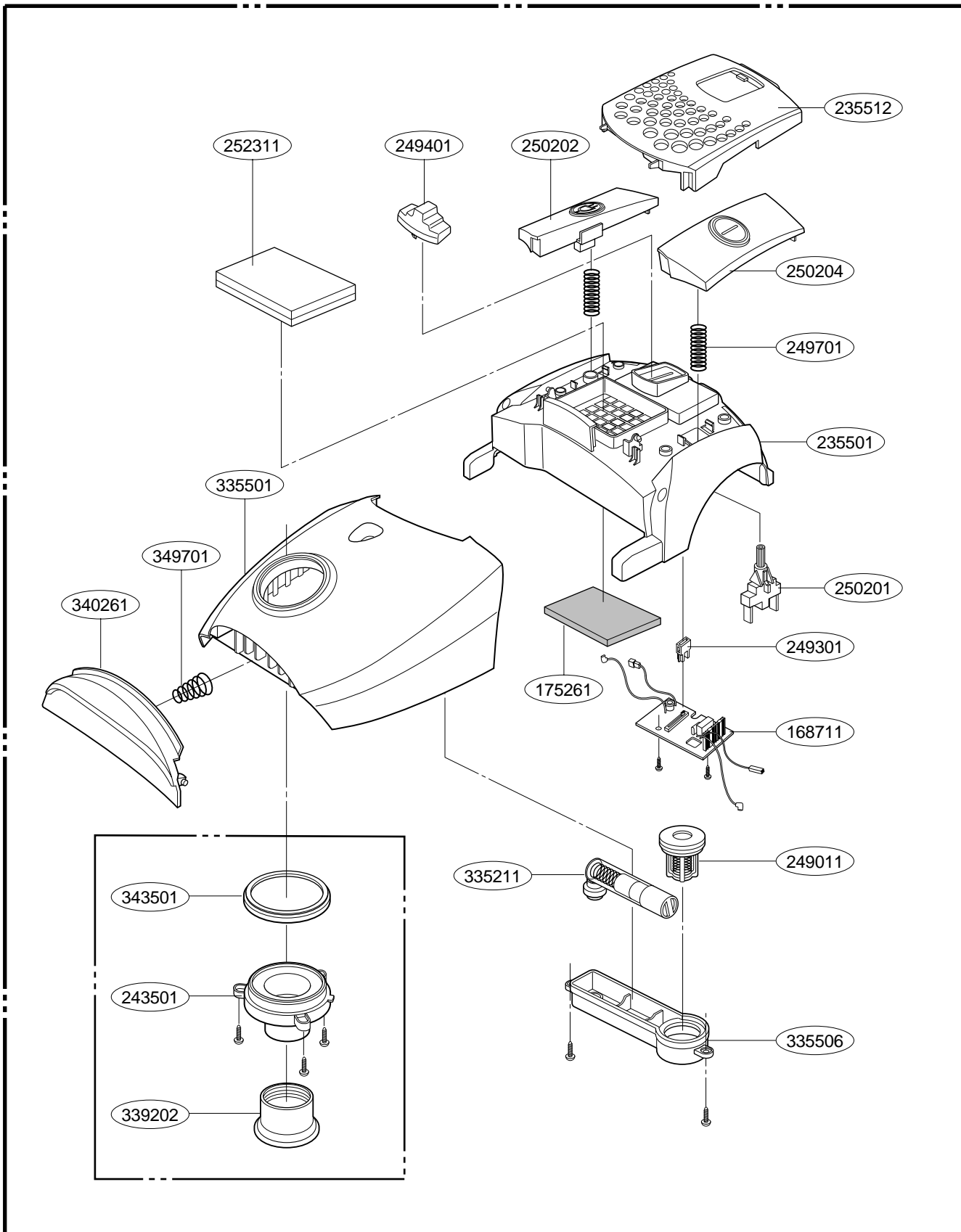

HOSE ASSEMBLY, FLEXIBLE

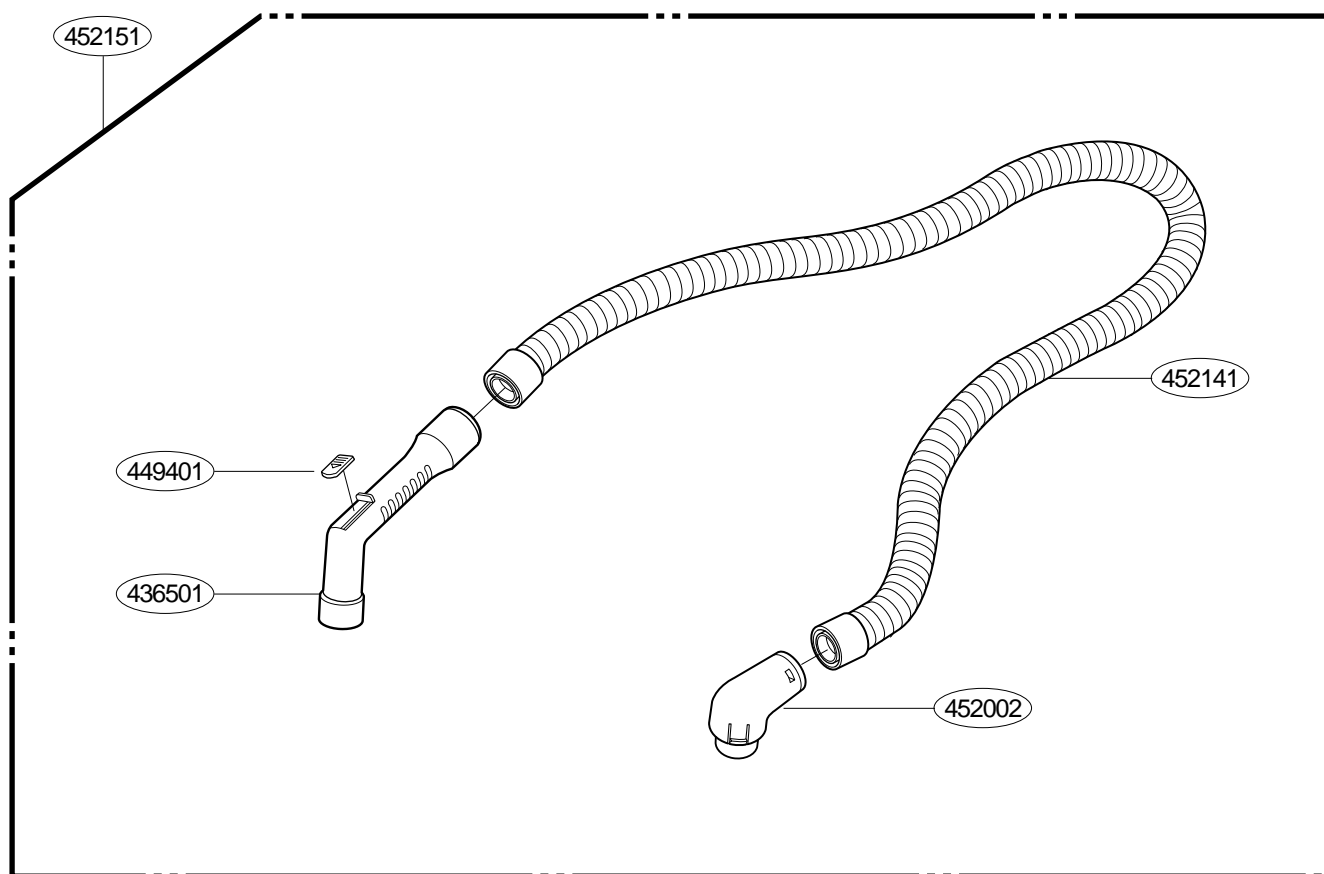

NOZZLE ASSEMBLY

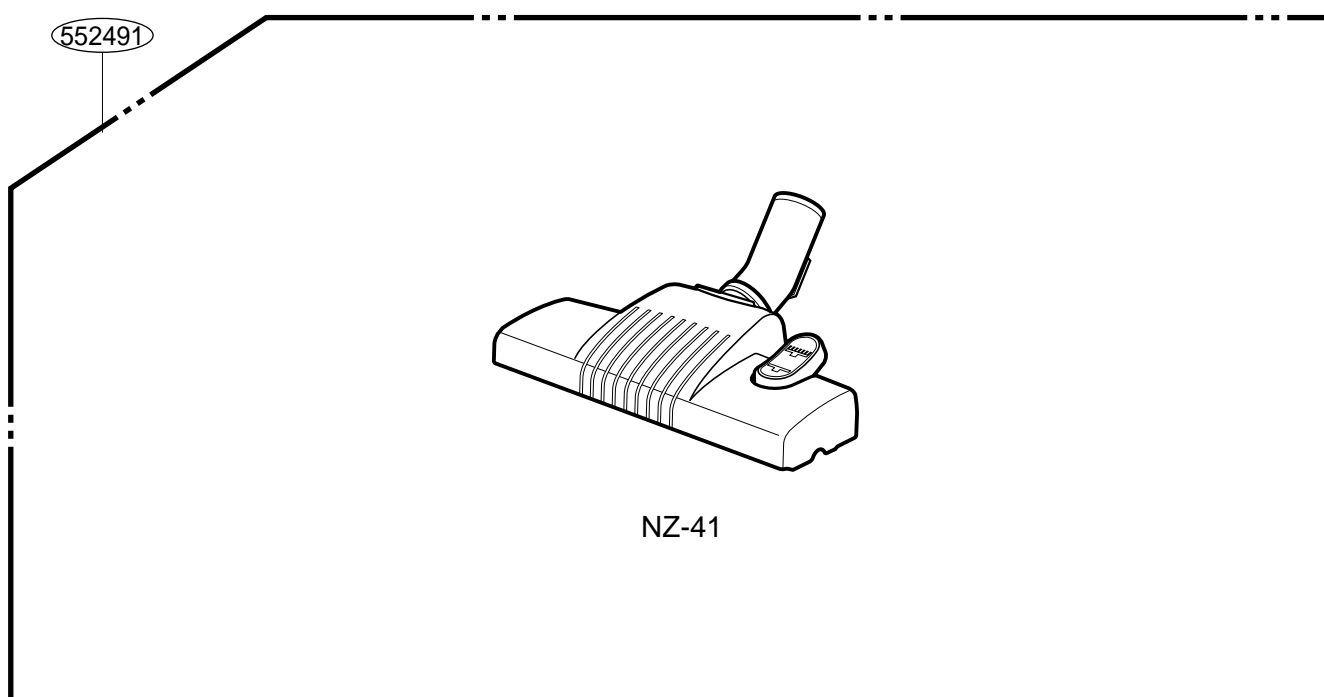

EXPLODED VIEW

ACCESSORIES

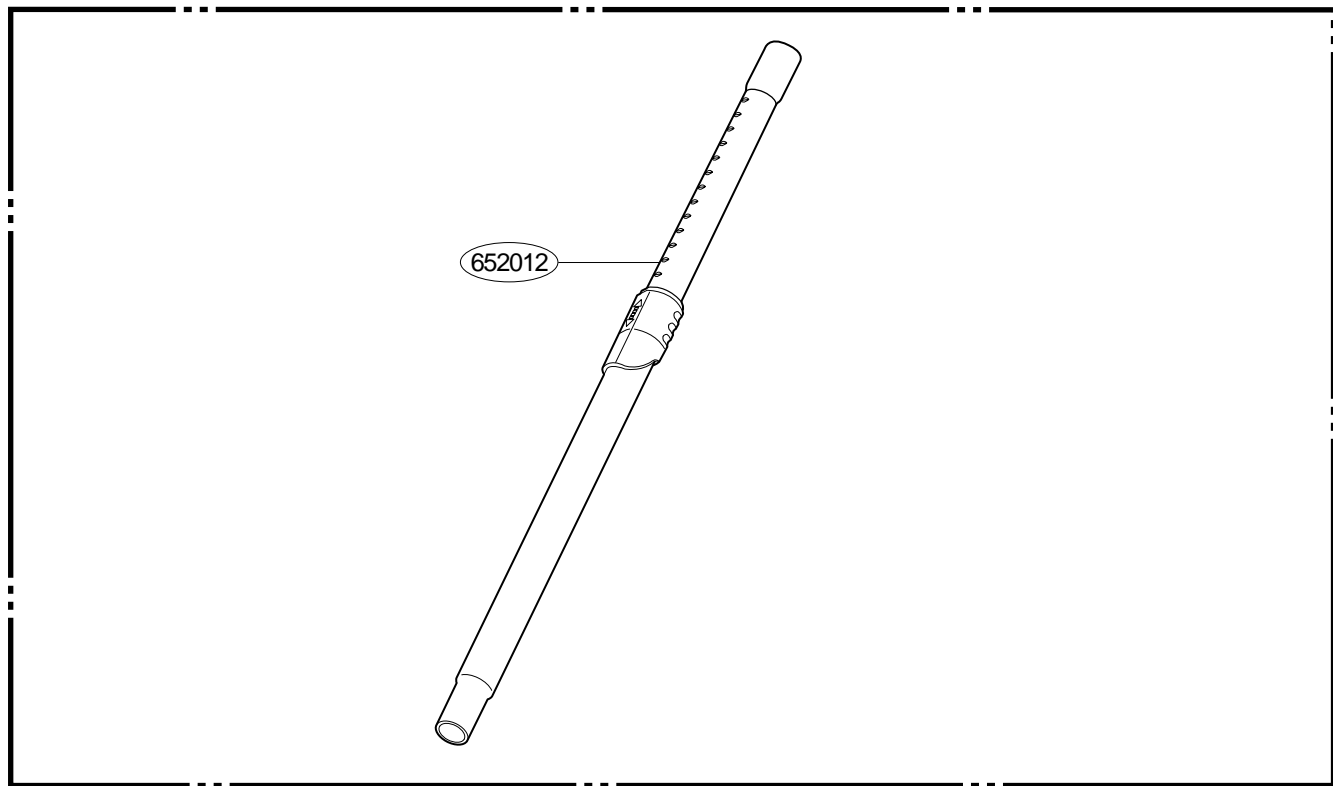

REPLACEMENT PARTS LIST

LOCATION No.	PART No.	DESCRIPTION	REMARK
139201	7526FI4203W	PACKING, DUST SEAL	NR
149601	4960FI1331A	MOUNT, BAG	ABS-HG173
130401	3040FI1529A	BASE, BODY	ABS-HG173
152301	4I70098M	FILTER(MECH) MOTOR SAFETY	POLYESTER
144411	4441FI3605X	CASTER ASSY	BLACK
146601	4660FI2427A	WHEEL	Refer To Appendix
152311	5231FI3512E	FILTER ASSY, PAPER	
650581	5058FI3462A	TOOL, CREVICE	BLACK
652031	3I20011E	BRUSH ASSY, DUST	BLACK
146871	4687FI1477T	CORD REEL ASSY	Refer To Appendix
146811	4681FI2456R	MOTOR ASSY, VC	Refer To Appendix
139202	3920FI3766A	PACKING, MOTOR MOUNT	NBR
152302	4I23008B	PACKING, ABSORBING	PU-FOAM
139204	3920FI3857A	PACKING, SEAL	NBR
235501	3550FI1770A	BODY COVER	Refer To Appendix
335501	3550FI1771A	FILTER COVER	Refer To Appendix
340261	4026FI3692A	LATCH	Refer To Appendix
135501	3550FI2590A	COVER, HANDLE	BLACK
249701	4970FI4511N	SPRING, COIL	HSWR
250202	5020FI2364	CONTROL BUTTON	Refer To Appendix
250204	5020FI2363	CORD REEL BUTTON	Refer To Appendix
249011	4901FI3436M	DAMPER ASSEMBLY	
335506	3550FI2550B	COVER INDICATOR	
149701	4970FI4230F	SPRING FILTER	HSWR
349701	4970FI4570E	SPRING LATCH	HSWR
175261	3940FI3748A (C)	SEALER	PU-FORM

REPLACEMENT PARTS LIST

LOCATION No.	PART No.	DESCRIPTION	REMARK
235512	3551FI1632A	COVER ASSEMBLE, EXHAUST	SILVER GRAY 사출후 SILVER SPRAY (삼성화학2920) Refer to Appendix
252311	5231FI3772F	EXHAUST FILTER	MICRO FILTER
335211	3521FI3700F	INDICATOR ASSEMBLY	
168711	6871FX2206A	PWB ASSEMBLY	Refer to Appendix
250201	6601FI3149C	BUTTON POWER SWITCH	BLACK
249401	4940FI3746A	KNOB CONTROL	BLACK
249301	4930FI3788A	HOLDER KNOB	
343501	4350FI3777K	RING GUIDE	Refer to Appendix
243501	4380FI3783A	RING, CONNECTOR	Refer to Appendix
339202	3920FI3822A	PACKING, TERMINAL	BLACK
452151	5215FI1306V	HOSE ASSY, FLEXIBLE	Refer to Appendix
436501	3650FI2275A	HANDLE, GRIP	V-CB584SEQ/ST V-CB574ST V-CB564ST
449401	4940FI4292B	KNOB, SLIDE	
452002	5200FI2269A	PIPE CONNECTOR	
452141	5214FI2326B	HOSE, FLEXIBLE	
652012	5201FI2438A	PIPE ASSEMBLY, TELESCOPIC	
552491	5249FI1421B	NOZZLE ASSY, FLOOR	

APPENDIX

1. THE TYPE OF POWER CORD & PARTS NUMBER

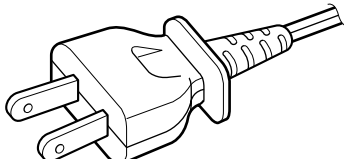
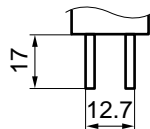
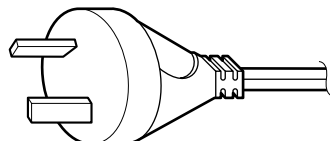
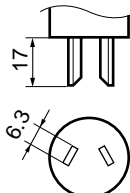
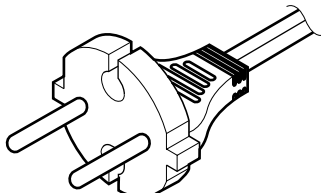
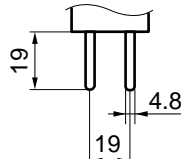
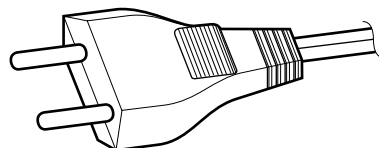
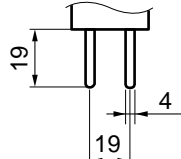
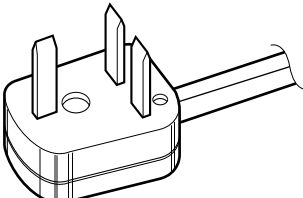
TYPE	TYPE OF PLUG	CORD REEL ASS'Y P/NO (L/NO.:146871)									
A-1	 										
S-1	 										
C-2	 										
C-1	 										
B-3	 <table data-bbox="707 1580 970 1762"><tr><th colspan="2">Color identification of fuse</th></tr><tr><td>Brown</td><td>13A</td></tr><tr><td>Yellow</td><td>5A</td></tr><tr><td>Blue</td><td>3A</td></tr></table>	Color identification of fuse		Brown	13A	Yellow	5A	Blue	3A		
Color identification of fuse											
Brown	13A										
Yellow	5A										
Blue	3A										

2. COLOR & PARTS NUMBER

LOCATION NO.	DESCRIPTION	COLOR	PETER RED	BLACK	SILVER	CHRRY RED	
235501	COVER, BODY			3550FI1770A			
335501	COVER, FILTER		3550FI1771A				
340261	LATCH, COVER		4026FI3692A				
343501	RING, GUIDE			4350FI3777K			
243501	RING, CONNECTOR			4380FI3783A			
235503	EXHAUST FILTER COVER				3550FI1772A		
250204	BUTTON, CONTROL		5020FI2364D	5020FI2364A			
250203	BUTTON, CORDREEL			5020FI2363A		5020FI2363D	
146601	WHEEL			4660FI2427A			
452151	FLEXIBLE HOSE ASM			5215FI1306R			

3. MOTOR & P.C.B ASSY & CORD REEL ASM PARTS NUMBER

L/NO.	P/NO	DESCRIPTION	REMARK
146811	4681FI2456R	MOTOR ASSY, VC	VMC260E02T, 220/230V, 50Hz

146871	4687FI1477T	CORD REEL ASSY	C-2, 6.3m

168711	6871FX2260A	PWB(PCB) ASSY	230V / 50Hz, VMC260E02T (Body slide)



P/No. : 3828Fi5890A

November. 2003

